

Technical Information

Cerabar PMP43

Process pressure measurement
IO-Link



Compact digital transmitter with metallic process membrane

Application areas

- Reliable, repeatable and stable pressure measurement and hydrostatic level measurement
- Pressure measuring range: up to 100 bar (1 500 psi)
- Process temperature: up to 200 °C (392 °F)
- Accuracy: up to $\pm 0.075\%$

Benefits

- Perfect cleanability thanks to fully welded design
- Easy guided commissioning with intuitive user interface
- Colored display with backlight and touch operation
- Heartbeat Technology for predictive and preventive maintenance
- Bluetooth® wireless technology for commissioning, operation and maintenance
- CIP and SIP capability - Degree of protection: IP66/68/69

Table of contents

About this document	4	Electromagnetic compatibility (EMC)	16
Symbols	4	Process	17
List of abbreviations	4	Process temperature	17
Turn down calculation	5	Process pressure range	17
Graphic conventions	6	Cleaned of oil and grease	17
Function and system design	6	Mechanical construction	18
Measuring principle	6	Design, dimensions	18
Measuring system	6	Dimensions	19
Communication and data processing	6	Weight	37
Reliability	7	Materials	37
Device-specific IT security	7	Surface roughness	37
Input	7	User interface	37
Measured variable	7	Languages	37
Measuring range	7	LED indicator	38
Output	9	Onsite display	38
Output signal	9	Remote operation	39
Switching capacity	9	System integration	39
Signal on alarm for devices with current output	9	Supported operating tools	40
Load	9	Certificates and approvals	40
Damping	9	Material compliance for contact with food	40
Protocol-specific data	10	General material compliance	40
Energy supply	10	Hygienic design compliance	40
Terminal assignment	10	cGMP	40
Available device plugs	10	TSE (BSE) compliance (ADI free - Animal Derived Ingredients)	40
Supply voltage	10	ASME BPE	40
Power consumption	11	Drinking water certification	41
Potential equalization	11	CRN approval	41
Overvoltage protection	11	ASME B31.3/31.1	41
Performance characteristics	11	Test, certificate, declaration	41
Reference operating conditions	11	Pressure Equipment Directive (PED)	41
Resolution	11	Order information	41
Total performance	11	Identification	42
Measurement uncertainty for small absolute pressure measuring ranges	13	Service	42
Total error	13	Application packages	42
Long-term stability	13	Heartbeat Technology	42
Response time	13	Accessories	43
Warm-up time	14	Device-specific accessories	43
Installation	14	DeviceCare SFE100	44
Mounting position	14	FieldCare SFE500	44
Installation instructions	14	Device Viewer	44
Environment	14	Field Xpert SMT70	44
Ambient temperature range	14	Field Xpert SMT77	44
Storage temperature	16	SmartBlue app	44
Operating height	16	Documentation	44
Climate class	16	Standard documentation	44
Degree of protection	16	Supplementary device-dependent documentation	44
Pollution degree	16		
Vibration resistance	16		
Shock resistance	16		

Registered trademarks 45

About this document

Symbols

Safety symbols



This symbol alerts you to a dangerous situation. Failure to avoid this situation will result in serious or fatal injury.



This symbol alerts you to a potentially dangerous situation. Failure to avoid this situation can result in serious or fatal injury.



This symbol alerts you to a potentially dangerous situation. Failure to avoid this situation can result in minor or medium injury.



This symbol alerts you to a potentially harmful situation. Failure to avoid this situation can result in damage to the product or something in its vicinity.

Communication-specific symbols

Bluetooth®: 

Wireless data transmission between devices over a short distance.

IO-Link:  **IO-Link**

Communications system for connecting intelligent sensors and actuators to an automation system. In the IEC 61131-9 standard, IO-Link is standardized under the description "Single-drop digital communication interface for small sensors and actuators (SDCI)".

Symbols for certain types of information

Permitted: 

Procedures, processes or actions that are permitted.

Forbidden: 

Procedures, processes or actions that are forbidden.

Additional information: 

Reference to documentation: 

Reference to page: 

Series of steps: [1.](#), [2.](#), [3.](#)

Result of an individual step: 

Symbols in graphics

Item numbers: 1, 2, 3 ...

Series of steps: [1.](#), [2.](#), [3.](#)

Views: A, B, C, ...

List of abbreviations

PN

Nominal pressure

Operating tool

The term "operating tool" is used in place of the following operating software:

- FieldCare / DeviceCare, for operation via IO-Link communication and PC
- SmartBlue app, for operation using an Android or iOS smartphone or tablet

PLC

Programmable logic controller (PLC)

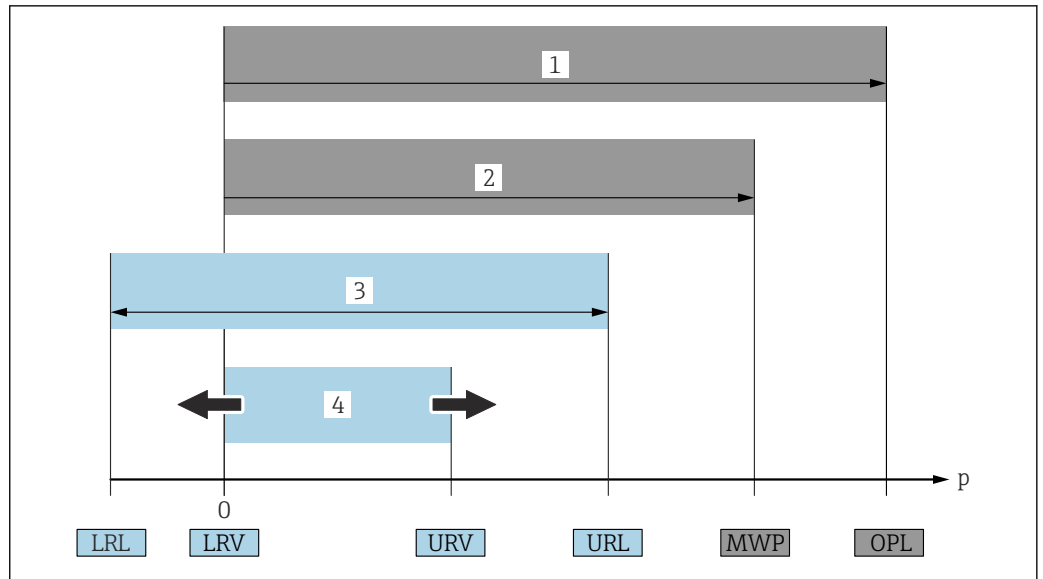

A0029505

- 1 OPL: The OPL (overpressure limit) for the device depends on the lowest-rated element, with regard to pressure, of the selected components, i.e. the process connection must be taken into consideration in addition to the measuring cell. Observe pressure-temperature dependency. The OPL may only be applied for a short period of time.
 - 2 MWP: The MWP (maximum working pressure) for the measuring cells depends on the lowest-rated element, with regard to pressure, of the selected components, i.e. the process connection also has to be taken into consideration besides the measuring cell. Observe pressure-temperature dependency. The maximum working pressure may be applied at the device for an unlimited period of time. The maximum working pressure can be found on the nameplate.
 - 3 The maximum measuring range corresponds to the span between the LRL and URL. This measuring range is equivalent to the maximum span that can be calibrated/adjusted.
 - 4 The calibrated/adjusted span corresponds to the span between the LRV and URV. Factory setting: 0 to URL. Other calibrated spans can be ordered as customized spans.
- p Pressure
 LRL Lower range limit
 URL Upper range limit
 LRV Lower range value
 URV Upper range value
 TD Turn down Example - see the following section.

Turn down calculation

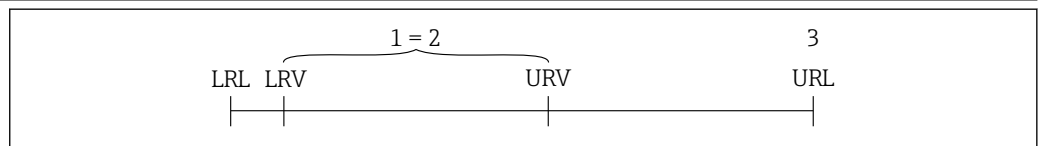

A0029545

- 1 Calibrated/adjusted span
- 2 Zero point-based span
- 3 Upper range limit

Example:

- Measuring cell: 10 bar (150 psi)
- Upper range limit (URL) = 10 bar (150 psi)
- Calibrated/adjusted span: 0 to 5 bar (0 to 75 psi)
- Lower range value (LRV) = 0 bar (0 psi)
- Upper range value (URV) = 5 bar (75 psi)

$$TD = \frac{URL}{|URV - LRV|}$$

In this example, the TD is therefore 2:1. This measuring span is based on the zero point.

Graphic conventions

- Installation, explosion and electrical connection drawings are presented in simplified format
- Devices, assemblies, components and dimensional drawings are presented in reduced-line format
- Dimensional drawings are not to-scale representations; the dimensions indicated are rounded off to 2 decimal places
- Unless otherwise described, flanges are presented with sealing surface form EN 1092-1; ASME B16.5, RF.

Function and system design

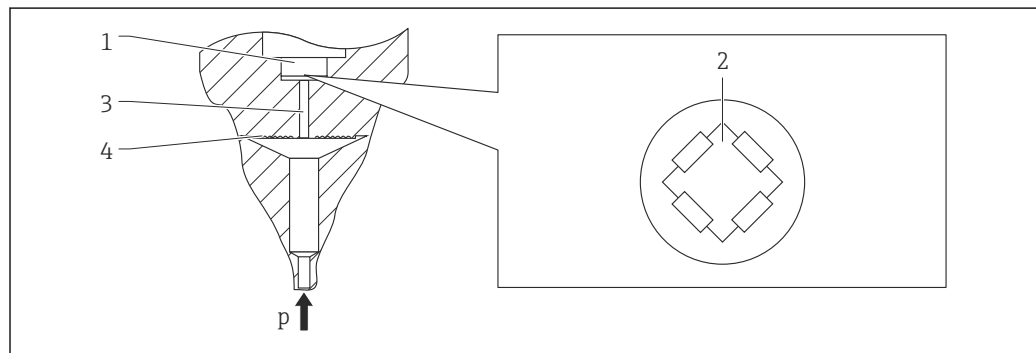
Measuring principle**Metallic membrane**

A0016448

- 1 Measuring element
 2 Wheatstone bridge
 3 Channel with fill fluid
 4 Metallic membrane
 p Pressure

The applied pressure deflects the metallic membrane of the measuring cell. A fill fluid transfers the pressure to a Wheatstone bridge (semiconductor technology). The pressure-dependent change in the bridge output voltage is measured and evaluated.

Advantages:

- Can be used for high process temperatures
- Condensate-resistant
- High long-term stability
- High overload resistance

Measuring system

A complete measuring system comprises:

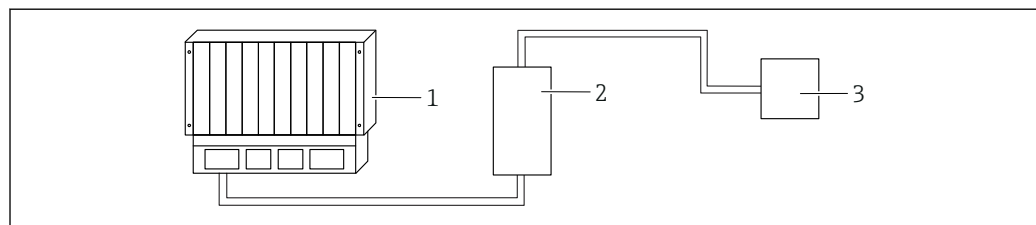

A0053220

- 1 PLC (programmable logic controller)
 2 IO-Link master
 3 Device

Communication and data processing

- Digital communication protocol IO-Link, 3-wire
- Bluetooth (optional)

Reliability

IT security

The manufacturer warranty is valid only if the product is installed and used as described in the Operating Instructions. The product is equipped with security mechanisms to protect it against any inadvertent changes to the settings.

IT security measures, which provide additional protection for the product and associated data transfer, must be implemented by the operators themselves in line with their security standards.

Device-specific IT security

The device offers specific functions to support protective measures by the operator. These functions can be configured by the user and guarantee greater in-operation safety if used correctly. The user role can be changed with an access code (applies to operation via the onsite display, Bluetooth or FieldCare, DeviceCare, Asset Management Tools e.g. AMS, PDM)

Access via Bluetooth® wireless technology

Secure signal transmission via Bluetooth® wireless technology uses an encryption method tested by the Fraunhofer Institute.

- Without the SmartBlue app, the device is not visible via Bluetooth® wireless technology.
- Only one point-to-point connection is established between the device and a smartphone or tablet.
- The Bluetooth® wireless technology interface can be disabled via onsite operation (optional) or SmartBlue.

Input

Measured variable

Measured process variables

- Absolute pressure
- Gauge pressure

Calculated process variables

Pressure

Measuring range

Depending on the device configuration, the maximum working pressure (MWP) and the overpressure limit (OPL) can deviate from the values in the tables.

Absolute pressure

Measuring cell	Maximum measuring range		Smallest factory-calibratable span	
	lower (LRL)	upper (URL)	Standard	Platinum
	[bar (psi)]	[bar (psi)]	[bar (psi)]	
400 mbar (6 psi)	0	+0.4 (+6)	0.05 (0.75) ¹⁾	80 mbar (1.2 psi)
1 bar (15 psi)	0	+1 (+15)	0.05 (0.75) ²⁾	200 mbar (3 psi)
2 bar (30 psi)	0	+2 (+30)	0.10 (1.50) ²⁾	400 mbar (6 psi)
4 bar (60 psi)	0	+4 (+60)	0.20 (3.00) ²⁾	800 mbar (12 psi)
10 bar (150 psi)	0	+10 (+150)	0.50 (7.50) ²⁾	2 bar (30 psi)
40 bar (600 psi)	0	+40 (+600)	2.00 (30.0) ²⁾	8 bar (120 psi)
100 bar (1 500 psi)	0	+100 (+1500)	5.00 (73) ²⁾	20 bar (300 psi)

1) Largest factory-configurable turn down: 8:1

2) Largest factory-configurable turn down: 20:1

Absolute pressure

Measuring cell	MWP	OPL	Factory settings ¹⁾
	[bar (psi)]	[bar (psi)]	
400 mbar (6 psi)	1 (14.5)	1.6 (23)	0 to 400 mbar (0 to 6 psi)
1 bar (15 psi)	2.7 (39)	4 (58)	0 to 1 bar (0 to 15 psi)
2 bar (30 psi)	6.7 (97)	10 (145)	0 to 2 bar (0 to 30 psi)
4 bar (60 psi)	10.7 (155)	16 (232)	0 to 4 bar (0 to 60 psi)
10 bar (150 psi)	25 (362)	40 (580)	0 to 10 bar (0 to 150 psi)
40 bar (600 psi)	100 (1450)	160 (2320)	0 to 40 bar (0 to 600 psi)
100 bar (1 500 psi)	103.5 (1500)	160 (2320)	0 to 100 bar (0 to 1 500 psi)

- 1) Different measuring ranges (e.g. -1 to +5 bar (-15 to +75 psi)) can be ordered with customized settings. It is possible to invert the output signal (LRV = 20 mA; URV = 4 mA). Prerequisite: URV < LRV

Gauge pressure

Measuring cell	Maximum measuring range		Smallest factory-calibratable span ¹⁾	
	lower (LRL)	upper (URL)	Standard	Platinum
	[bar (psi)]	[bar (psi)]	[bar (psi)]	
400 mbar (6 psi)	-0.4 (-6)	+0.4 (+6)	0.05 (0.75) ²⁾	80 mbar (1.2 psi)
1 bar (15 psi)	-1 (-15)	+1 (+15)	0.05 (0.75) ³⁾	200 mbar (3 psi)
2 bar (30 psi)	-1 (-15)	+2 (+30)	0.10 (1.50) ³⁾	400 mbar (6 psi)
4 bar (60 psi)	-1 (-15)	+4 (+60)	0.20 (3.00) ³⁾	800 mbar (12 psi)
10 bar (150 psi)	-1 (-15)	+10 (+150)	0.50 (7.50) ³⁾	2 bar (30 psi)
25 bar (375 psi)	-1 (-15)	+25 (+375)	1.25 (18.50) ³⁾	5 bar (75 psi)
40 bar (600 psi)	-1 (-15)	+40 (+600)	2.00 (30.00) ³⁾	8 bar (120 psi)
100 bar (1 500 psi)	-1 (-15)	+100 (+1500)	5.00 (73) ³⁾	20 bar (300 psi)

- 1) Largest factory-configurable turn down: 5:1.
 2) Largest factory-configurable turn down: 8:1
 3) Largest factory-configurable turn down: 20:1

Gauge pressure

Measuring cell	MWP	OPL	Factory settings ¹⁾
	[bar (psi)]	[bar (psi)]	
400 mbar (6 psi)	1 (14.5)	1.6 (23)	0 to 400 mbar (0 to 6 psi)
1 bar (15 psi)	2.7 (39)	4 (58)	0 to 1 bar (0 to 15 psi)
2 bar (30 psi)	6.7 (97)	10 (145)	0 to 2 bar (0 to 30 psi)
4 bar (60 psi)	10.7 (155)	16 (232)	0 to 4 bar (0 to 60 psi)
10 bar (150 psi)	25 (363)	40 (580)	0 to 10 bar (0 to 150 psi)
25 bar (375 psi)	25.8 (375)	100 (1450)	0 to 25 bar (0 to 375 psi)
40 bar (600 psi)	100 (1450)	160 (2320)	0 to 40 bar (0 to 600 psi)
100 bar (1 500 psi)	103.5 (1500)	160 (2320)	0 to 100 bar (0 to 1 500 psi)

- 1) Different measuring ranges (e.g. -1 to +5 bar (-15 to +75 psi)) can be ordered with customized settings. It is possible to invert the output signal (LRV = 20 mA; URV = 4 mA). Prerequisite: URV < LRV

Output

Output signal	<ul style="list-style-type: none"> 2 outputs, configurable as switch output, analog output or IO-Link output The current output offers a choice of three different operating modes: <ul style="list-style-type: none"> 4 to 20.5 mA NAMUR NE 43: 3.8 to 20.5 mA (factory setting) US mode: 3.9 to 20.5 mA
Switching capacity	<ul style="list-style-type: none"> Switch status ON: $I_a \leq 200 \text{ mA}$ ¹⁾; switch status OFF: $I_a < 0.1 \text{ mA}$ ²⁾ Switch cycles: $> 1 \cdot 10^7$ Voltage drop PNP: $\leq 2 \text{ V}$ Overload protection: Automatic load testing of switching current; <ul style="list-style-type: none"> Max. capacitive load: $1 \mu\text{F}$ at max. supply voltage (without resistive load) Max. cycle duration: 0.5 s; min. t_{on}: $40 \mu\text{s}$ Periodic disconnection from protective circuit in the event of overcurrent ($f = 1 \text{ Hz}$)
Signal on alarm for devices with current output	<p>Current output Signal on alarm in accordance with NAMUR recommendation NE 43.</p> <ul style="list-style-type: none"> Max. alarm: can be set from 21.5 to 23 mA Min. alarm: $< 3.6 \text{ mA}$ (factory setting) <p>Onsite display and operating tool via digital communication Status signal (according to NAMUR Recommendation NE 107): Plain text display</p>
Load	<p>For the current output, the following applies: In order to guarantee sufficient terminal voltage, a maximum load resistance R_L (including line resistance) must not be exceeded, depending on the supply voltage U of the supply unit.</p> <div data-bbox="501 1077 1533 1507"> <p style="text-align: right;">$2 \rightarrow R_{L\text{max}} \leq \frac{U - 12\text{V}}{23 \text{ mA}}$</p> </div> <p style="text-align: right;">A0052602</p> <p>1 Power supply 12 to 30 V 2 $R_{L\text{max}}$ maximum load resistance U Supply voltage</p> <p>If load is too great:</p> <ul style="list-style-type: none"> Failure current is indicated and error message is displayed (indication: MIN alarm current) Periodic checking to establish if it is possible to quit fault state
Damping	<p>A damping affects all continuous outputs. Factory setting: 1 s (can be configured from 0 to 999 s)</p>

- 1) If outputs "1 x PNP + 4 to 20 mA" are used at the same time, switch output OUT1 can be loaded with up to 100 mA load current over the entire temperature range. Up to 50°C (122°F) ambient temperature and up to 85°C (185°F) process temperature, the switching current may be up to 200 mA. If the "1 x PNP" or "2 x PNP" configuration is used, the switch outputs can be loaded in total with up to 200 mA over the entire temperature range.
- 2) Differing for switch output OUT2, for switch status OFF: $I_a < 3.6 \text{ mA}$ and $U_a < 2 \text{ V}$ and for switch status ON: voltage drop PNP: $\leq 2.5 \text{ V}$

Protocol-specific data	IO-Link specification 1.1.3 Device type ID: 0x92 0xC5 0x01
------------------------	---

Energy supply

Terminal assignment	2-wire
---------------------	--------

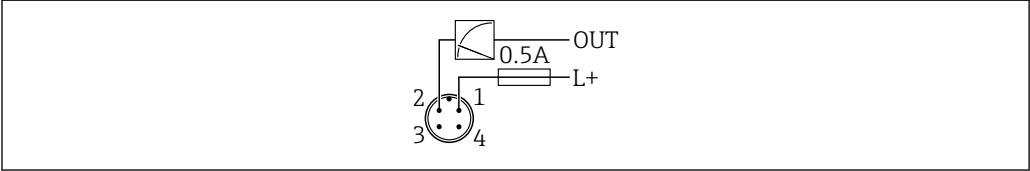

A0052660

- 1 Supply voltage L+, brown wire (BN)
- 2 OUT (L-), white wire (WH)

3-wire or 4-wire

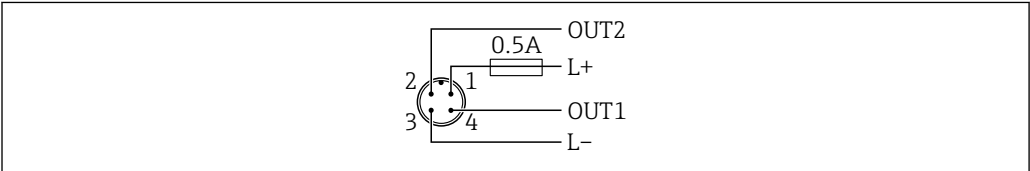

A0052457

- 1 Supply voltage L+, brown wire (BN)
- 2 Switch or analog output (OUT2), white wire (WH)
- 3 Supply voltage L-, blue wire (BU)
- 4 Switching or IO-Link output (OUT1), black wire (BK)

The functionality of output 1 and 2 can be configured.

Connection examples

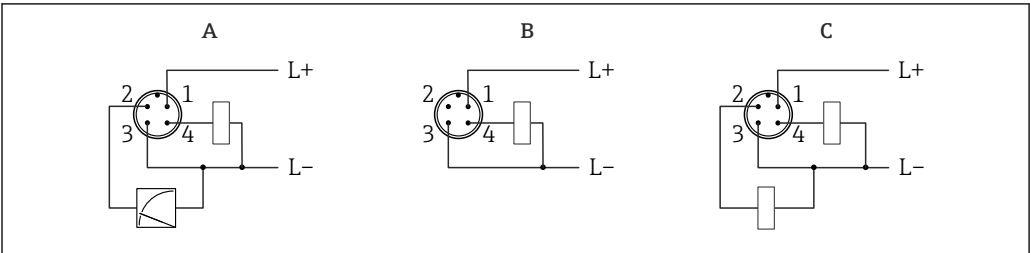

A0052458

- A 1 x PNP switch and analog output
- B 1 x PNP switch output
- C 2 x PNP switch output

Available device plugs	M12 plug For further information, see the "Device-specific accessories" section
------------------------	---

Supply voltage	12 to 30 V _{DC} on a direct current power unit IO-Link communication is guaranteed only if the supply voltage is at least 18 V. The power unit must be tested to ensure it meets safety requirements (e.g. PELV, SELV, Class 2) and must comply with the relevant protocol specifications. A suitable circuit breaker should be provided for the device in accordance with IEC/EN 61010-1.
----------------	--

Protective circuits against reverse polarity, HF influences and overvoltage peaks are installed.

Power consumption	Non-hazardous area: To meet device safety specifications according to the IEC/EN 61010 standard, the installation must ensure that the maximum current is limited to 500 mA.
Potential equalization	If necessary, establish potential equalization using the process connection or the grounding clamp supplied by the customer.
Overvoltage protection	<p>The device satisfies the IEC/DIN EN 61326-1 product standard (Table 2 Industrial environment). Depending on the type of connection (DC power supply, input line, output line), different test levels are used to prevent transient overvoltages (IEC/DIN EN 61000-4-5 Surge) in accordance with IEC/DIN EN 61326-1: Test level for DC power supply lines and IO lines: 1 000 V wire to ground.</p> <p>Overvoltage category</p> <p>In accordance with IEC/DIN EN 61010-1, the device is intended for use in networks with overvoltage protection category II.</p>

Performance characteristics

Reference operating conditions	<ul style="list-style-type: none"> ■ As per IEC 62828-2 ■ Ambient temperature T_A = constant, in the range of +21 to +33 °C (+70 to +91 °F) ■ Humidity ϕ = constant, in the range of: 5 to 80 % RH \pm 5 % ■ Atmospheric pressure p_A = constant, in the range of: 860 to 1 060 mbar (12.47 to 15.37 psi) ■ Supply voltage: $24 V_{DC} \pm 3 V_{DC}$ ■ Position of the measuring cell: horizontal $\pm 1^\circ$ ■ Input of LOW SENSOR TRIM and HIGH SENSOR TRIM for lower range value and upper range value ■ Zero based span ■ Turn down (TD) = $URL / URV - LRV$
Resolution	Current output: < 1 μ A
Total performance	<p>The performance characteristics refer to the accuracy of the device. The factors influencing accuracy can be divided into two groups.</p> <ul style="list-style-type: none"> ■ Total performance of device ■ Installation factors <p>All of the performance characteristics meet the requirement of $\geq \pm 3$ sigma.</p> <p>The total performance of the device comprises the reference accuracy and the ambient temperature effect and is calculated using the following formula:</p> $\text{Total performance} = \pm \sqrt{(E1)^2 + (E2)^2}$ <p>$E1$ = Reference accuracy</p> <p>$E2$ = Temperature effect</p> <p>Calculation of $E2$:</p> <p>Temperature effect per $\pm 28^\circ\text{C}$ (50°F)</p> <p>(corresponds to a range of -3 to $+53^\circ\text{C}$ ($+27$ to $+127^\circ\text{F}$))</p> $E2 = E2_M + E2_E$ <p>$E2_M$ = Main temperature error</p> <p>$E2_E$ = Electronics error</p> <p>The values refer to the calibrated span. The span is based on the zero point.</p> <p>Reference accuracy [E1]</p> <p>The reference accuracy comprises the non-linearity according to the limit point method, pressure hysteresis and non-repeatability in accordance with [IEC 61298-2].</p>

Platinum not for flush-mounted process connections Clamp DN22, G ½.

Measuring cell	Standard	Platinum
400 mbar (6 psi)	TD 1:1 = $\pm 0.2\%$ TD > 1:1 to 10:1 = $\pm 0.5\% \cdot \text{TD}$	-
1 bar (15 psi)	TD 1:1 = $\pm 0.1\%$ TD > 1:1 to 10:1 = $\pm 0.3\% \cdot \text{TD}$	TD 1:1 = $\pm 0.1\%$ TD > 1:1 to 10:1 = $\pm 0.2\% \cdot \text{TD}$
2 bar (30 psi)	TD 1:1 to 5:1 = $\pm 0.1\%$ TD > 5:1 to 10:1 = $\pm 0.2\%$	TD 1:1 to 5:1 = $\pm 0.075\%$ TD > 5:1 to 10:1 = $\pm 0.1\%$
4 bar (60 psi) 10 bar (150 psi) 25 bar (375 psi)	TD 1:1 to 10:1 = $\pm 0.1\%$ TD > 10:1 to 20:1 = $\pm 0.2\%$	TD 1:1 to 10:1 = $\pm 0.075\%$ TD > 10:1 to 20:1 = $\pm 0.1\%$
40 bar (600 psi)	TD 1:1 to 10:1 = $\pm 0.1\%$ TD > 10:1 to 20:1 = $\pm 0.3\%$	TD 1:1 to 5:1 = $\pm 0.075\%$ TD > 5:1 to 10:1 = $\pm 0.15\%$
100 bar (1 500 psi)	TD 1:1 to 10:1 = $\pm 0.1\%$ TD > 10:1 to 20:1 = $\pm 0.2\%$	TD 1:1 to 10:1 = $\pm 0.075\%$ TD > 10:1 to 20:1 = $\pm 0.15\%$

Temperature effect [E2]

$E2_M$ - Main temperature error

The output changes due to the effect of the ambient temperature [IEC 62828-1] with respect to the reference temperature [IEC 62828-1]. The values specify the maximum error due to min./max. ambient or process temperature conditions.

Application feature: process temperature +100 °C (+212 °F), process +130 °C (+266 °F) temperature (+150 °C (+302 °F) max. 1h), process temperature +150 °C (+302 °F)

- 400 mbar (6 psi) measuring cell
 - Process connection clamp 1", DIN11851 DN25, NEUMO BioControl DN25, NPT 3/4", NPT 1", G1" flush-mounted, G1" with O-ring, G1" with sealing taper, Aseptoflex: $\pm(1.05\% \cdot \text{TD} + 0.10\%)$
 - Process connection SMS 1", ingold fitting: $\pm(1.55\% \cdot \text{TD} + 0.10\%)$
 - Process connection MNPT1/2 bore 11.4 mm, MPNT1/2 FNPT1/4, G1/2" EN837, G1/2 bore 11.4 mm, M20 x 1.5: $\pm(0.20\% \cdot \text{TD} + 0.10\%)$
 - All other process connections: $\pm(0.63\% \cdot \text{TD} + 0.10\%)$
- 1 bar (15 psi) measuring cell
 - Process connection clamp 1", DIN11851 DN25, NEUMO BioControl DN25, NPT 3/4", NPT 1", G1" flush-mounted, G1" with O-ring, G1" with sealing taper, Aseptoflex: $\pm(0.42\% \cdot \text{TD} + 0.10\%)$
 - Process connection SMS 1", ingold fitting: $\pm(1.62\% \cdot \text{TD} + 0.10\%)$
 - All other process connections: $\pm(0.25\% \cdot \text{TD} + 0.10\%)$
- 2 bar (30 psi) measuring cell
 - Process connection SMS 1", ingold fitting: $\pm(0.35\% \cdot \text{TD} + 0.10\%)$
 - All other process connections: $\pm(0.25\% \cdot \text{TD} + 0.10\%)$
- 4 bar (60 psi), 10 bar (150 psi), 25 bar (375 psi), 40 bar (600 psi) and 100 bar (1 500 psi) measuring cell
 $\pm(0.20\% \cdot \text{TD} + 0.10\%)$

Application feature: Process temperature +200 °C (+392 °F)

- 400 mbar (6 psi) measuring cell
 - Process connection clamp 1", clamp 1 1/2", DIN11851 DN25, NEUMO BioControl DN25, NPT 3/4", NPT 1", G1" flush-mounted, G1" with O-ring, G1" with sealing taper, Aseptoflex: $\pm(1.47 \% \cdot \text{TD} + 0.10 \%)$
 - Process connection SMS 1": $\pm(1.75 \% \cdot \text{TD} + 0.10 \%)$
 - All other process connections: $\pm(0.63 \% \cdot \text{TD} + 0.10 \%)$
- 1 bar (15 psi) measuring cell
 - Process connection clamp 1", DIN 11851 DN25, NEUMO BioControl DN25, NPT 3/4", NPT 1", G1" flush-mounted, G1" mounting, G1" with sealing taper: $\pm(0.59 \% \cdot \text{TD} + 0.10 \%)$
 - Process connection SMS 1", ingold fitting: $\pm(0.7 \% \cdot \text{TD} + 0.10 \%)$
 - All other process connections: $\pm(0.25 \% \cdot \text{TD} + 0.10 \%)$
- 2 bar (30 psi) measuring cell
 - Clamp 1", DIN 11851 DN25, NEUMO BioControl DN25, NPT 3/4", NPT 1", G1" flush-mounted, G1" mounting, G1" with sealing taper: $\pm(0.35 \% \cdot \text{TD} + 0.10 \%)$
 - Process connection SMS 1": $\pm(0.4 \% \cdot \text{TD} + 0.10 \%)$
 - All other process connections: $\pm(0.25 \% \cdot \text{TD} + 0.10 \%)$
- 4 bar (60 psi), 10 bar (150 psi), 25 bar (375 psi), 40 bar (600 psi) and 100 bar (1 500 psi) measuring cell
 $\pm(0.20 \% \cdot \text{TD} + 0.10 \%)$

E_{2E} - Electronics error

Digital output: 0%

Measurement uncertainty for small absolute pressure measuring ranges

The smallest expanded measurement uncertainty that can be passed on by our measurement standards:

- In the range of 1 to 30 mbar (0.0145 to 0.435 psi): 0.4 % of reading
- In the range of < 1 mbar (0.0145 psi): 1 % of reading

Total error

The total error of the device comprises the total performance and the long-term stability effect and is calculated using the following formula:

Total error = total performance + long-term stability

Long-term stability

The specifications refer to the upper range limit (URL).

- 1 year: $\pm 0.2 \%$
- 5 years: $\pm 0.4 \%$
- 10 years: $\pm 0.5 \%$
- 15 years: $\pm 0.6 \%$

Response time

Dead time, time constant

Representation of dead time and time constant as per IEC62828-1:

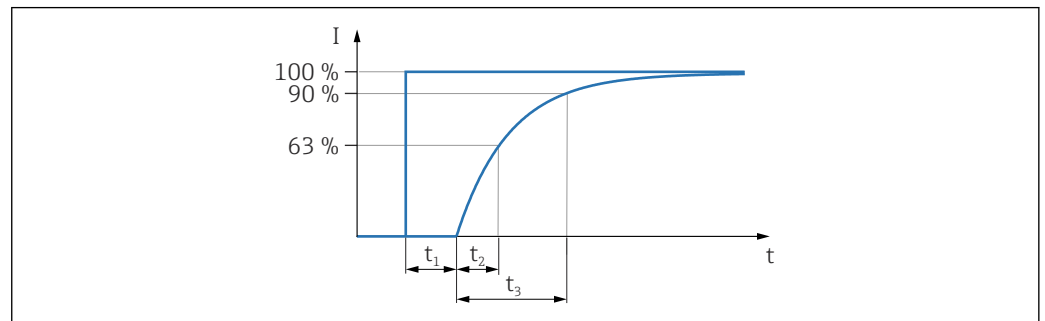

A0019786

Step response time = dead time (t_1) + time constant T_{90} (t_3) according to IEC62828-1

Dynamic behavior of switch output

$\leq 20 \text{ ms}$

Dynamic behavior, current output

- Dead time (t_1): maximum 50 ms
- Time constant T63 (t_2): maximum 60 ms
- Time constant T90 (t_3): maximum 100 ms

Warm-up time

The warm-up time (in accordance with IEC 62828-4) indicates the time required for the device to reach its maximum accuracy or performance after the supply voltage is energized.

Warm-up time: ≤ 10 s

Installation

Mounting position

The orientation depends on the measuring application and can cause a zero point shift (when the vessel is empty, the measured value does not show zero). The zero point shift can be corrected electronically with the device.

Installation instructions

- During installation, it is important to ensure that the sealing element used has a permanent operating temperature that corresponds to the maximum temperature of the process.
- Devices are suitable for use in wet environments in accordance with IEC/DIN EN 61010-1
- The devices are installed according to the same guidelines as manometers.
- Protect the housing against impact.
- Devices with CSA approval are intended for indoor use.

Environment

Ambient temperature range

-40 to +85 °C (-40 to +185 °F)

The permitted ambient temperature is reduced at higher process temperatures.

i The following information only takes into account functional aspects. Additional restrictions may apply for certified device versions.

The permitted process temperature varies, depending on the process connection used. For an overview of the process connections, see Section "Process temperature range".

Maximum process temperature +130 °C (+266 °F)

(Product feature "Application"; order option "B")

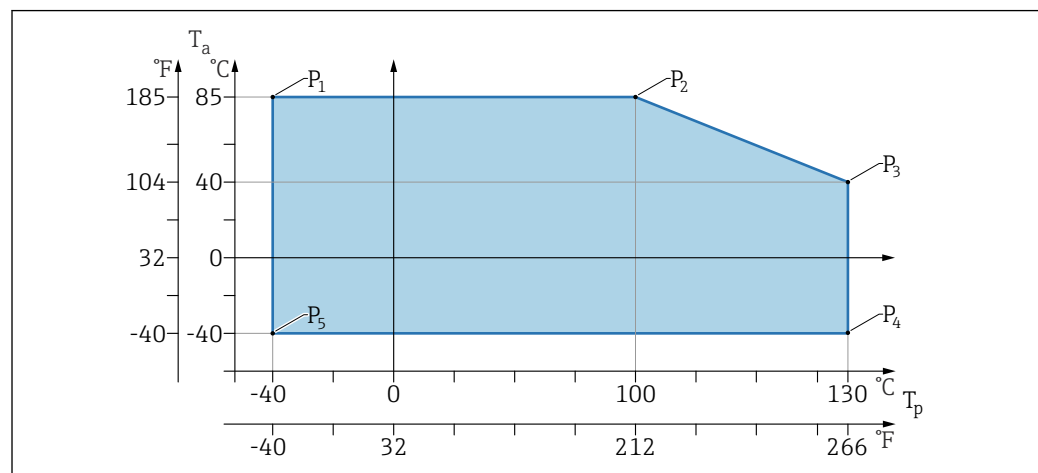

A0055963

1 Ambient temperature T_a depending on the process temperature T_p

P	T _p	T _a
P1	-40 °C (-40 °F)	+85 °C (+185 °F)
P2	+100 °C (+212 °F)	+85 °C (+185 °F)
P3	+130 °C (+266 °F)	+40 °C (+77 °F)
P4	+130 °C (+266 °F)	-40 °C (-40 °F)
P5	-40 °C (-40 °F)	-40 °C (-40 °F)

Maximum process temperature +150 °C (+302 °F)

(Product feature "Application"; order option "C")

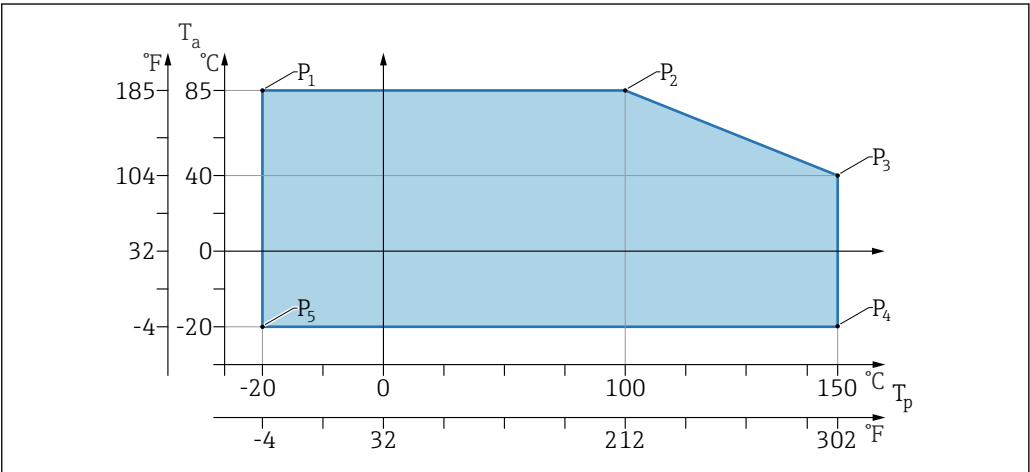

2 Ambient temperature T_a depending on the process temperature T_p

P	T _p	T _a
P1	-20 °C (-4 °F)	+85 °C (+185 °F)
P2	+100 °C (+212 °F)	+85 °C (+185 °F)
P3	+150 °C (+302 °F)	+40 °C (+77 °F)
P4	+150 °C (+302 °F)	-20 °C (-4 °F)
P5	-20 °C (-4 °F)	-20 °C (-4 °F)

Maximum process temperature +200 °C (+392 °F)

(Product feature "Application"; order option "D")

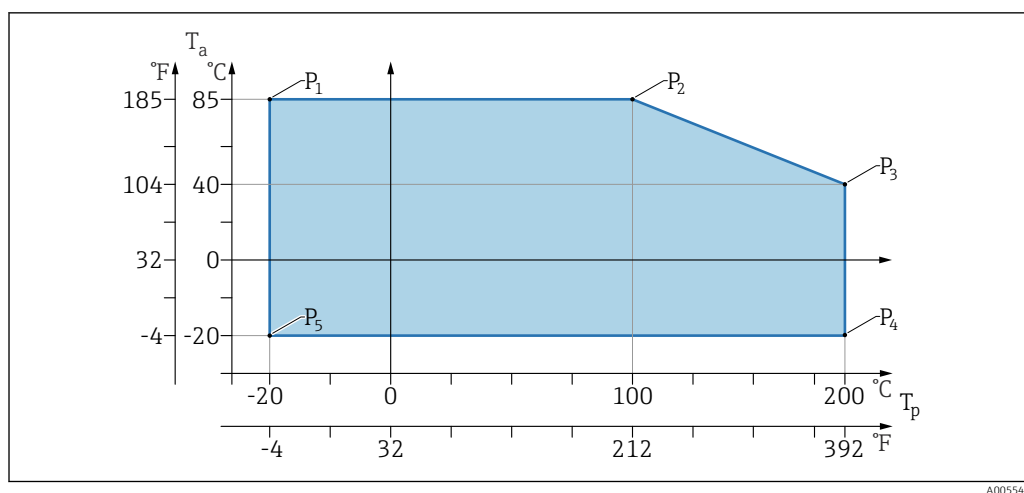

A0055469

■ 3 Ambient temperature T_a depending on the process temperature T_p

P	T_p	T_a
P1	-20 °C (-4 °F)	+85 °C (+185 °F)
P2	+100 °C (+212 °F)	+85 °C (+185 °F)
P3	+200 °C (+392 °F)	+40 °C (+77 °F)
P4	+200 °C (+392 °F)	-20 °C (-4 °F)
P5	-20 °C (-4 °F)	-20 °C (-4 °F)

Storage temperature -40 to +85 °C (-40 to +185 °F)

Operating height Up to 5 000 m (16 404 ft) above sea level

Climate class According to IEC 60068-2-38 test Z/AD (relative humidity 4 to 100 %).

Degree of protection Test as per IEC 60529 Edition 2.2 2013-08/ DIN EN 60529:2014-09 and NEMA 250-2014
For mounted M12 connecting cable: IP66/68/69, NEMA type 4X/6P
/IP68; (1.83 mH₂O for 24 h))

Pollution degree Pollution degree 2 according to IEC/EN 61010-1.

Vibration resistance

- Stochastic noise (random sweep) as per IEC/DIN EN 60068-2-64 Case 2 /
- Guaranteed for 5 to 2 000 Hz: 1.25 (m/s²)²/Hz, ~ 5 g
- Sinusoidal vibration according to IEC 62828-1:2017 with 10 to 60 Hz ±0.35 mm; 60 to 1 000 Hz 5 g

Shock resistance

- Testing standard: IEC/DIN EN 60068-2-27 Case 2
- Shock resistance: 30 g (18 ms) in all 3 axes

Electromagnetic compatibility (EMC)

- Electromagnetic compatibility as per IEC/DIN EN 61326 series and NAMUR recommendation EMC (NE21)
- Maximum deviation under interference influence: < 0.5 %

For more details refer to the EU Declaration of Conformity.

Process

Process temperature	Maximum process temperature	Version ¹⁾
	+100 °C (+212 °F)	A
	+130 °C (+266 °F)(+150 °C (+302 °F) ²⁾)	B
	+150 °C (+302 °F)	C
	+200 °C (+392 °F)	D

1) Product Configurator, "Application" feature

2) Temperature for maximum one hour (device in operation but not within measurement specification)

Fill fluid

Fill fluid	Process temperature range	Version ¹⁾
Synthetic oil, FDA	-40 to +130 °C (-40 to +266 °F)(+150 °C (+302 °F) ²⁾)	3
Vegetable oil, FDA	-20 to +200 °C (-4 to +392 °F)	4

1) Product Configurator, "Fill fluid" feature

2) Temperature for one hour maximum (device in operation but not within measurement specification)

Process pressure range

Pressure specifications



The maximum pressure for the device depends on the lowest-rated component with regard to pressure (components are: process connection, optional mounted parts or accessories).

- ▶ Only operate the device within the specified limits for the components!
- ▶ MWP (maximum working pressure): The maximum working pressure is specified on the nameplate. This value refers to a reference temperature of +20 °C (+68 °F) and may be applied to the device for an unlimited time. Note temperature dependence of maximum working pressure. For higher temperatures, refer to the following standards for the permitted pressure values for flanges: EN 1092-1 (materials 1.4435 and 1.4404 are identical with regard to their stability/temperature property and are grouped together in under 13E0 in EN 1092-1 Tab. 18; the chemical composition of the two materials can be identical), ASME B 16.5a (the latest version of the standard applies in each case).
- ▶ The overpressure limit is the maximum pressure that a device may be subjected to during a test. It exceeds the maximum working pressure by a certain factor. This value refers to a reference temperature of +20 °C (+68 °F).
- ▶ In the case of sensor range and process connection combinations where the overpressure limit (OPL) of the process connection is less than the nominal value of the measuring cell, the device is set at the factory, at the very maximum, to the OPL value of the process connection. If the entire measuring cell range must be used, select a process connection with a higher OPL value (1.5 x MWP; MWP = PN).
- ▶ The Pressure Equipment Directive (2014/68/EU) uses the abbreviation "PS". The abbreviation "PS" corresponds to the maximum working pressure of the device.
- ▶ For maximum working pressure data that deviate from this, see the "Mechanical construction" section.
- ▶ Avoid dynamic-mechanical stress on the membrane.

Cleaned of oil and grease

Endress+Hauser also offers devices, cleaned of oil and grease, for special applications. No special restrictions regarding the process conditions apply to these devices.

Mechanical construction

Design, dimensions

Device height

The device height is calculated from

- the height of the housing (1)
- configuration-dependent mounted parts (2)
- the height of the relevant process connection (3)

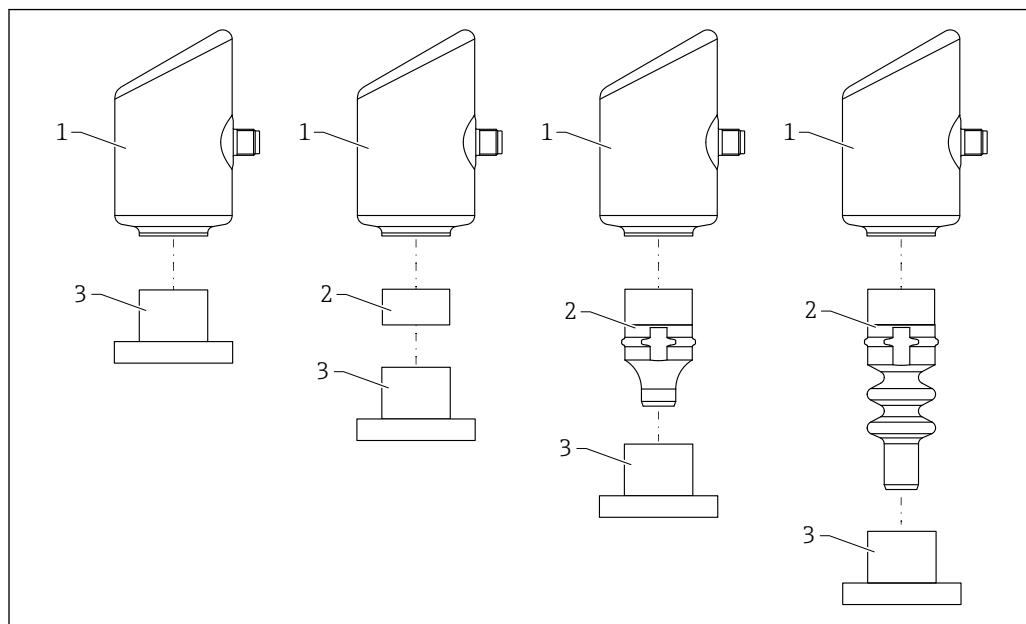

A0055927

- 1 Housing
2 Configuration-dependent mounted parts
3 Process connection

The individual heights of the components are listed in the following sections. To calculate the device height, add the individual heights of the components.

Dimensions

Housing

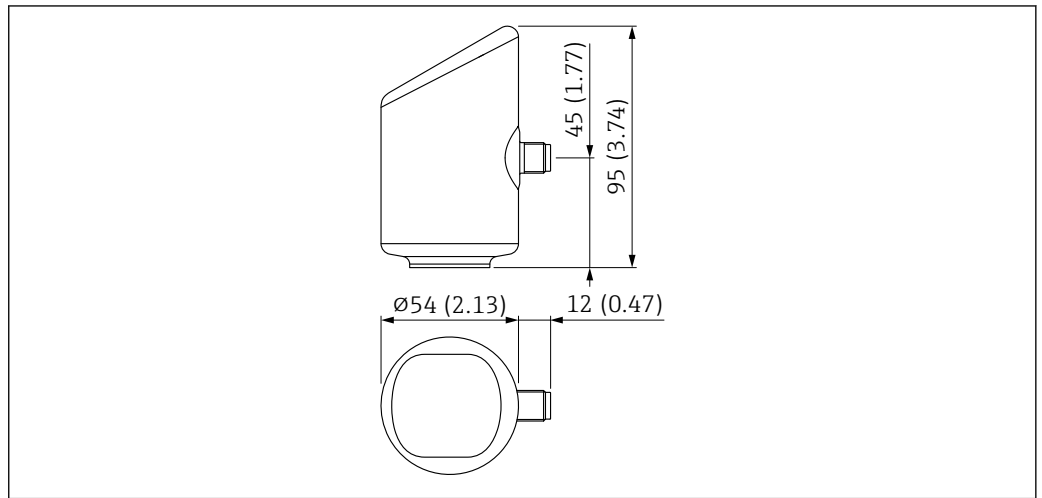

A0052415

Unit of measurement mm (in)

Important information on the process connections

The design of some process connections is determined by the selection of the following features in the product structure:

- Application feature:
 - Process temperature +100 °C (+212 °F)
 - Process temperature +130 °C (+266 °F), +150 °C (+302 °F) max. 1h
 - Process temperature +150 °C (+302 °F)
 - Process temperature +200 °C (+392 °F)
- "Surface refinement" feature:
 - Standard
 - Hygienic RA 0.38µm/15µin electropolished

These features are described for the relevant process connection if they are required.

Explanation of terms

- DN or NPS = alphanumeric designation of a component
- PN or Class = alphanumeric pressure rating of a component
- d_M : membrane diameter (see following graphic)

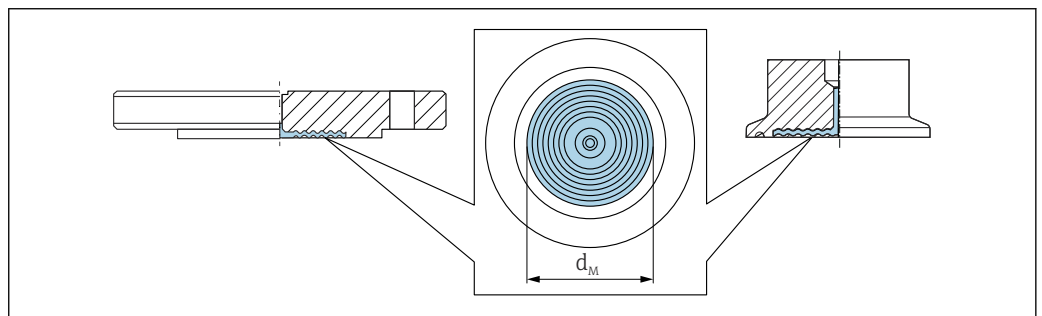

A0056033

Thread ISO 228 G, internal membrane

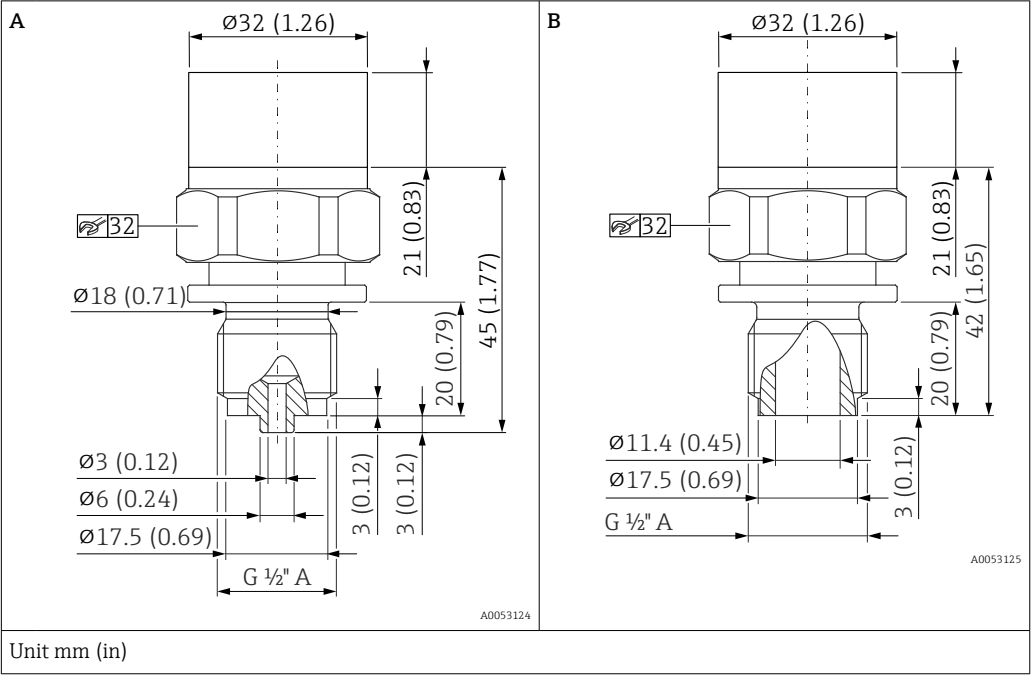

Designation	Graphic	Weight	Order option
		[kg (lb)]	
Thread ISO 228 G 1/2" A, EN 837	A	0.22 (0.49)	WBJ
Thread ISO 228 G 1/2" A, bore 11.4 mm (0.45 in)	B		WWJ

Thread DIN13, internal membrane

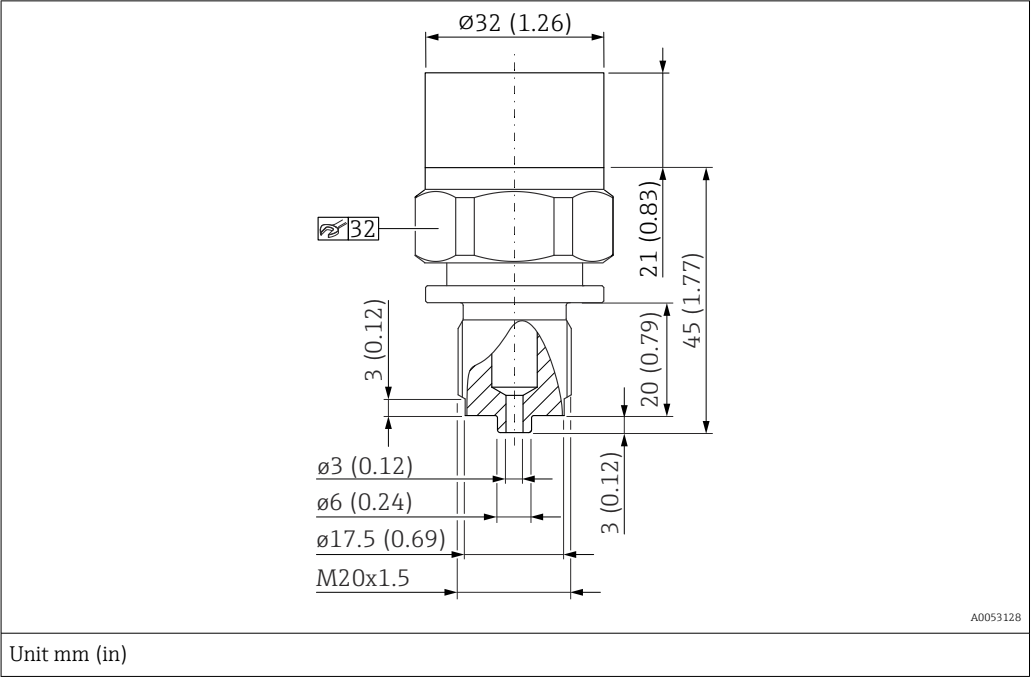

Designation	Weight	Order option
	[kg (lb)]	
DIN 13 M20 x 1.5, EN 837, bore 3 mm (0.12 in)	0.22 (0.49)	X4j

Thread ASME, internal membrane

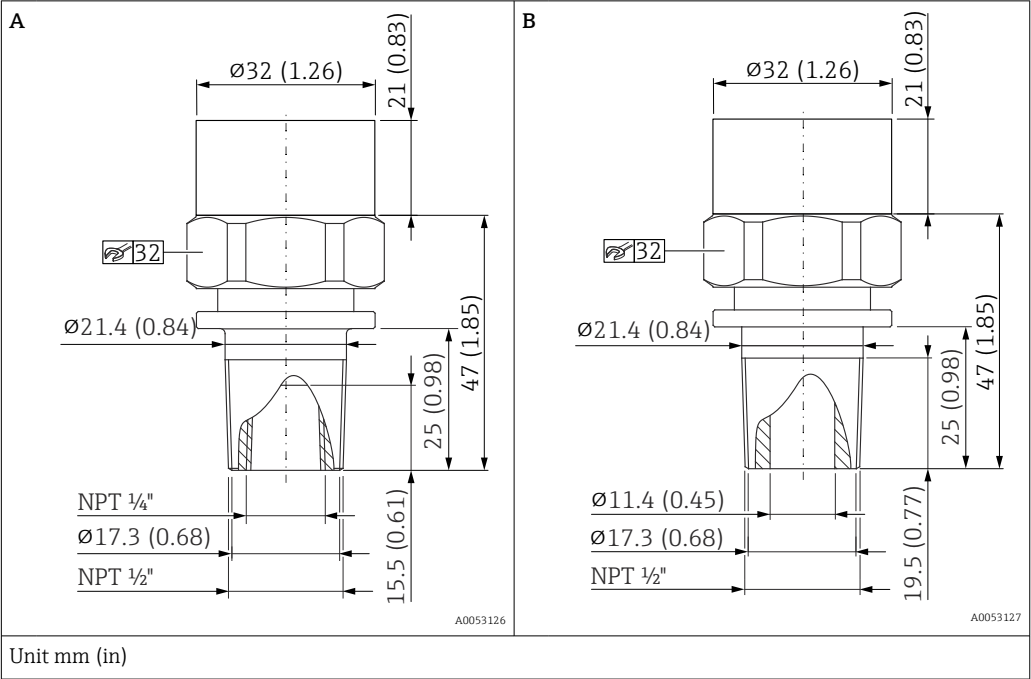

Designation	Graphic	Weight	Order option
		[kg (lb)]	
ASME 1/2" MNPT, 1/4" FNPT (internal)	A	0.23 (0.51)	VXJ
ASME 1/2" MNPT, bore 11.4 mm (0.45 in)	B		VWJ

Thread ISO 228 G, flush membrane

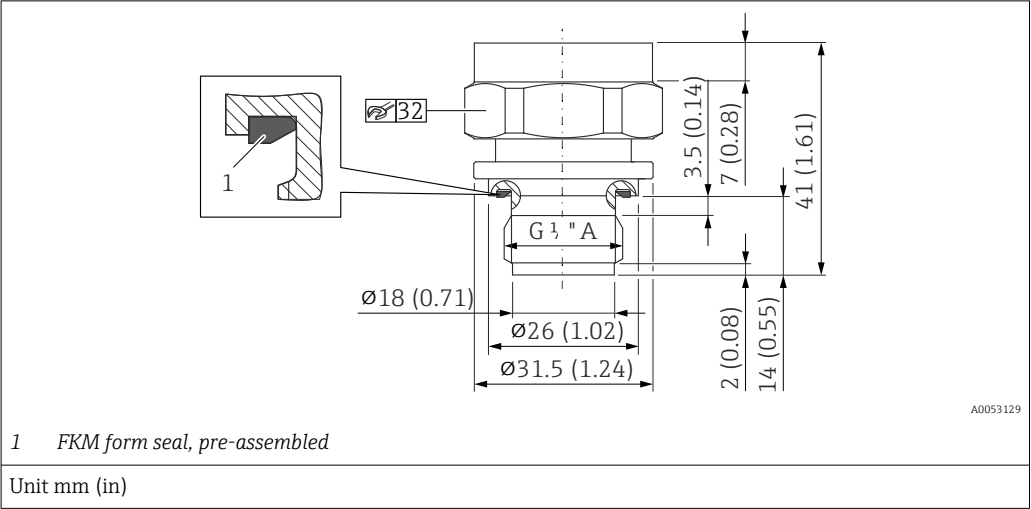

Name	d _M	Weight	Order option
	[mm (in)]	[kg (lb)]	
Thread ISO 228 G ½" A DIN3852, form E	17.2 (0.68)	0.14 (0.31)	WJJ

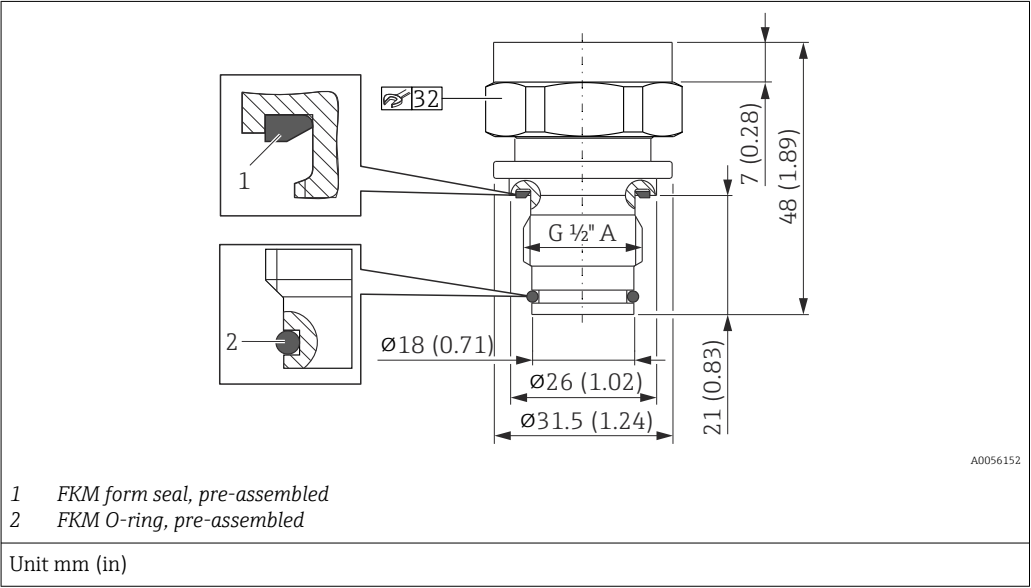

Name	d _M	Weight	Order option
	[mm (in)]	[kg (lb)]	
Thread ISO 228 G ½" A O-ring seal, flush-mounted	17.2 (0.68)	0.15 (0.33)	WUJ

Thread MNPT, flush membrane

<p>A</p> <p><i>X</i> Maximum process temperature +150 °C (+302 °F) <i>Z</i> Maximum process temperature +200 °C (+392 °F)</p> <p>A0052803</p>	<p>B</p> <p><i>X</i> Maximum process temperature +150 °C (+302 °F) <i>Z</i> Maximum process temperature +200 °C (+392 °F)</p> <p>A0052804</p>
<p>C</p> <p><i>X</i> Maximum process temperature +150 °C (+302 °F) <i>Z</i> Maximum process temperature +200 °C (+392 °F)</p> <p>A0052805</p>	<p>D</p> <p><i>X</i> Maximum process temperature +150 °C (+302 °F) <i>Z</i> Maximum process temperature +200 °C (+392 °F)</p> <p>A0052806</p>
Unit mm (in)	

Designation	Graphic	d _M	Weight	Order option
		[mm (in)]	[kg (lb)]	
MNPT 3/4"	A	22 (0.87)	0.22 (0.49)	VHJ
MNPT 1"	B	28 (1.10)	0.33 (0.73)	VJJ
MNPT 1 1/2"	C	41 (1.61)	0.73 (1.61)	VLJ
MNPT 2"	D	48 (1.89)	1.05 (2.32)	VMJ

Thread G1, G 1 1/2, G2, flush membrane

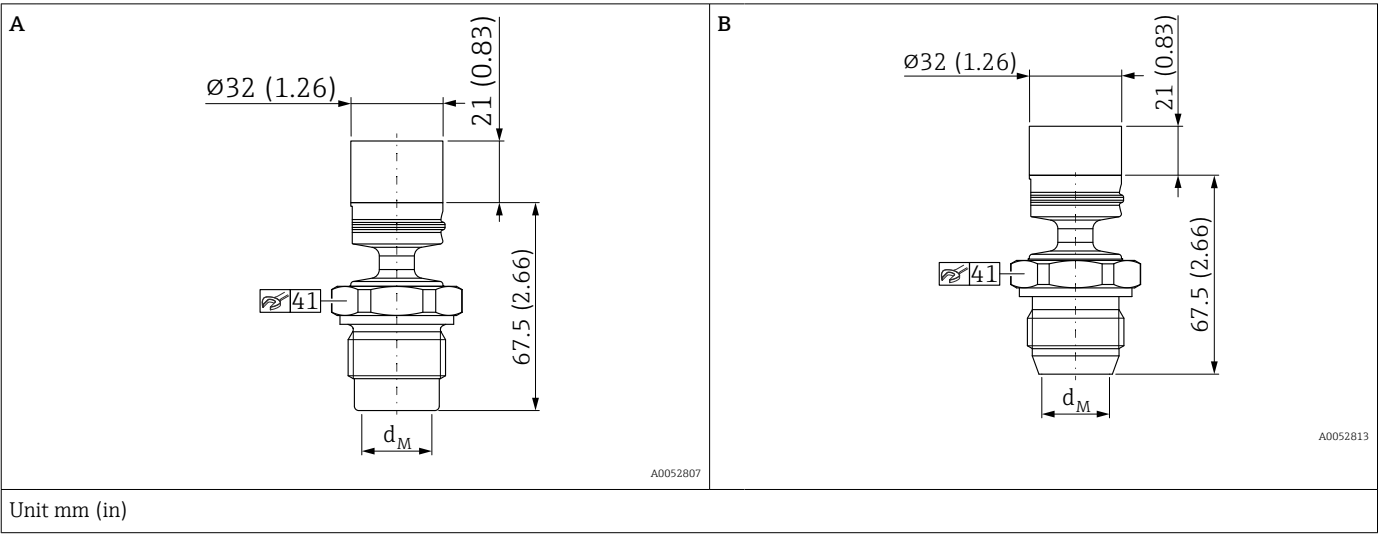

Designation	Graphic	d _M	Weight	Order option
		[mm (in)]	[kg (lb)]	
G1" with O-ring	A	22 (0.87)	0.42 (0.93)	WSJ
G1" with sealing taper	B		0.39 (0.86)	WQJ

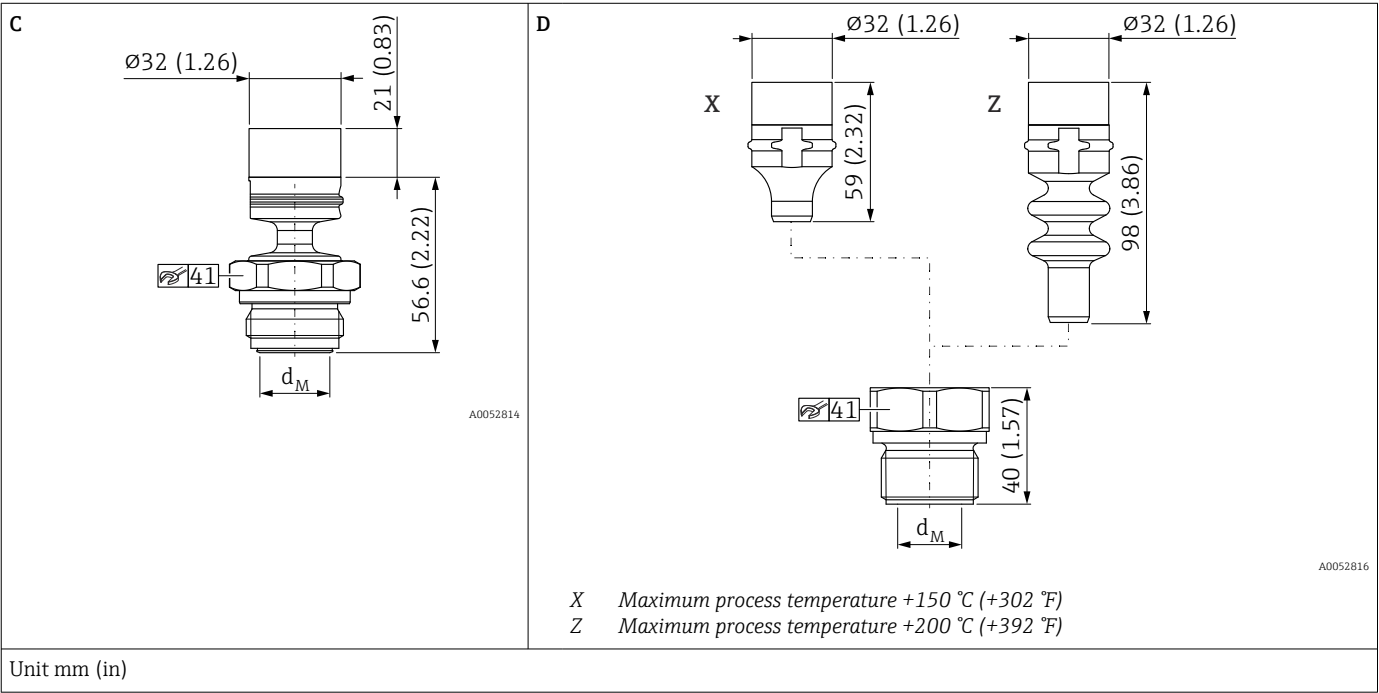

Designation	Graphic	d _M	Weight	Order option
		[mm (in)]	[kg (lb)]	
G1" with Aseptoflex O-ring made from EPDM	C	22 (0.87)	0.35 (0.77)	45J
G1"	D	28 (1.10)	0.34 (0.75)	WLJ

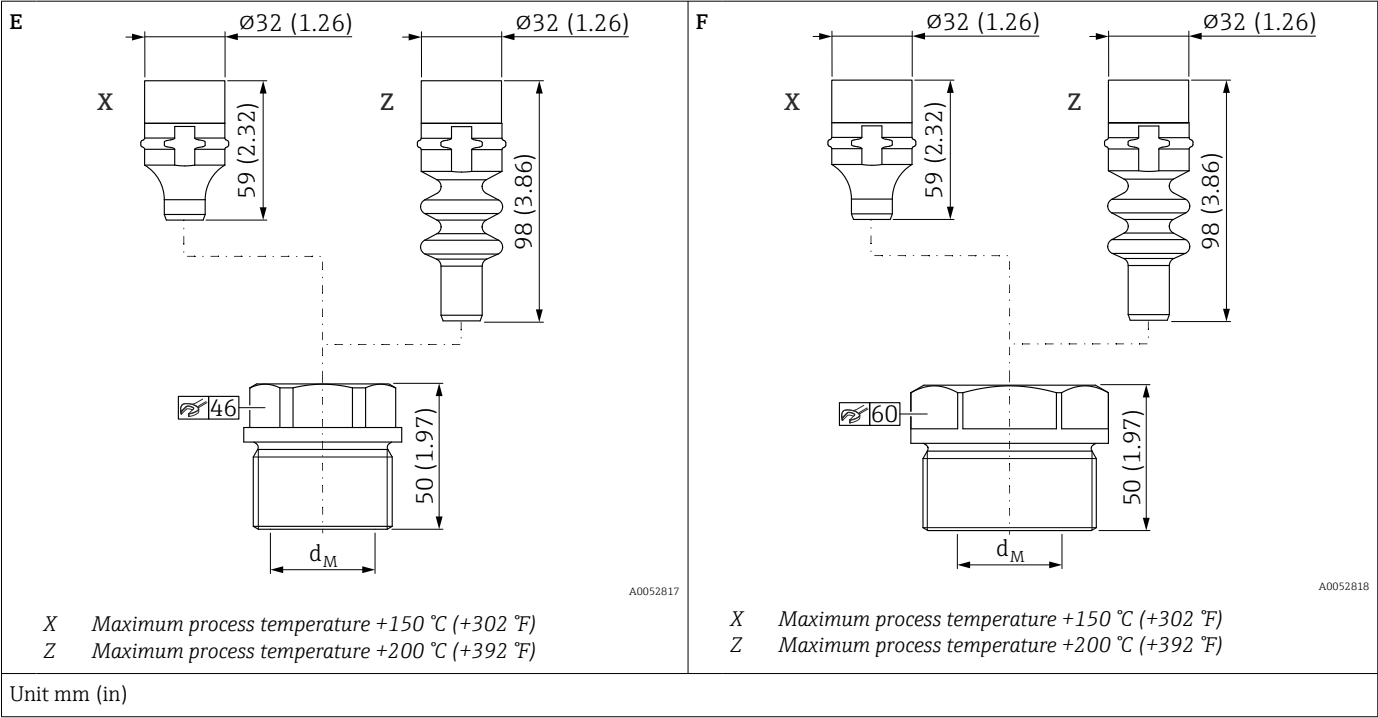

Designation	Graphic	d _M	Weight	Order option
		[mm (in)]	[kg (lb)]	
G1 1/2"	E	41 (1.61)	0.72 (1.59)	WNJ
G2"	F	48 (1.89)	1.17 (2.58)	WPJ

DIN11851, flush membrane

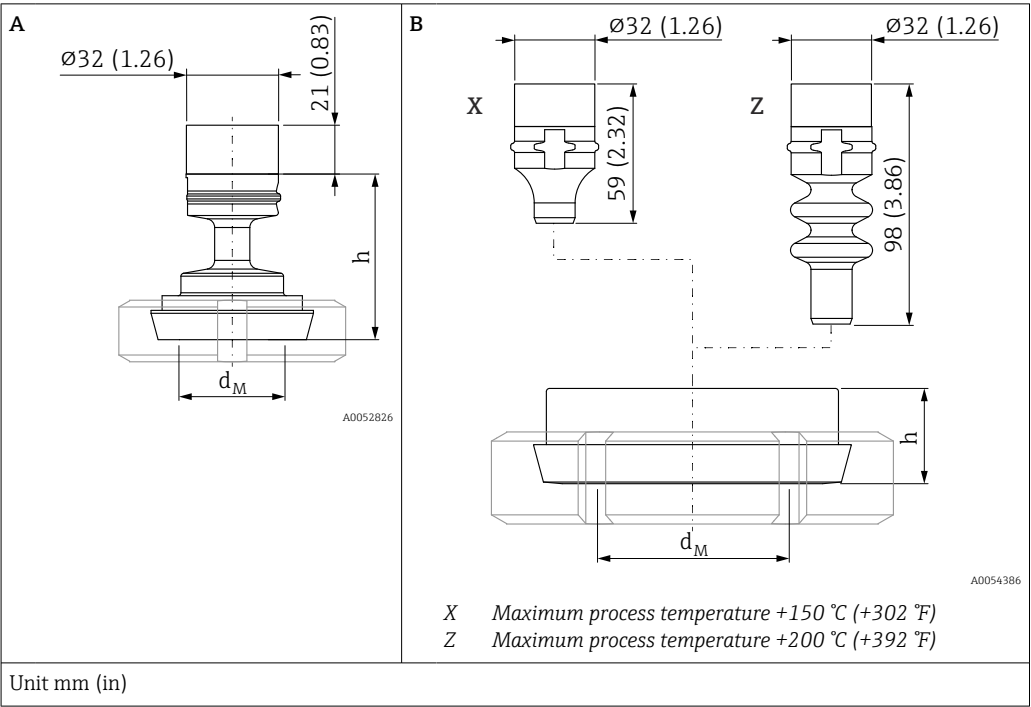

Designation	PN	Graphic	d _M	h	Weight kg	Order option
	[bar]		[mm (in)]	[mm (in)]	[kg (lb)]	
DIN11851 DN25	40	A	22 (0.87)	44 (1.73)	0.43 (0.95)	1GJ
DIN11851 DN32	40	A	32 (1.26)	57 (2.24)	0.55 (1.21)	1HJ
DIN11851 DN40	40	A	36 (1.42)	57 (2.24)	0.61 (1.35)	1JJ
DIN11851 DN50	25	A		57 (2.24)	0.76 (1.68)	1DJ
DIN11851 DN80	25	B	61 (2.4)	30 (1.18)	1.9 (4.19)	1FJ

Clamp ISO2852 DN18-22, DIN32676 DN15-20, flush membrane

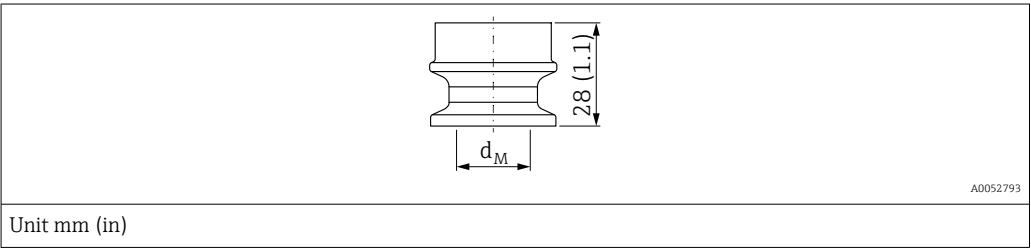

Designation	PN	d _M	Weight	Order option
	[bar]	[mm (in)]	[kg (lbs)]	
Clamp ISO2852 DN18-22, DIN32676 DN15-20,	40	17.2 (0.68)	0.09 (0.20)	3AJ

Tri-Clamp ISO2852, flush membrane

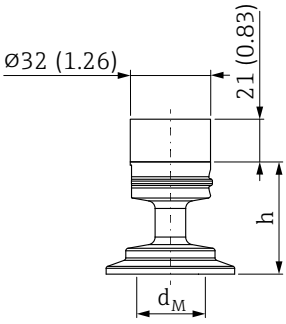
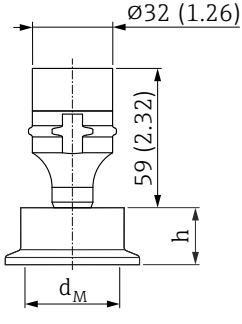
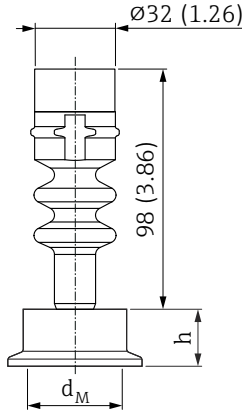
A  <p style="text-align: right;">A0052834</p>	B  <p style="text-align: right;">A0055939</p>	C  <p style="text-align: right;">A0055940</p>
Unit mm (in)		

Maximum process temperature +130 °C (+266 °F) (+150 °C (+302 °F) for 1 hour)

Maximum process temperature +150 °C (+302 °F)

Designation	PN	Surface	Graphic	d _M	h	Weight	Order option	
	[bar]			[mm (in)]	[mm (in)]	[kg (lb)]		
Tri-Clamp ISO2852 DN25 (1")	40	Standard	A	22 (0.87)	44 (1.73)	0.21 (0.46)	3BJ	
		Electropolished	A					
Tri-Clamp ISO2852 DN38 (1 ½")		Standard	A	32 (1.26)		0.21 (0.46)	3CJ	
		Electropolished	A					
Tri-Clamp ISO2852 DN51 (2")		Standard	A	36 (1.42)		0.26 (0.57)	3EJ	
		Electropolished	A					
Tri-Clamp ISO2852 DN63.5 (2 ½")		Standard	A	36 (1.42)		0.33 (0.73)	3JJ	
		Electropolished	B	61 (2.4)				30 (1.18)
Tri-Clamp ISO2852 DN76.1 (3")		Standard	A	36 (1.42)		44 (1.73)	0.42 (0.93)	3FJ
		Electropolished	B	61 (2.4)		30 (1.18)		

Maximum process temperature +200 °C (+392 °F)

Designation	PN	Surface	Graphic	d _M	h	Weight	Order option
	[bar]			[mm (in)]	[mm (in)]	[kg (lb)]	
Tri-Clamp ISO2852 DN25 (1")	40	Standard	C	22 (0.87)	30 (1.18)	0.32 (0.71)	3BJ
		Electropolished	C	22 (0.87)			
Tri-Clamp ISO2852 DN38 (1 ½")		Standard	C	36 (1.42)		1 (2.21)	3CJ
		Electropolished	C	36 (1.42)			
Tri-Clamp ISO2852 DN51 (2")		Standard	C	41 (1.61)		1.1 (2.43)	3EJ
		Electropolished	C	41 (1.61)			
Tri-Clamp ISO2852 DN63.5 (2 ½")		Standard	C	61 (2.4)		0.7 (1.54)	3JJ
Tri-Clamp ISO2852 DN76.1 (3")		Standard	C	61 (2.4)		1.2 (2.65)	3FJ

Varivent, flush membrane

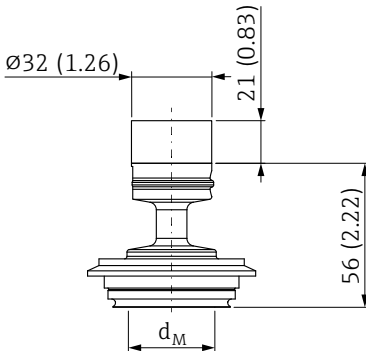
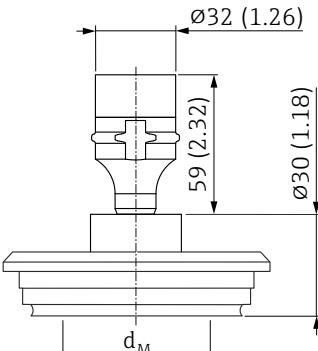
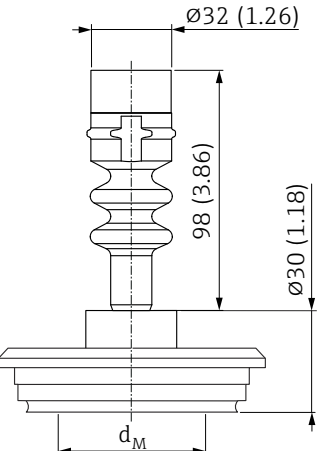
<p>A</p>  <p>A0052833</p>	<p>B</p>  <p>A0056131</p>	<p>C</p>  <p>A0056132</p>
Unit mm (in)		

Maximum process temperature +130 °C (+266 °F) (+150 °C (+302 °F) for 1 hour) Maximum process temperature +150 °C (+302 °F)						
Designation	PN	Surface	Graphic	d _M	Weight	Order option
	[bar]			[mm (in)]	[kg (lb)]	
Varivent F for DN25 - DN32 pipes	40	Standard	A	36 (1.42)	0.47 (1.04)	41J
		Electropolished	B		0.7 (1.54)	
Varivent N for DN40 - DN162 pipes		Standard	A	61 (2.4)	0.74 (1.63)	42J
		Electropolished	B		0.9 (1.98)	

Maximum process temperature +200 °C (+392 °F)					
Designation	PN	Graphic	d _M	Weight	Order option
	[bar]		[mm (in)]	[kg (lb)]	
Varivent F for DN25 - DN32 pipes	40	C	36 (1.42)	0.4 (0.88)	41J
Varivent N for DN40 - DN162 pipes		C	61 (2.4)	0.8 (1.76)	42J

DRD, flush membrane

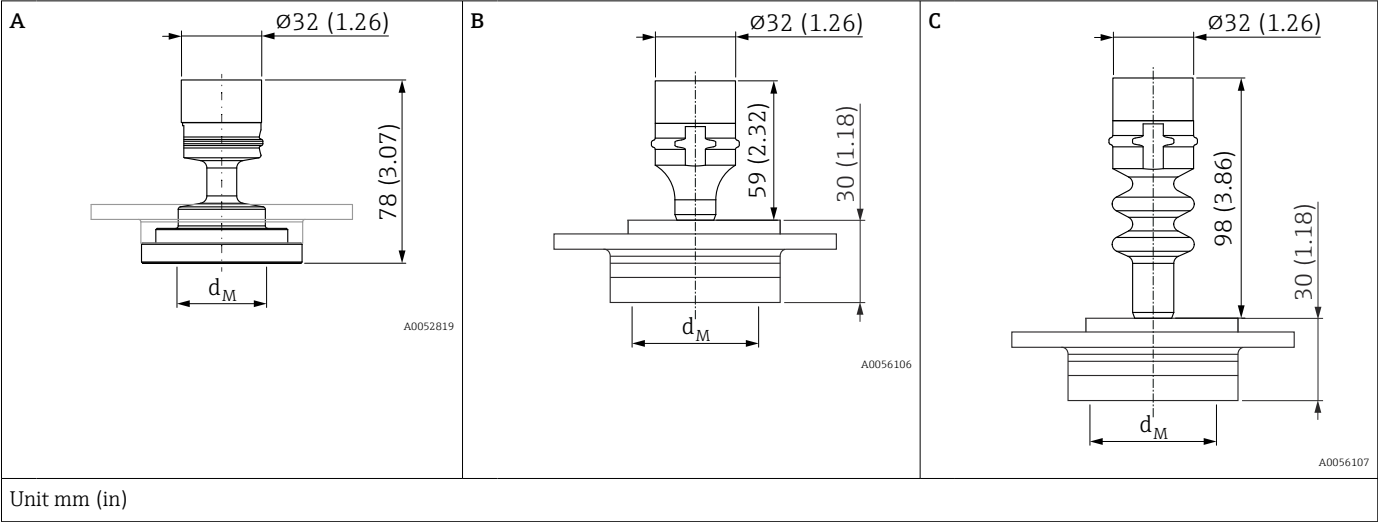

Maximum process temperature +130 °C (+266 °F)(+150 °C (+302 °F) for 1 hour)						
Maximum process temperature +150 °C (+302 °F)						
Designation	PN	Surface	Graphic	d _M	Weight kg	Order option
	[bar]			[mm (in)]	[kg (lb)]	
DRD 65 mm	25	Standard	A	36 (1.42)	0.48 (1.06)	4AJ
		Electropolished	B	48 (1.89)	0.65 (1.43)	

Maximum process temperature +200 °C (+392 °F)						
Designation	PN	Surface	Graphic	d _M	Weight kg	Order option
	[bar]			[mm (in)]	[kg (lb)]	
DRD 65 mm	25	Standard	C	48 (1.89)	0.75 (1.65)	4AJ
		Electropolished	C			

SMS, flush membrane

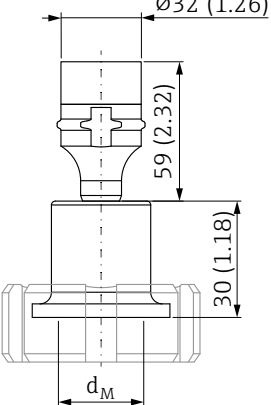
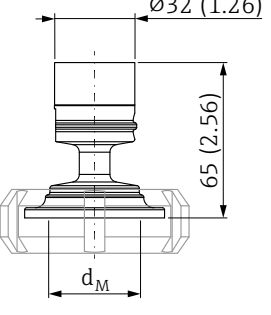
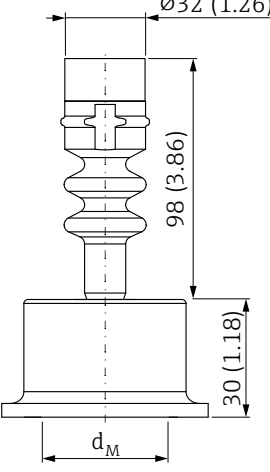
<p>A</p>  <p>A0054360</p>	<p>B</p>  <p>A0052821</p>	<p>C</p>  <p>A0052820</p>
Unit mm (in)		

Maximum process temperature +130 °C (+266 °F)(+150 °C (+302 °F) for 1 hour)
Maximum process temperature +150 °C (+302 °F)

Designation	PN	Graphic	d _M	Weight	Order option
	[bar]		[mm] (in)	[kg (lb)]	
SMS 1	40	A	22 (0.87)	0.13 (0.29)	4PJ
SMS 1 1/2		B	36 (1.42)	0.25 (0.55)	4QJ
SMS 2		B		0.32 (0.71)	4RJ

Maximum process temperature +200 °C (+392 °F)

Designation	PN	Graphic	d _M	Weight	Order option
	[bar]		[mm] (in)	[kg (lb)]	
SMS 1	40	C	22 (0.87)	0.25 (0.55)	T6J
SMS 1 1/2		C	36 (1.42)	0.65 (1.43)	T7J
SMS 2		C	48 (1.89)	1.05 (2.32)	TXJ

NEUMO BioControl, flush membrane

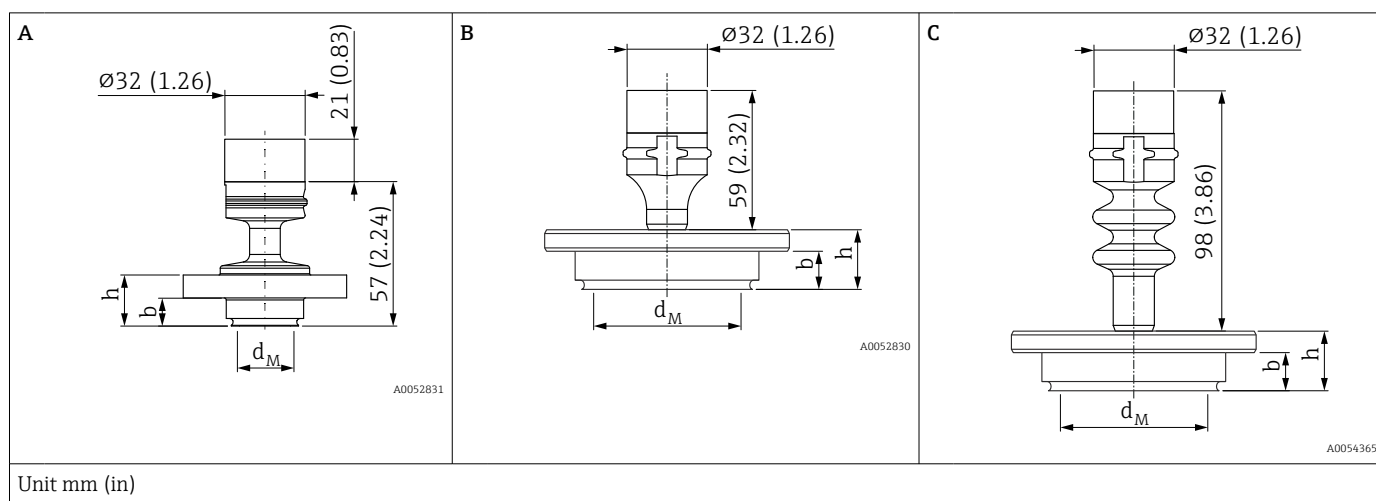

Maximum process temperature +130 °C (+266 °F) (+150 °C (+302 °F) for 1 hour)

Maximum process temperature +150 °C (+302 °F)

Designation	PN	Surface	Graphic	b	h	d_M	Weight	Order option
	[bar]			[mm (in)]	[mm (in)]		[kg (lb)]	
NEUMO BioControl D25	16	Standard	A	11 (0.43)	20 (0.79)	22 (0.87)	0.41 (16.1)	5AJ
		Electropolished	B				0.6 (1.32)	
NEUMO BioControl D50	16	Standard	A	17 (0.67)	27 (1.06)	36 (1.42)	0.86 (1.90)	5DJ
		Electropolished	B			41 (1.61)	1.1 (2.43)	
NEUMO BioControl D80	16	Standard	B	25 (0.98)	37 (1.46)	61 (2.4)	2.59 (5.71)	5FJ
		Electropolished	B					

Maximum process temperature +200 °C (+392 °F)

Designation	PN	Graphic	b	h	d_M	Weight	Order option
	[bar]		[mm (in)]	[mm (in)]		[kg (lb)]	
NEUMO BioControl D80	16	C	25 (0.98)	37 (1.46)	61 (2.4)	2.8 (6.17)	5FJ

Ingold connection 25x46, flush membrane

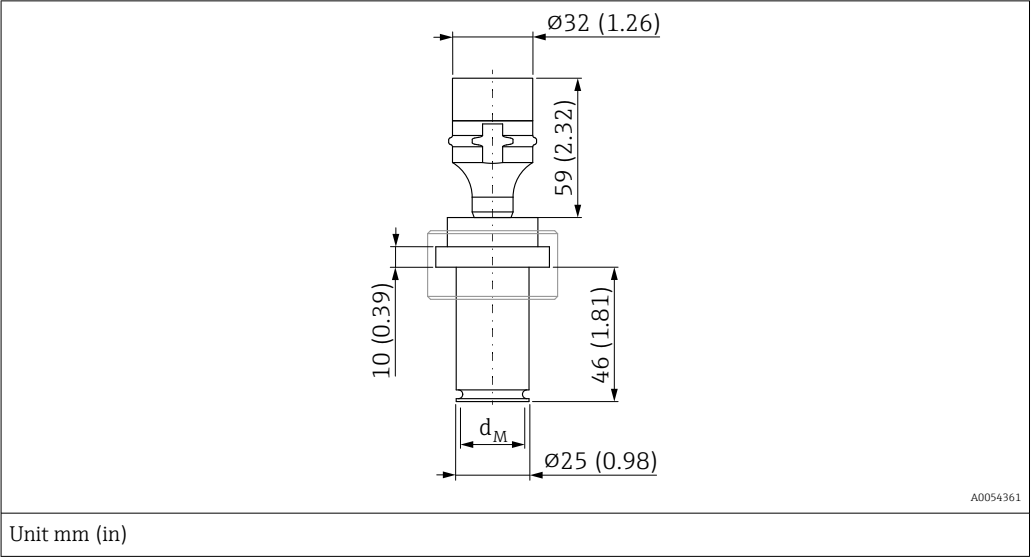

Designation	PN	d _M	Weight	Order option
	[bar]	[mm (in)]	[kg (lb)]	
Ingold connection 25x46 with O-ring made from EPDM	25	22 (0.87)	0.3 (0.66)	5RJ

Universal adapter, flush membrane

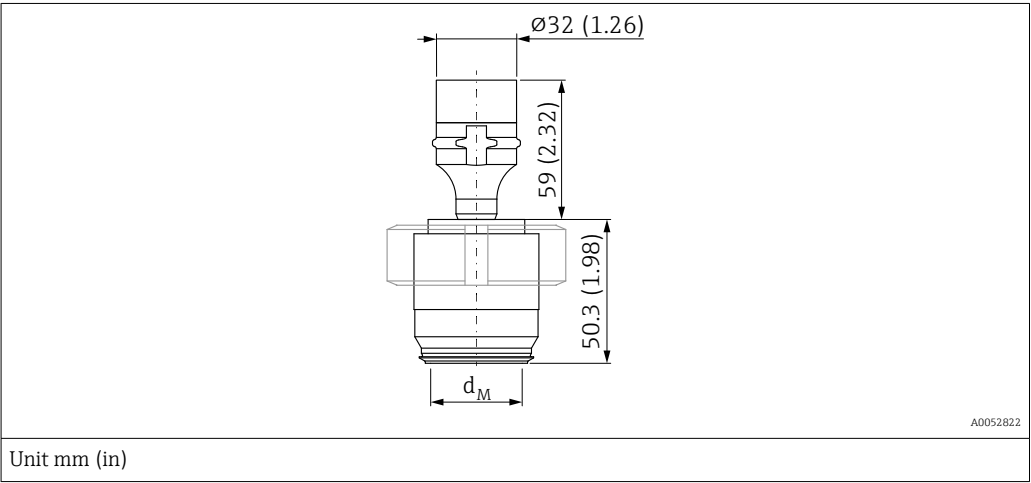

Designation	Seal	PN	d _M	Weight	Order option
		[bar]	[mm (in)]	[kg (lb)]	
Universal adapter	Silicone form seal	10	32 (1.26)	0.54 (1.19)	52J
	EPDM form seal				50J

Tri-Clamp ISO2852 inline seal, flush membrane

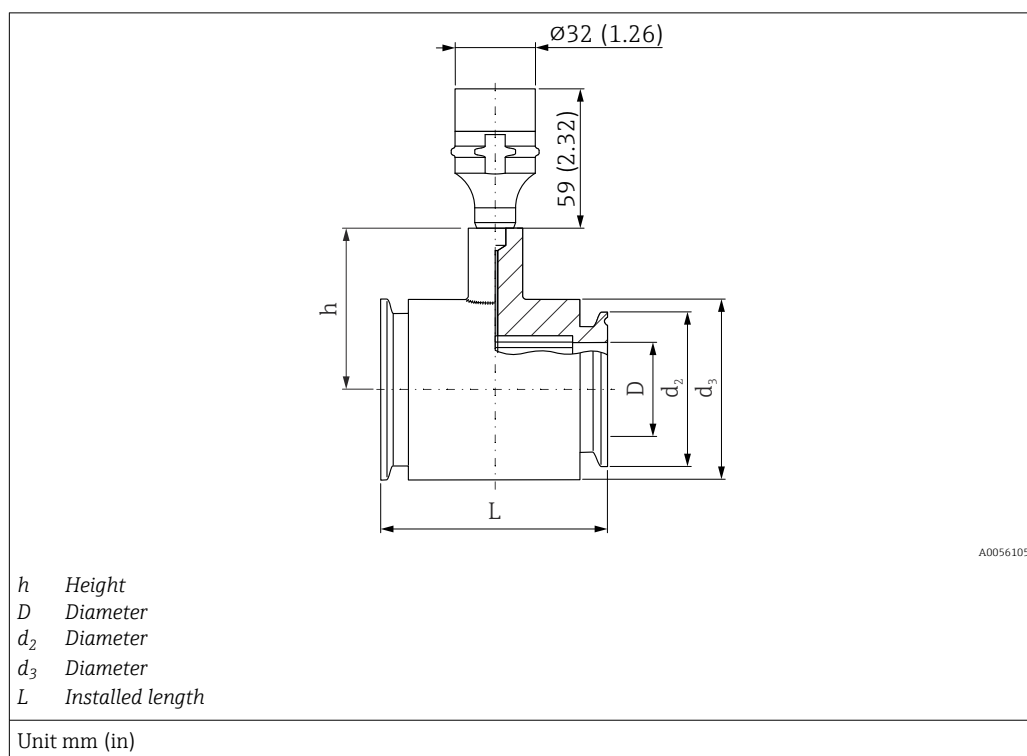

DN	NPS	PN	D	d ₂	d ₃	h	L	Weight	Order option
	[in]	[bar]	[mm]	[mm]	[mm]	[mm]	[mm]	[kg (lb)]	
10	¾	40	10.5	25	34	41.5	140	0.6 (1.32)	3QJ
25	1		22.5	50.5	54	67	126	1.7 (3.75)	3RJ
38	1 ½		35.5	50.5	69	67	126	1.0 (2.21)	3SJ ¹⁾
51	2		48.6	64	78	79	100	1.7 (3.75)	3TJ ¹⁾

1) incl. 3.1 and pressure test in accordance with the Pressure Equipment Directive, category II



Perform CIP (cleaning in place (hot water)) before SIP (sterilization in place (steam)). Frequent use of SIP cleaning increases the stress and strain on the process membrane. Under unfavorable conditions, frequent changes of temperature can lead to process membrane material fatigue and potentially leaks over the long term.

Flange EN1092-1, flush membrane

Connection dimensions according to EN1092-1

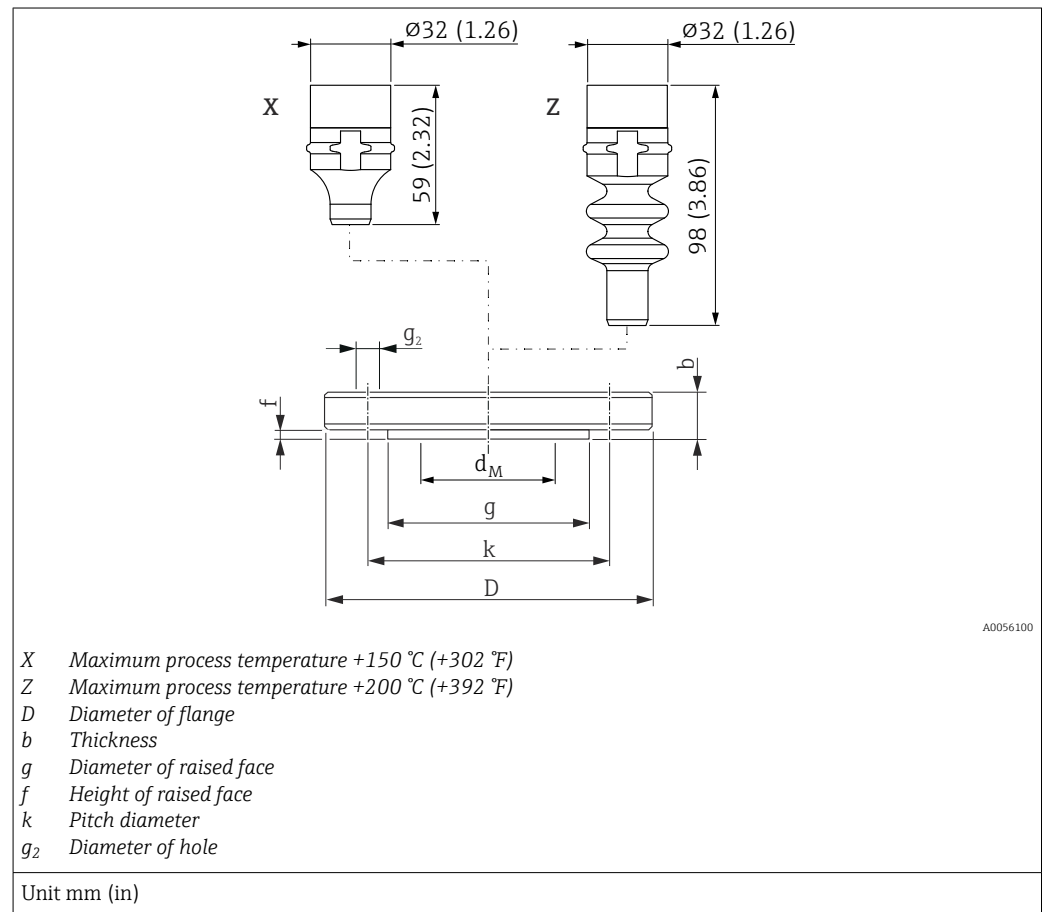

A0056100

Flange								Order option
DN	PN	Form	D	b	g	f	Ød _M	
			[mm]	[mm]	[mm]	[mm]	[mm]	
25	10-40	B1	115	18	68	3	28	H0J
40	10-40	B1	150	18	87		-	E1J
50	10-40	B1	165	20	102		61	H3J
80	10-40	B1	200	24	138		89	H5J

Flange		Boltholes			Weight	Order option
DN	PN	Quantity	g ₂	k		
			[mm]	[mm]	[kg (lb)]	
25	10-40	4	14	85	2.1 (4.63)	H0J
40	10-40	4	18	110	2.2 (4.85)	E1J
50	10-40	4	18	125	3.0 (6.62)	H3J
80	10-40	8	18	160	5.3 (11.69)	H5J

Flange ASME, flush membrane

Connection dimensions in accordance with ASME B 16.5, raised face RF

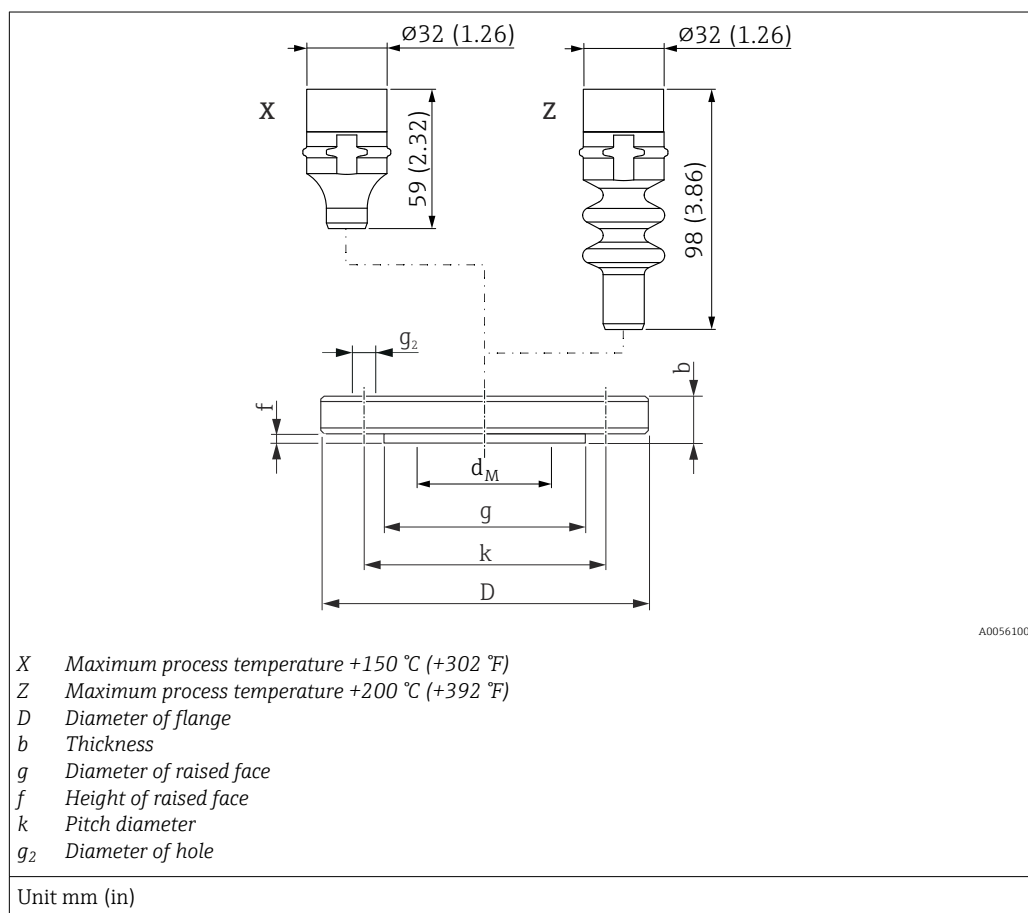

Flange							Order option
NPS	Class	D	b	g	f	Ød _M	
[in]	[lb./sq.in]	[in]	[in]	[in]	[in]	[in]	
1	150	4.25	0.56	2	0.06	1.10	AAJ
1 ½	150	5	0.69	2.88		On request	ACJ
2	150	6	0.75	3.62		2.40	ADJ
3	150	7.5	0.94	5		3.50	AFJ

Flange		Boltholes			Weight	Order option
NPS	Class	Quantity	g ₂	k		
[in]	[lb./sq.in]		[in]	[in]	[kg (lb)]	
1	150	4	0.62	3.12	1.2 (2.65)	AAJ
1 ½	150	4	0.62	3.88	1.5 (3.31)	ACJ
2	150	4	0.75	4.75	2.2 (4.85)	ADJ
3	150	4	0.75	6	5.1 (11.25)	AFJ

Weight



The weights of the individual components must be added together for the total weight.

Housing weight including electronics and onsite display: 0.43 kg (0.95 lb)

Process connection: See the relevant process connection for weight

Materials

Materials in contact with process

Process connections

- EN flanges:
 - Material: AISI 316L
 - The flange raised face is made of the same material as the membrane.
- ASME flanges:
 - Material AISI 316/316L: Combination of AISI 316 for required pressure resistance and AISI 316L for required chemical resistance (dual rated)
 - The flange raised face is made of the same material as the membrane.
- All other process connections made of 316L

Membrane material

- 316L (1.4435)
 - AlloyC276
- The material of the flange raised face is the same as the material as the membrane.

Delta ferrite content

A delta ferrite content of $\leq 3\%$ can be guaranteed and certified for the wetted parts if option "KD" is selected in the "Test, certificate, declaration" order code in the Product Configurator.

Materials not in contact with process

- Housing: 316L (1.4404)
- Display: Polycarbonate
- Device plug: For more information, see section on "Power supply".

Fill fluid

- Synthetic oil as per FDA 21 CFR 178.3620 (b)(1) and NSF H-1
- Vegetable oil, FDA 21 CFR 172.856

Accessories



For technical data (e.g. materials, dimensions or order numbers), see the accessory document SD01553P.

Surface roughness

- Housing: $R_a < 1.6 \mu\text{m}$ ($63 \mu\text{in}$), electropolished
- Wetted parts: $R_a < 0.76 \mu\text{m}$ ($29.9 \mu\text{in}$) (excluding flanges and threaded process connections)
- Parts in contact with process: hygienic $R_a < 0.38 \mu\text{m}$ ($15 \mu\text{in}$) electropolished (Product feature "Surface refinement", order option "E")

User interface

Languages

Operating languages

- English (English is set at the factory if no other language is ordered)
- Deutsch
- Français
- Español
- Italiano
- Nederlands
- Portuguesa
- Polski
- русский язык (Russian)
- Türkçe

- 中文 (Chinese)
- 日本語 (Japanese)
- 한국어 (Korean)
- tiếng Việt (Vietnamese)
- čeština (Czech)
- Svenska

The IODD is available in English.

LED indicator

Functions:

- Display of the operating status (operation or fault)
- Display of Bluetooth connection, locking status and function
- Easy setup of the following functions with one button:
 - Locking On/Off
 - Bluetooth On/Off
 - Position adjustment

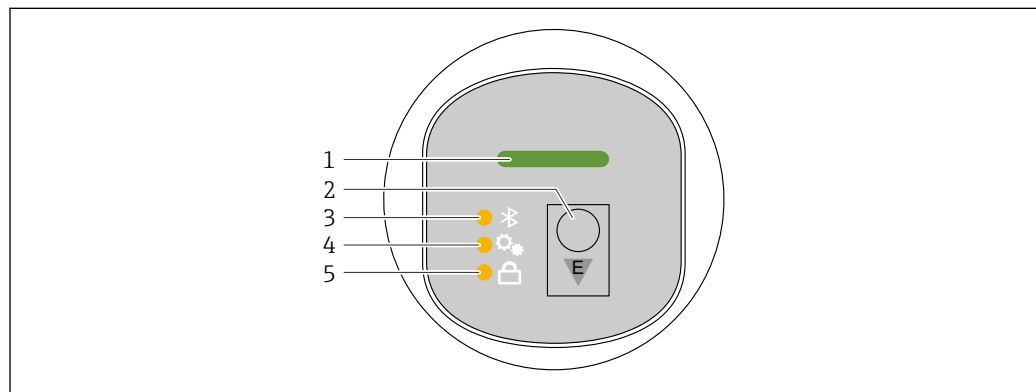

A0052426

- 1 Operating status LED
- 2 Operating key "E"
- 3 Bluetooth LED
- 4 Position adjustment LED
- 5 Keypad lock LED

Onsite display

Functions:

- Display measured values and fault and notice messages
- Display a symbol in the event of an error
- Electronically adjustable onsite display (automatic or manual adjustment of display in 90° increments)
 - i** The measured value display rotates automatically depending on the orientation when the device is started. ³⁾
- Basic settings via the onsite display with touch control ⁴⁾
 - Locking On/Off
 - Select the operating language
 - Start Heartbeat Verification with passed/failed feedback message on the onsite display
 - Bluetooth On/Off
 - Commissioning wizard for basic settings
 - Read the device information, such as the name, serial number and firmware version
 - Active diagnostics and status
 - Device reset
 - Invert colors for bright lighting conditions

i The following figure is an example. The display depends on the settings of the onsite display.

³⁾ The measured value display only rotates automatically if automatic alignment is switched on.

⁴⁾ In devices without touch control, settings can be made using operating tools (FieldCare, DeviceCare, SmartBlue).

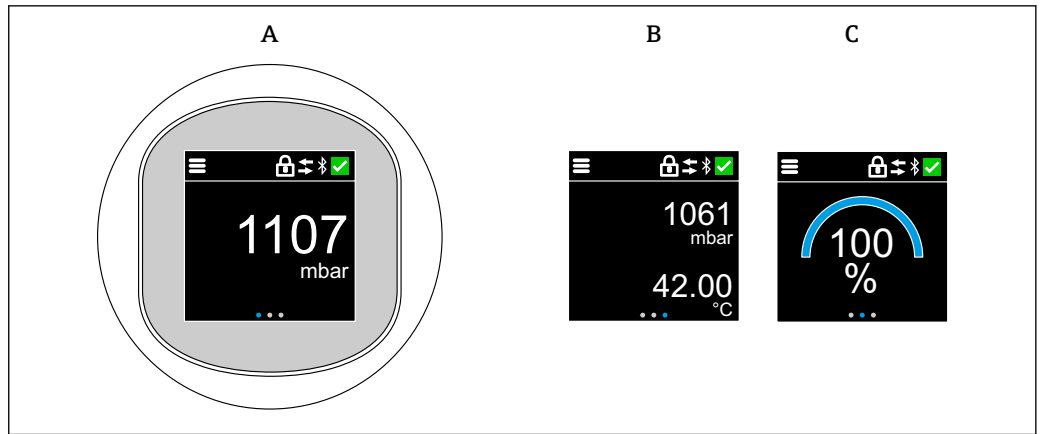

A0053054

- A Standard display: 1 measured value with unit (adjustable)
 B 2 measured values, each with unit (adjustable)
 C Graphic measured value display in %

The default display can be permanently set via the operating menu.

Remote operation

Via IO-Link or Bluetooth

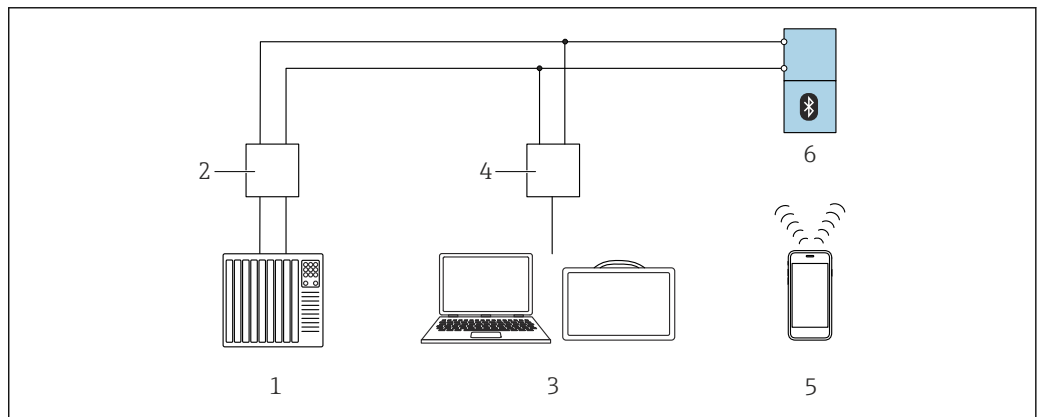

A0053130

4 Options for remote operation via IO-Link

- 1 PLC (programmable logic controller)
- 2 IO-Link master
- 3 Computer with operating tool e.g. DeviceCare/FieldCare)
- 4 FieldPort SFP20
- 5 Smartphone or tablet with SmartBlue app
- 6 Transmitter

Operation via Bluetooth® wireless technology (optional)

Prerequisite

- Device with Bluetooth order option
- Smartphone or tablet with Endress+Hauser SmartBlue app or PC with DeviceCare from version 1.07.07 or FieldXpert SMT70/SMT77

The connection has a range of up to 25 m (82 ft). The range can vary depending on environmental conditions such as attachments, walls or ceilings.

 The operating keys on the display are locked as soon as the device is connected via Bluetooth.

System integration

- IO-Link V1.1.
- Smart Sensor Profile type 4.3
- SIO: Yes
- Speed: COM2; 38.4 kBaud

- Process data width:  See Operating Instructions
- Data storage: Yes
- Block configuration: Yes

Supported operating tools	Smartphone or tablet with Endress+Hauser SmartBlue app, DeviceCare from version 1.07.07, FieldCare.
----------------------------------	---

Certificates and approvals



Current certificates and approvals for the product are available at www.endress.com on the relevant product page:

1. Select the product using the filters and search field.
2. Open the product page.
3. Select **Downloads**.

Other certificates and approvals for the product are available under <https://www.endress.com>-> Downloads.

Material compliance for contact with food	<p>The device has been developed for food contact applications. Versions can be selected that meet the following requirements:</p> <ul style="list-style-type: none"> ■ EU Food Contact Material (EC) 1935/2004 ■ US Food Contact Material FDA CFR 21 ■ CN Food Contact Material GB 4806
--	---

General material compliance	<p>Endress+Hauser guarantees compliance with all relevant laws and regulations, including the current guidelines for materials and substances.</p> <p>Examples:</p> <ul style="list-style-type: none"> ■ RoHS ■ China RoHS ■ REACH ■ POP VO (Stockholm Convention) <p>For further information and general declarations of compliance, see the Endress+Hauser website www.endress.com</p>
------------------------------------	---

Hygienic design compliance	<p>3-A and EHEDG-certified versions of the sensor are suitable for Cleaning-in-Place (CIP) and Sterilization-in-Place (SIP) without removing them from the plant. This means that the sensor does not need to be removed during cleaning. The maximum permitted pressure and temperature values for sensor and adapter must not be exceeded (see notes in this TI).</p> <ul style="list-style-type: none"> ■ Notes on installation and certification in accordance with 3-A and EHEDG: <ul style="list-style-type: none">  SD02503F document "Hygienic approvals" ■ Information on 3-A and EHEDG-certified adapters: <ul style="list-style-type: none">  TI00426F document "Weld-in adapters, process adapters and flanges"
-----------------------------------	---

cGMP	<p>The device was developed for life sciences applications. You can select versions with a cGMP declaration (Current Good Manufacturing Practice) for process-wetted parts with the following content in English:</p> <ul style="list-style-type: none"> ■ Materials of construction ■ Polishing and surface treatment ■ Materials and compounds compliance table: USP, FDA ■ TSE/BSE-compliant based on EMA/410/01 Rev.3
-------------	---

TSE (BSE) compliance (ADI free - Animal Derived Ingredients)	<p>Versions can be selected that meet the following requirements:</p> <ul style="list-style-type: none"> ■ The parts of this product in contact with the process are not made from materials derived from animals or ■ The parts of this product in contact with the process correspond to at least the requirements of the EMA/410/01 Rev. 3 guideline (TSE (BSE) compliant)
---	--

ASME BPE	The measuring system was developed for life sciences applications. Options can be selected that meet the requirements of the ASME BPE (Bioprocessing Equipment) standard.
-----------------	---

Drinking water certification	<p>The following drinking water certificates can be ordered as options via the Product Configurator:</p> <ul style="list-style-type: none"> ■ For Germany: UBA assessment criteria ■ For USA/Canada: NSF/ANSI/CAN 61
CRN approval	<p>Device versions with a CRN approval (Canadian Registration Number) are listed in the corresponding registration documents. CRN-approved devices are marked with a registration number.</p> <p>Any restrictions regarding the maximum process pressure values are listed on the CRN certificate.</p> <p> Product Configurator: feature "Additional approval"</p>
ASME B31.3/31.1	<p>Versions can be selected that meet the following requirements:</p> <p>The design, the material used, the pressure and temperature ranges and the labeling of the devices meet the requirements of ASME B31.1 (piping for power plants) and/or ASME B31.3 (process piping).</p>
Test, certificate, declaration	<p>All test reports, declarations and inspection certificates are provided electronically in the <i>Device Viewer</i>:</p> <p>Enter the serial number from the nameplate</p> <p>(https://www.endress.com/de/pages/supporting-tools/device-viewer)</p>
Pressure Equipment Directive (PED)	<p>Pressure equipment with permitted pressure ≤ 200 bar (2 900 psi)</p> <p>Pressure equipment (maximum working pressure $PS \leq 200$ bar (2 900 psi)) can be classified as pressure accessories in accordance with the Pressure Equipment Directive. If the maximum working pressure is ≤ 200 bar (2 900 psi) and the pressurized volume of the pressure equipment is ≤ 0.1 l, the pressure equipment is subject to the Pressure Equipment Directive (see Pressure Equipment Directive 2014/68/EU, Article 4, point 3). The Pressure Equipment Directive only requires that the pressure equipment shall be designed and manufactured in accordance with the "sound engineering practice of a Member State".</p> <p><i>Reasons:</i></p> <ul style="list-style-type: none"> ■ Pressure Equipment Directive (PED) 2014/68/EU Article 4, point 3 ■ Pressure Equipment Directive 2014/68/EU, Commission's Working Group "Pressure", Guideline A-05 + A-06 <p><i>Note:</i></p> <p>A partial examination shall be performed for sensors that are part of a safety instrumented system for the protection of a pipe or vessel from exceeding allowable limits (equipment with safety function in accordance with Pressure Equipment Directive 2014/68/EU, Article 2, point 4).</p> <p><i>The following also applies:</i></p> <p>Devices with an inline seal ≥ 1.5"/PN40: suitable for stable gases in group 1, category II, module A2</p>

Order information

Detailed ordering information is available from your nearest sales organization www.addresses.endress.com or in the Product Configurator at www.endress.com:

1. Select the product using the filters and search field.
2. Open the product page.
3. Select **Configuration**.



Product Configurator - the tool for individual product configuration

- Up-to-the-minute configuration data
- Depending on the device: direct input of information specific to the measuring point, such as the measuring range or operating language
- Automatic verification of exclusion criteria
- Automatic creation of the order code and its breakdown in PDF or Excel output format
- Ability to order directly in the Endress+Hauser Online Shop

Identification	<p>Measuring point (TAG)</p> <p>The device can be ordered with a tag name.</p> <p>Location of tag name Select in the additional specification:</p> <ul style="list-style-type: none"> ■ Stainless steel wired-on tag plate ■ Paper adhesive label ■ Tag provided by the customer ■ Nameplate ■ IEC 61406 stainless steel tag ■ IEC 61406 stainless steel + NFC tag ■ IEC 61406 stainless steel, stainless steel tag ■ IEC 61406 stainless steel + NFC, stainless steel ■ IEC 61406 stainless steel tag, plate provided ■ IEC 61406 stainless steel + NFC, plate provided <p>Definition of tag name Specify in the additional specification: 3 lines of maximum 18 characters each The specified tag name appears on the selected plate.</p> <p>Visualization in SmartBlue app The first 32 characters of the tag name The tag name can always be changed specifically for the measuring point via Bluetooth.</p> <p>Display on the nameplate The first 16 characters of the tag name</p> <p>Display in electronic nameplate (ENP) The first 32 characters of the tag name</p> <p> For details, see document SD03128P</p>
Service	<p>The following services, among others, can be selected using the Product Configurator.</p> <ul style="list-style-type: none"> ■ Cleaned of oil+grease (wetted) ■ Set HART burst mode PV ■ Set max. alarm current ■ Bluetooth communication is disabled on delivery ■ Customized empty/full calibration ■ Product documentation on paper <p>A printed (hard copy) version of test reports, declarations and inspection certificates can optionally be ordered via the Service, Version, Product documentation on paper option. The required documents can be selected under the feature Test, certificate, declaration and are then included with the device on delivery.</p>

Application packages

The application package can be ordered together with the device or can be activated subsequently with an activation code. Detailed information on the relevant order code is available from the website www.endress.com or from the Endress +Hauser Sales Center.

Heartbeat Technology	<p>Heartbeat Technology offers diagnostic functionality through continuous self-monitoring, the transmission of additional measured variables to an external Condition Monitoring system and the in situ verification of devices in the application.</p> <p>Heartbeat Diagnostics</p> <p>Continuous self-monitoring of the device.</p> <p>Diagnostic messages output to:</p> <ul style="list-style-type: none"> ■ the onsite display ■ an asset management system (e.g. FieldCare or DeviceCare) ■ an automation system (e.g. PLC)
-----------------------------	--

Heartbeat Verification

- Monitoring of the installed device without interrupting the process, including a verification report
- Clear measuring point assessment (pass/fail) with high total test coverage as part of the manufacturer's specification
- Can be used to document normative requirements
- Meets the requirements for measurement traceability in accordance with ISO 9001 (ISO 9001:2015 Section 7.1.5.2)



The verification report can be generated via Bluetooth.

Heartbeat Monitoring

- Continuously provides device and/or process data for an external system. Analysis of this data provides a basis for process optimization and predictive maintenance.
- **Loop diagnostics** wizard: detection of elevated measuring circuit resistance values or declining power supply
- **Statistical Sensor Diagnostics** submenu: statistical analysis and evaluation of the pressure signal, including signal noise, to detect process anomalies
- **Process window** wizard: user-definable pressure and temperature limits to detect dynamic pressure surges or faulty trace heating systems or insulation
- **Safety mode** wizard: This wizard can be used to write-protect the device via software. The safety-relevant parameters must be confirmed in the wizard.

Detailed description



See Special Documentation for SD Heartbeat Technology.

Accessories

Device-specific accessories

M12 socket

M12 socket, straight

- Material:
Body: PA; union nut: stainless steel; seal: EPDM
- Degree of protection (fully locked): IP69
- Order number: 71638191

M12 socket, elbowed

- Material:
Body: PA; union nut: stainless steel; seal: EPDM
- Degree of protection (fully locked): IP69
- Order number: 71638253

Cables

Cable 4 x 0.34 mm² (20 AWG) with M12 socket, elbowed, screw plug, length 5 m (16 ft)

- Material: body: TPU; union nut: nickel-plated die-cast zinc; cable: PVC
- Degree of protection (fully locked): IP68/69
- Order number: 52010285
- Wire colors
 - 1 = BN = brown
 - 2 = WT = white
 - 3 = BU = blue
 - 4 = BK = black

Welding neck, process adapter and flange







For details, refer to TI00426F/00/EN "Weld-in adapters, process adapters and flanges".

Mechanical accessories



For technical data (e.g. materials, dimensions or order numbers), see the accessory document SD01553P.

DeviceCare SFE100	<p>Configuration tool for IO-Link, HART, PROFIBUS and FOUNDATION Fieldbusfield devices DeviceCare is available for download free of charge at www.software-products.endress.com. You need to register in the Endress+Hauser software portal to download the application.</p> <p> Technical Information TI01134S</p>
FieldCare SFE500	<p>FDT-based plant asset management tool It can configure all intelligent field units in your system and helps you manage them. By using the status information, it is also a simple but effective way of checking their status and condition.</p> <p> Technical Information TI00028S</p>
Device Viewer	<p>All the spare parts for the device, along with the order code, are listed in the <i>Device Viewer</i> (www.endress.com/deviceviewer).</p>
Field Xpert SMT70	<p>Universal, high-performance tablet PC for device configuration in Ex Zone 2 and non-Ex areas</p> <p> For details, see "Technical Information" TI01342S</p>
Field Xpert SMT77	<p>Universal, high-performance tablet PC for device configuration in Ex Zone 1 areas</p> <p> For details, see "Technical Information" TI01418S</p>
SmartBlue app	<p>Mobile app for easy configuration of devices on site via Bluetooth wireless technology</p>

Documentation

-  For an overview of the scope of the associated Technical Documentation, refer to the following:
- *Device Viewer* (www.endress.com/deviceviewer): Enter the serial number from the nameplate
 - *Endress+Hauser Operations app*: Enter serial number from nameplate or scan matrix code on nameplate.

Standard documentation	<p>Document type: Operating Instructions (BA) Installation and initial commissioning – contains all the functions in the operating menu that are needed for a routine measuring task. Functions beyond this scope are not included.</p> <p>Document type: Description of Device Parameters (GP) The document is part of the Operating Instructions and serves as a reference for parameters, providing a detailed explanation of each individual parameter of the operating menu.</p> <p>Document type: Brief Operating Instructions (KA) Quick guide to the first measured value – includes all essential information from incoming acceptance to electrical connection.</p> <p>Document type: Safety Instructions, certificates Depending on the approval, safety instructions are supplied with the device, e.g. XA. This documentation is an integral part of the Operating Instructions. Information on the Safety Instructions (XA) that are relevant for the device is provided on the nameplate.</p>
Supplementary device-dependent documentation	<p>Additional documents are supplied depending on the device version ordered: Always comply strictly with the instructions in the supplementary documentation. The supplementary documentation is an integral part of the device documentation.</p>

Registered trademarks

Apple®

Apple, the Apple logo, iPhone, and iPod touch are trademarks of Apple Inc., registered in the U.S. and other countries. App Store is a service mark of Apple Inc.

Android®

Android, Google Play and the Google Play logo are trademarks of Google Inc.

Bluetooth®

The *Bluetooth*® word mark and logos are registered trademarks owned by the Bluetooth SIG, Inc. and any use of such marks by Endress+Hauser is under license. Other trademarks and trade names are those of their respective owners.

IO-Link®

Is a registered trademark. It may only be used in conjunction with products and services by members of the IO-Link Community or by non-members who hold an appropriate license. For more detailed information on its use, refer to the rules of the IO-Link Community at: www.io.link.com.



www.addresses.endress.com
