

# Safety Instructions

## RIA16

ATEX, IECEx: Ex ib [ia Ga] IIC T6 Gb

Safety instructions for electrical apparatus in  
explosion-hazardous areas





# RIA16

## Table of contents

About this document .....	4
Associated documentation .....	4
Supplementary documentation .....	4
Manufacturer´s certificates .....	5
Manufacturer address .....	5
Safety instructions: .....	6
Safety instructions: Installation .....	7
Safety instructions: Specific conditions of use .....	7
Temperature tables .....	7
Electrical connection data .....	7

## About this document



This document has been translated into several languages. Legally determined is solely the English source text.

The document translated into EU languages is available:

- In the download area of the Endress+Hauser website:  
[www.endress.com](http://www.endress.com) -> Downloads -> Manuals and Datasheets -> Type: Ex Safety Instruction (XA) -> Text Search: ...
- In the Device Viewer: [www.endress.com](http://www.endress.com) -> Product tools -> Access device specific information -> Check device features



If not yet available, the document can be ordered.

## Associated documentation

This document is an integral part of the following Operating Instructions:

- Operating instructions: BA00280R
- Brief operating instructions: KA00279R
- Technical information: TI00144R

## Supplementary documentation

Explosion-protection brochure: CP00021Z/11

The Explosion-protection brochure is available:

- In the download area of the Endress+Hauser website:  
[www.endress.com](http://www.endress.com) -> Downloads -> Brochures and Catalogs -> Text Search: CP00021Z
- On the CD for devices with CD-based documentation

**Manufacturer's  
certificates****IECEX certificate**

Certificate number: KEM 10.0012X

Affixing the certificate number certifies conformity with the following standards (depending on the device version)

- IEC 60079-0 : 2017
- IEC 60079-11 : 2011

**ATEX certificate**

Certificate number: KEMA 08ATEX0023 X

**EU Declaration of Conformity**

Declaration number: EC\_00182

**UKCA certificate**

Certificate number: CML 21UKEX2994X

**UKCA Declaration of Conformity**

Declaration number: UK\_00399

**Manufacturer  
address**

Endress+Hauser Wetzer GmbH + Co. KG  
Obere Wank 1  
87484 Nesselwang, Germany

**Safety instructions:**

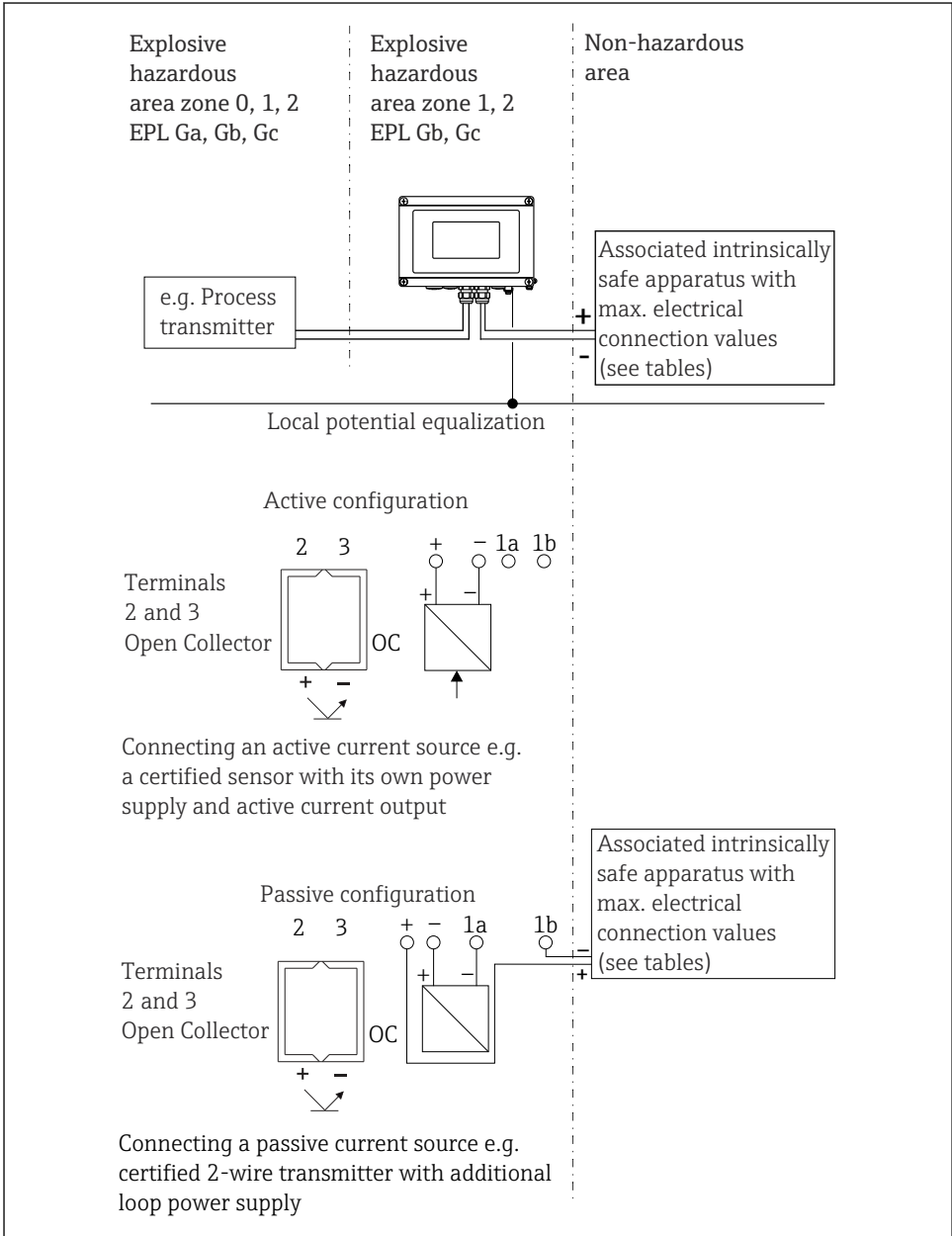

### Safety instructions: Installation

- Comply with the installation and safety instructions in the Operating Instructions.
- Install the device according to the manufacturer's instructions and any other valid standards and regulations (e.g. EN/IEC 60079-14).
- The indicator housing must be connected to the potential matching line.
- The type of protection changes as follows when the devices are connected to certified intrinsically safe circuits of Category ib: Ex ib IIC.
- When connecting an intrinsically safe ib circuit, do not operate the process transmitter at Zone 0.
- The indicator must be installed so, that even in the event of rare incidents, an ignition source due to impact or friction between the enclosure and iron/steel is excluded.
- The circuits of indicator are isolated from its enclosure in conformance with EN/IEC 60079-11 chapter 6.3.13.

### Safety instructions: Specific conditions of use

When the enclosure is provided with a non-conductive coating, electrostatic charges on the equipment enclosure shall be avoided. For more details see safety instructions.

### Temperature tables

Type	Temperature class	Ambient temperature
RIA16	T6	$-40\text{ °C} \leq T_a \leq +50\text{ °C}$
	T5	$-40\text{ °C} \leq T_a \leq +60\text{ °C}$
	T4	$-40\text{ °C} \leq T_a \leq +85\text{ °C}$

### Electrical connection data

Type	Electrical data	
RIA16	Power supply (Terminals + and -, + and 1b)	$U_i = 30\text{ V}_{DC}$ $I_i = 100\text{ mA}$ $P_i = 750\text{ mW}$ $L_i = 0\text{ mH}$ $C_i = 15.2\text{ nF}$
	Open Collector (Terminals 2 and 3)	$U_i = 30\text{ V}_{DC}$ $I_i = 100\text{ mA}$ $P_i = 375\text{ mW}$ $L_i = 0\text{ mH}$ $C_i = 0\text{ nF}$

Category	Type of protection (ATEX/IECEX)	Type
II2(1)G	Ex ib [ia] IIC T6...T4 Gb	RIA16



71578927

[www.addresses.endress.com](http://www.addresses.endress.com)

---