



Special Documentation

Weather protection cover for dual compartment housing

Accessories

Intended use

The weather protection cover is designed for the following types of housing:

- Dual compartment housing; plastic
- Dual compartment housing; aluminum
- Dual compartment housing; 316L

Safety instructions

⚠ WARNING

Hazardous area: Risk of explosion due to static charge on weather protection cover!

- ▶ Connect the weather protection cover to local potential equalization!

⚠ CAUTION

Risk of injury due to mechanical damage!

- ▶ Do not step or climb on the weather protection cover!

Scope of delivery

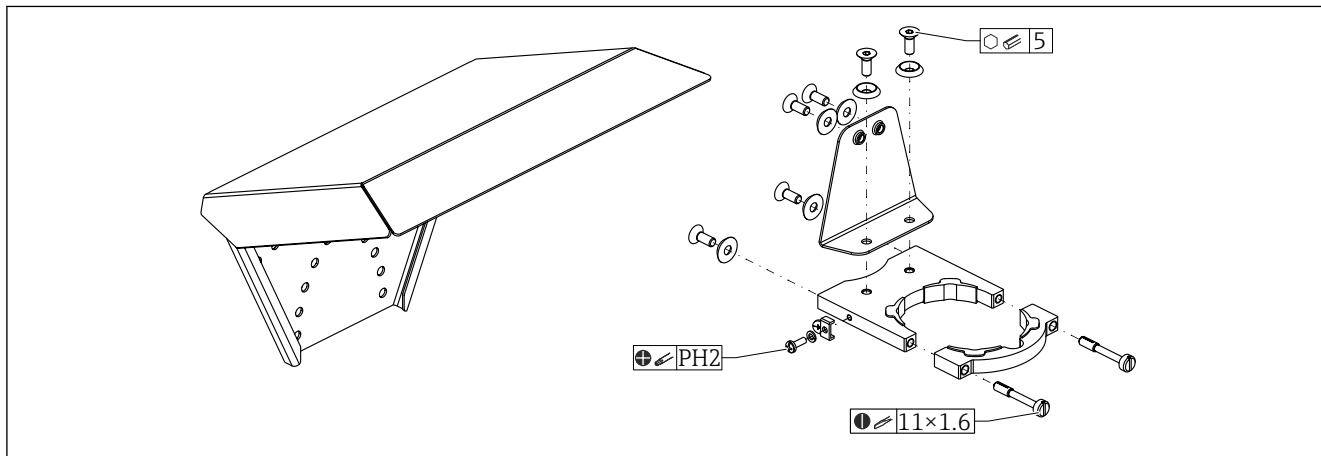

A0051672

Dimensions

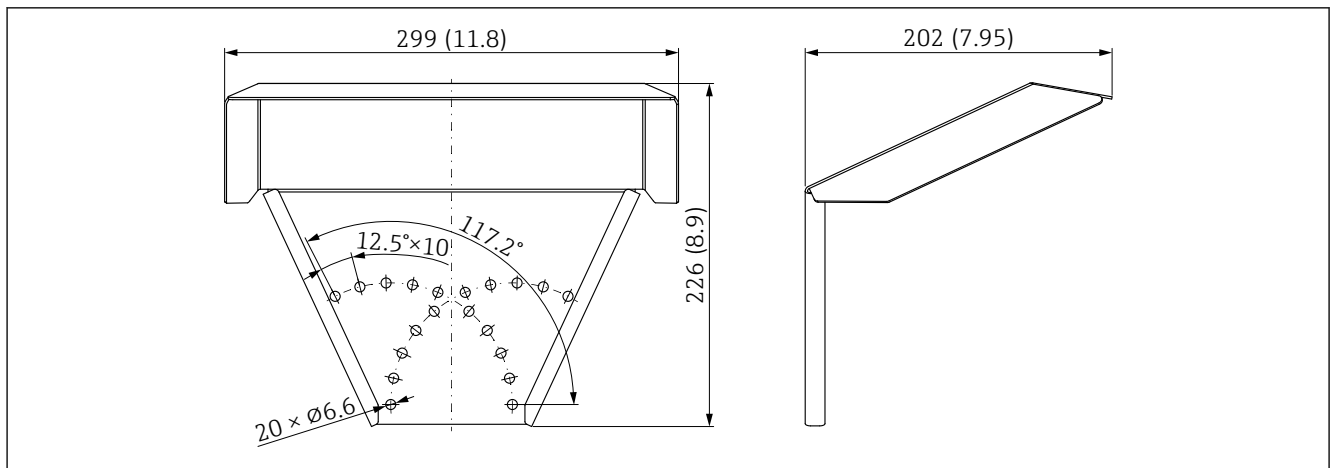

A0015472

Unit of measurement mm (in)

Mounting

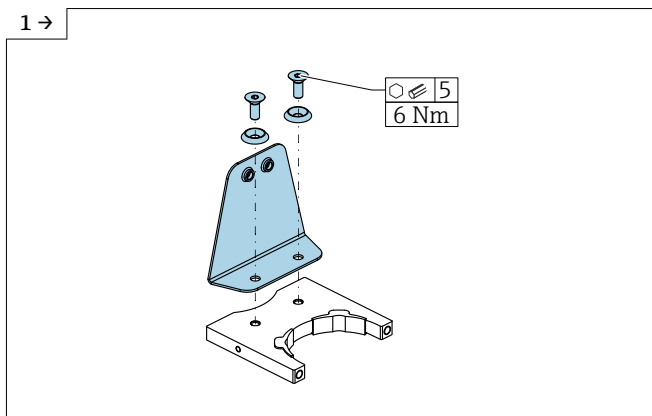

A0051801

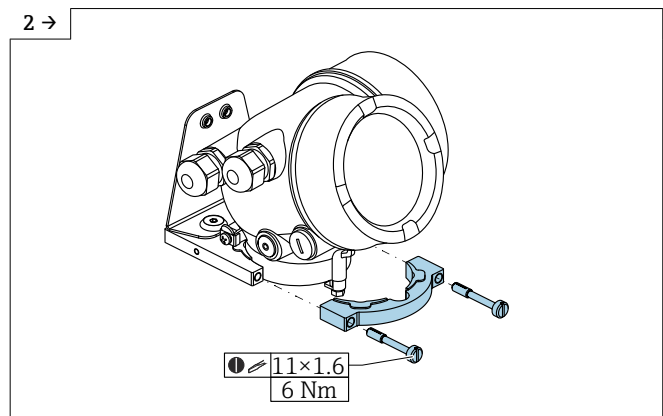

A0051802

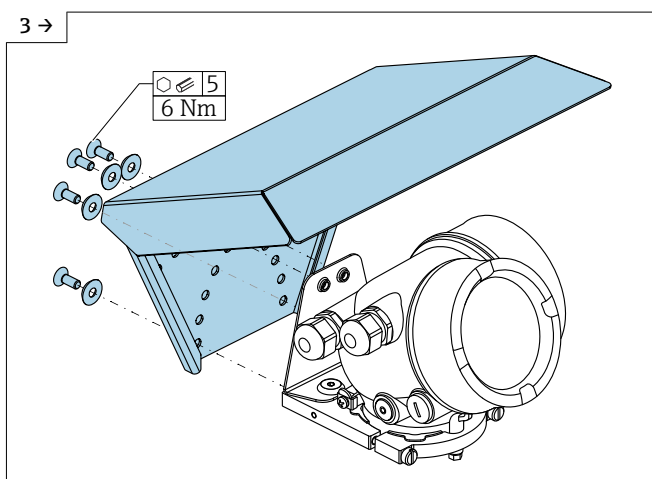

A0051803

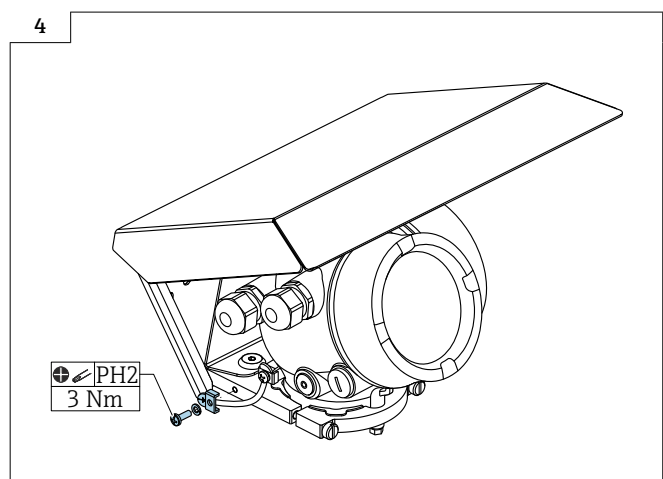

A0051804

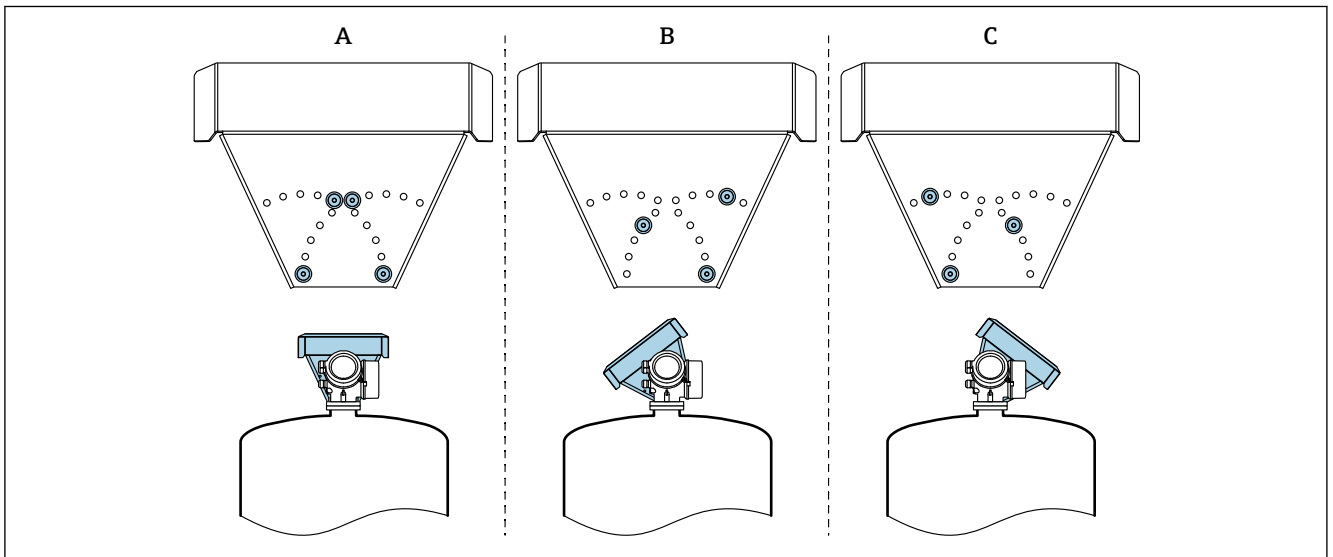

A0051817

- A Horizontal mounting, use 4 screws
B Maximum orientation to left, use 3 screws
C Maximum orientation to right, use 3 screws
