

Installation Instructions

Spare parts kits for Cleanfit CPA474 process retractable assemblies

Seals, in contact with medium



Table of contents

1 Spare parts kit 3

2 Intended use 3

3 Personnel authorized to carry out conversion 3

4 Safety instructions 3

5 Scope of delivery 4

6 Additional documentation 7

7 Replacing seals 7

8 Disposal 10

1 Spare parts kit

These installation instructions apply to the following spare parts kits:

No.	Description	Section
51518483	Seals for wetted parts, EPDM	→  4
51518484	Seals for wetted parts, FPM	
51518485	Seals for wetted parts, FFKM	

2 Intended use

- The parts in the kits must only be used as maintenance parts for the CPA474 process retractable assembly. Any other use is not permitted!
- Use only original parts from Endress+Hauser.
- In the W@M Device Viewer, check if the spare part is suitable for the existing device.

3 Personnel authorized to carry out conversion

- Installation, commissioning, operation and maintenance of the measuring system may be carried out only by specially trained technical personnel.
- The technical personnel must be authorized by the plant operator to perform the stated tasks.
- The electrical connection may only be established by an electrical technician.
- The technical personnel must have read and understood these Installation Instructions and must follow the instructions they contain.
- Measuring point faults may be repaired only by authorized and specially trained personnel.

 Repairs not described in the Operating Instructions provided must only be carried out directly at the manufacturer's site or by the service organization.

4 Safety instructions

WARNING

Risk of injury from high pressure, high temperature or chemical hazards if process medium escapes!

- ▶ Before installing or removing an assembly, depressurize the system, drain the system and clean it.

CAUTION**Risk to health due to contact with the process medium**

- ▶ Wear protective gloves, protective goggles and protective clothing, particularly when working with reagents, chemicals or process solutions.
- ▶ In case of contact with eyes or skin, rinse the affected area with plenty of water and then seek medical advice. Show the relevant safety data sheet to the physician.

NOTICE**Material damage due to solvents!**

- ▶ Do not use any halogen-containing organic solvents or acetone. These solvents could destroy plastic components of the assembly.

i Potential impact on the process





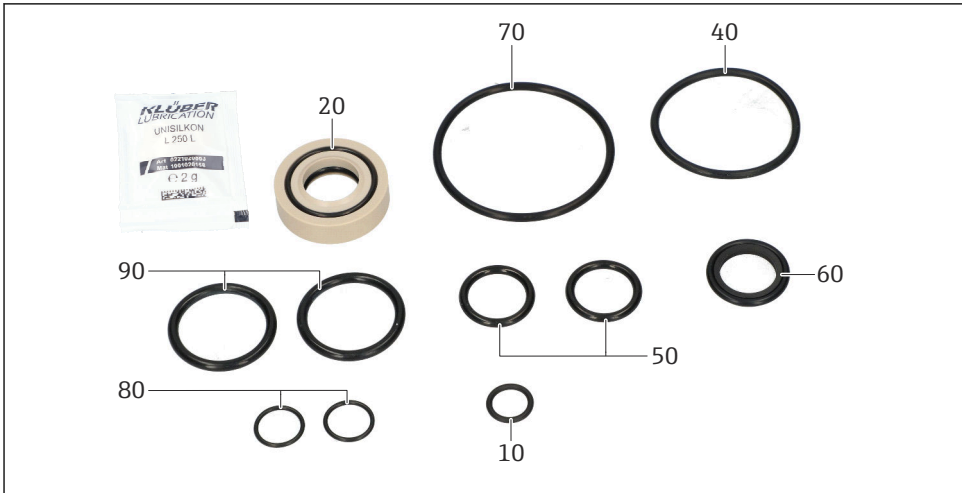

Before decommissioning an active device, the potential impact on the overall process must be taken into account! This applies in particular when using the associated measuring instrument to control process variables.

5 Scope of delivery



A0057578

- 1 CPA474 seals for wetted parts, EPDM/FPM/FFKM

Kit no.	Quantity	Kit item no. →  1,  4 →  2,  6 →  3,  7	Size	Remarks/material
51518483 (EPDM)	1	10	O-ring ID 11.00 W 2.00 OD 15.00	EPDM, FPM or FFKM
51518484 (FPM)	1	20	PEEK scraper	The scraper contains: <ul style="list-style-type: none"> ■ 1 x O-ring ID 19.00 W 3.00 OD 25.00 (EPDM, FPM or FFKM) ■ 1 x O-ring ID 26.70 W 1.78 OD 30.26 (EPDM, FPM or FFKM)
51518485 (FFKM)	1	40	O-ring ID 44.00 W 3.00 OD 50.00	EPDM, FPM or FFKM
	2	50	O-ring ID 19.00 W 3.00 OD 25.00	EPDM, FPM or FFKM
	1	60	Scraper ID 19 mm	EPDM, FPM or FFKM
	1	70	O-ring ID 55.00 W 3.00 OD 61.00	EPDM, FPM or FFKM
	2	80	O-ring ID 13.00 W 1.50 OD 16.00	EPDM, FPM or FFKM
	2	90	O-ring ID 28.17 W3.53 OD 35.23	EPDM, FPM or FFKM
All kits include a 2 g sachet of Klüber UNISILKON L and kit instructions.				

5.1 51518483 CPA474, seals for wetted parts, EPDM

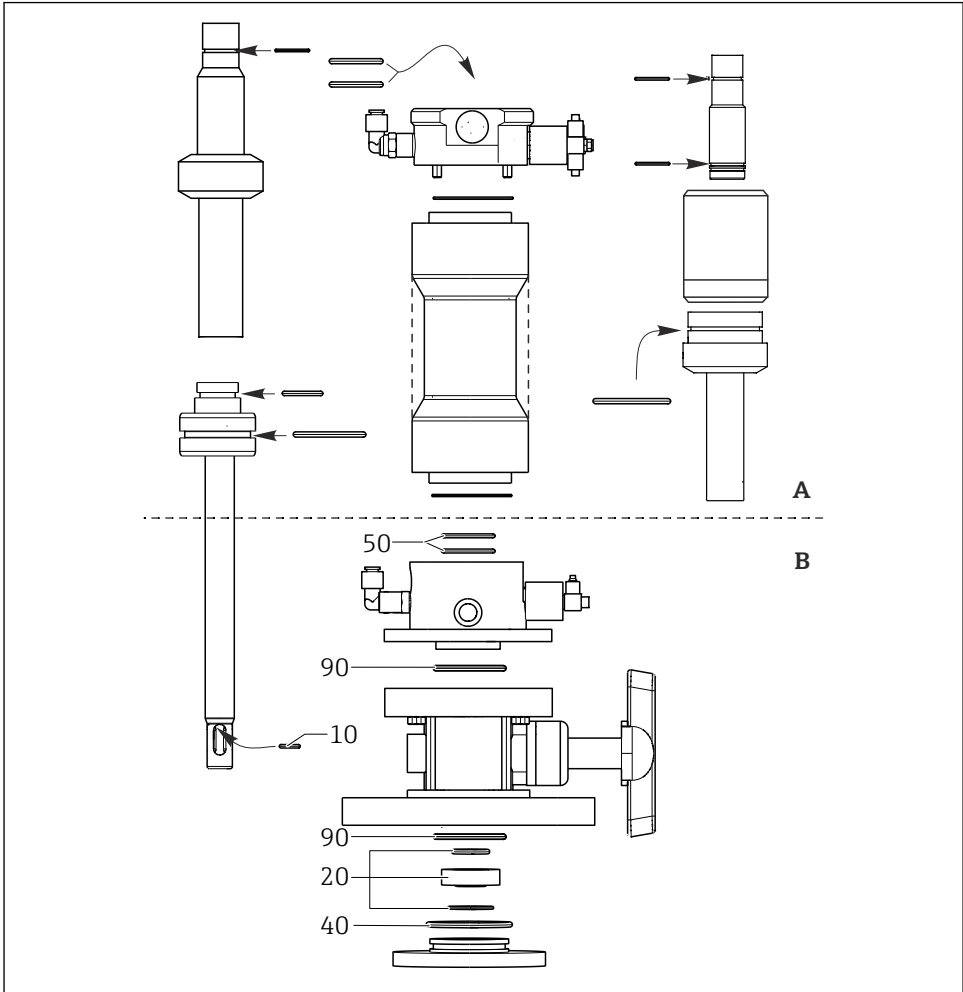

A0057579

2 Installation positions of seals for wetted parts

- A Seals, not in contact with medium
- B Seals, in contact with medium

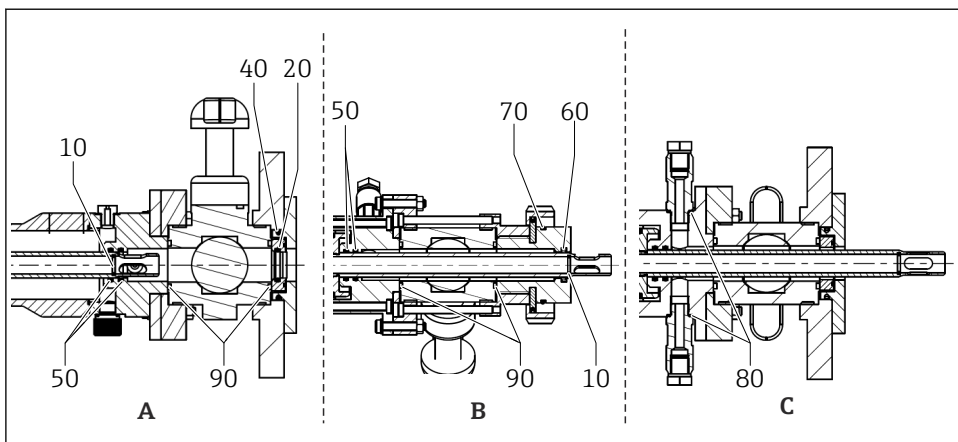

A0057580

3 Installation positions

- A Seals at the process connection flange
- B Seals at the process connection dairy fitting DN65
- C Seals at the rinsing connections

6 Additional documentation

Detailed information on the device can be found in the Operating Instructions for the specific assembly and in the other documentation available via:

- www.endress.com/device-viewer
- Smartphone/tablet: Endress+Hauser Operations app

7 Replacing seals

To replace the wetted seals of the assembly, the process must be stopped, and the assembly must be completely removed as described below (see also Operating Instructions BA345C/07/xx).

⚠ WARNING

Risk of injury from high pressure, high temperature or chemical hazards if process medium escapes!

- ▶ Before installing or removing an assembly, depressurize the system, drain the system and clean it.
- ▶ Wear protective goggles and safety gloves.

i The wetted seals must be inspected at least every 6 months and replaced if necessary.

Preparatory steps:

1. Interrupt the process. Pay attention to residual medium, residual pressure as well as elevated temperatures.
2. Move the assembly to the service position and secure this position with the stop lock bolt.
3. Remove the sensor.
4. Completely detach the assembly from the process connection.
5. Clean the assembly (see the "Cleaning the assembly" section in the Operating Instructions).

Detaching the assembly (illustration with retraction pipe for gel electrodes (stainless steel cylinder version)):

1. Remove the splash protection cap (1).
2. Ensure that the stop lock bolt (3) is engaged.
3. Unscrew the retraction pipe (2) (for KCl electrodes, the retraction pipe remains in place).
4. Loosen the four connecting screws (4) on the top of the flange.
5. Remove the pressure cylinder with the rinse chamber (5) from the ball valve (6).

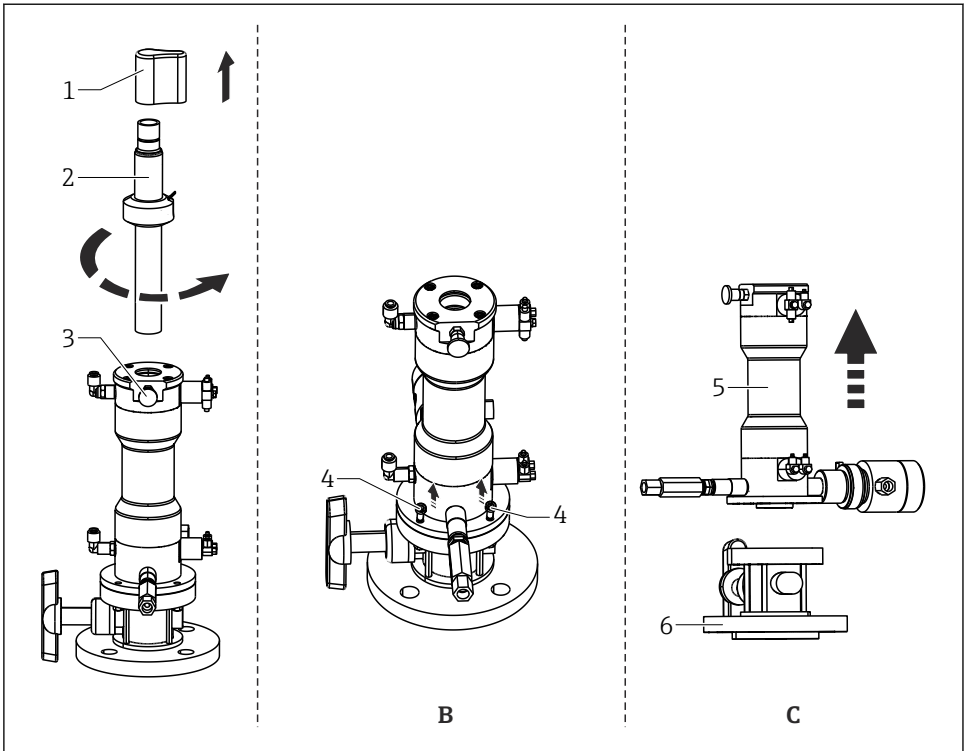

A0057581

4 Disassembly, part 1 (A), part 2 (B) and part 3 (C)

6. Loosen the four connecting screws (9) on the underside of the rinse chamber (8).
7. Remove the rinse chamber (8) from the pressure cylinder with the cylinder head (7).
8. Loosen the four connecting screws (10) on the cylinder head (11).
9. Remove the cylinder head from the pressure cylinder (12).

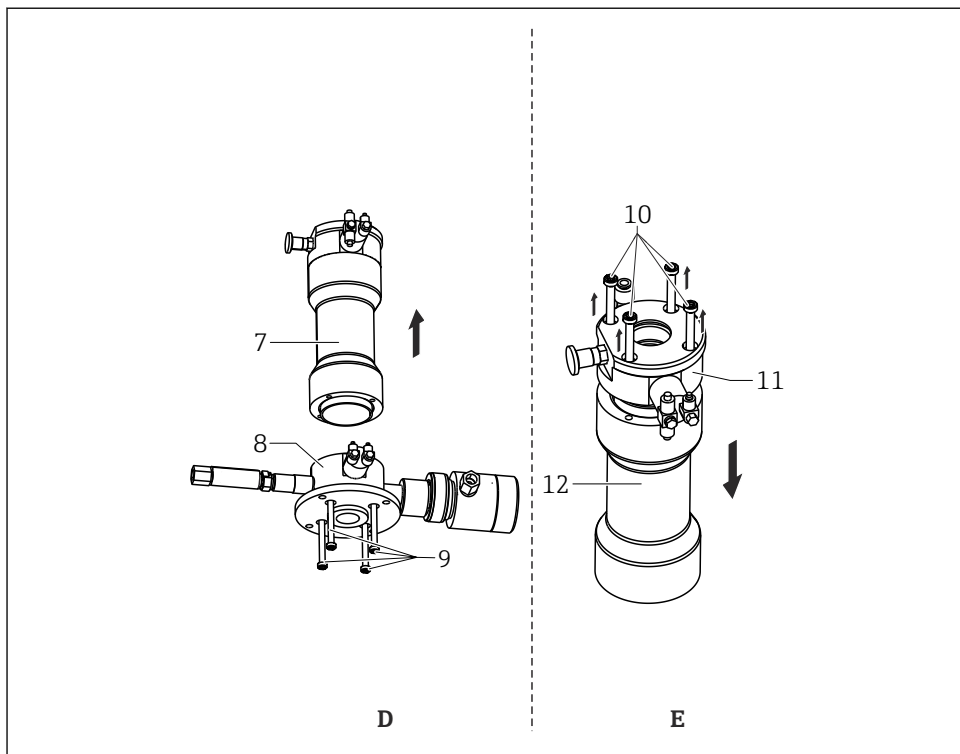

A0057582

5 Disassembly, part 4 (D) and part 5 (E)

Replacing seals

1. Apply a thin layer of lubricant (e.g. Klüber UNISILKON L) to the new seals.
2. Replace the wetted seals .
3. Reassemble the assembly.

8 Disposal

- Please observe local regulations!



71695479

www.addresses.endress.com
