



個別説明書 ファームテーションモニタ QWX43

スタートアップガイド

安全シンボル

取扱説明書を参照してください。

安全上の注意事項

警告

不適切な設定による不正な測定結果、または不適切な設置による負傷の恐れがあります。

- ▶ 訓練を受け、認定された有資格者のみが機器の設定をしてください。
- ▶ 添付されている説明図が分かりにくい場合は、取扱説明書をダウンロードしてください。

警告

高温の表面による火傷の危険があります。

- ▶ 機器の動作中は、プロセス接続部でプロセス固有の温度が最高 80 °C (176 °F) になる可能性があります。適切な手袋を着用するか、機器を冷却させてください。

警告

電圧が印加されている場合、感電の危険性があります。

- ▶ 機器が電圧に接続されている場合は、機器カバーを開けたり、電気接点に触れたりしないでください。

 インターネットへの接続には、安全な WLAN ネットワークをお客様側で用意することを推奨します。

ネットワーク設定

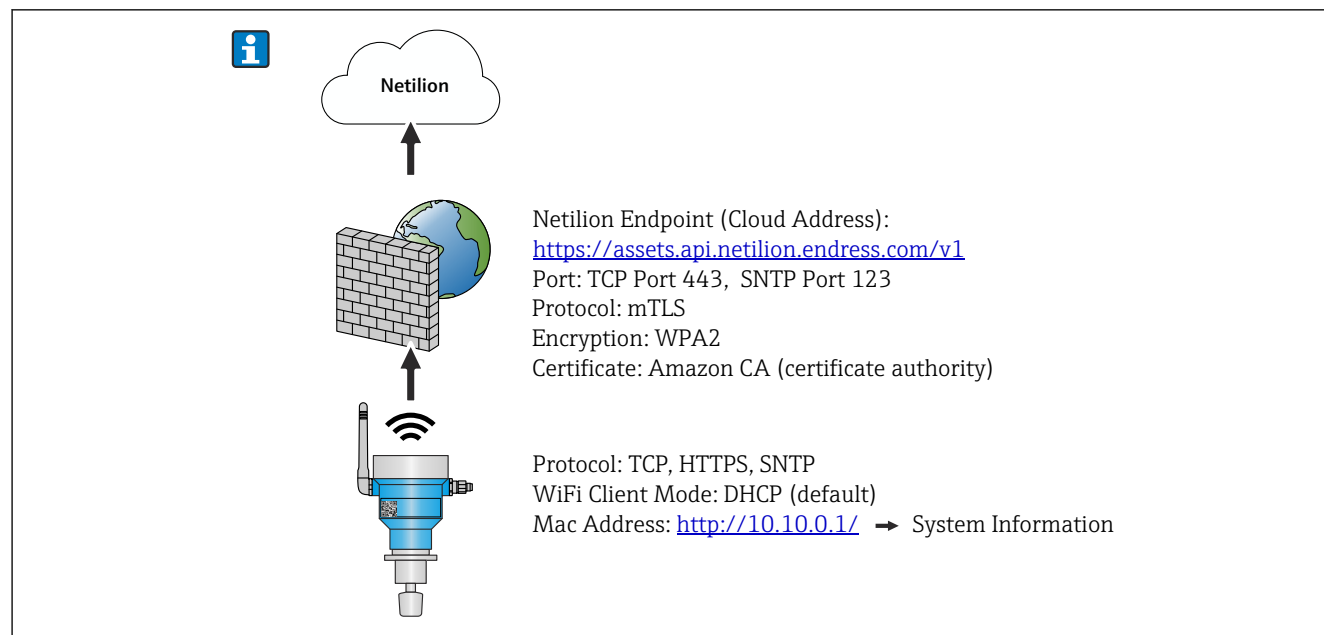

A0054568

Netilion 接続

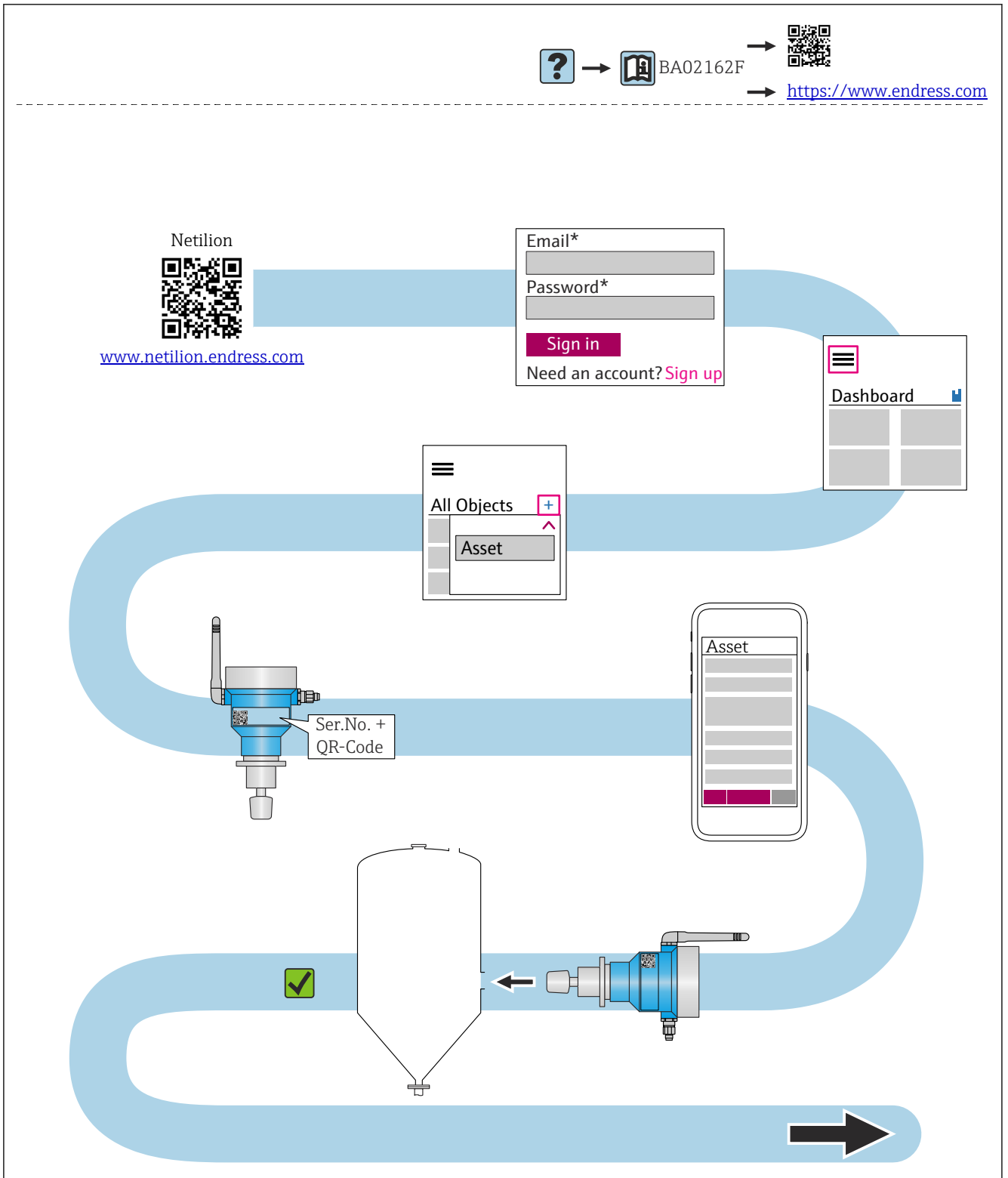

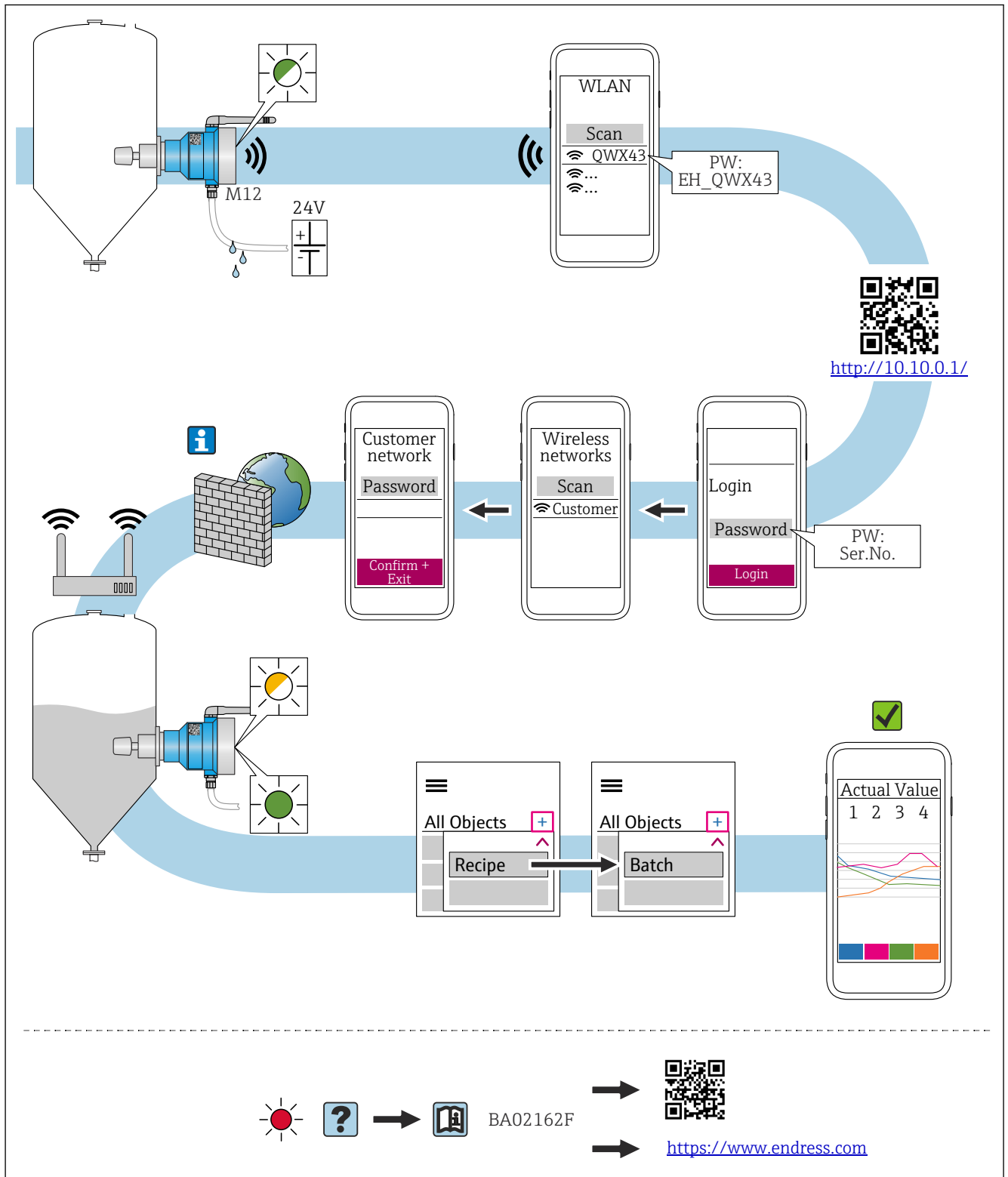

A0055169

ダイレクト・インテグレーション用の接続

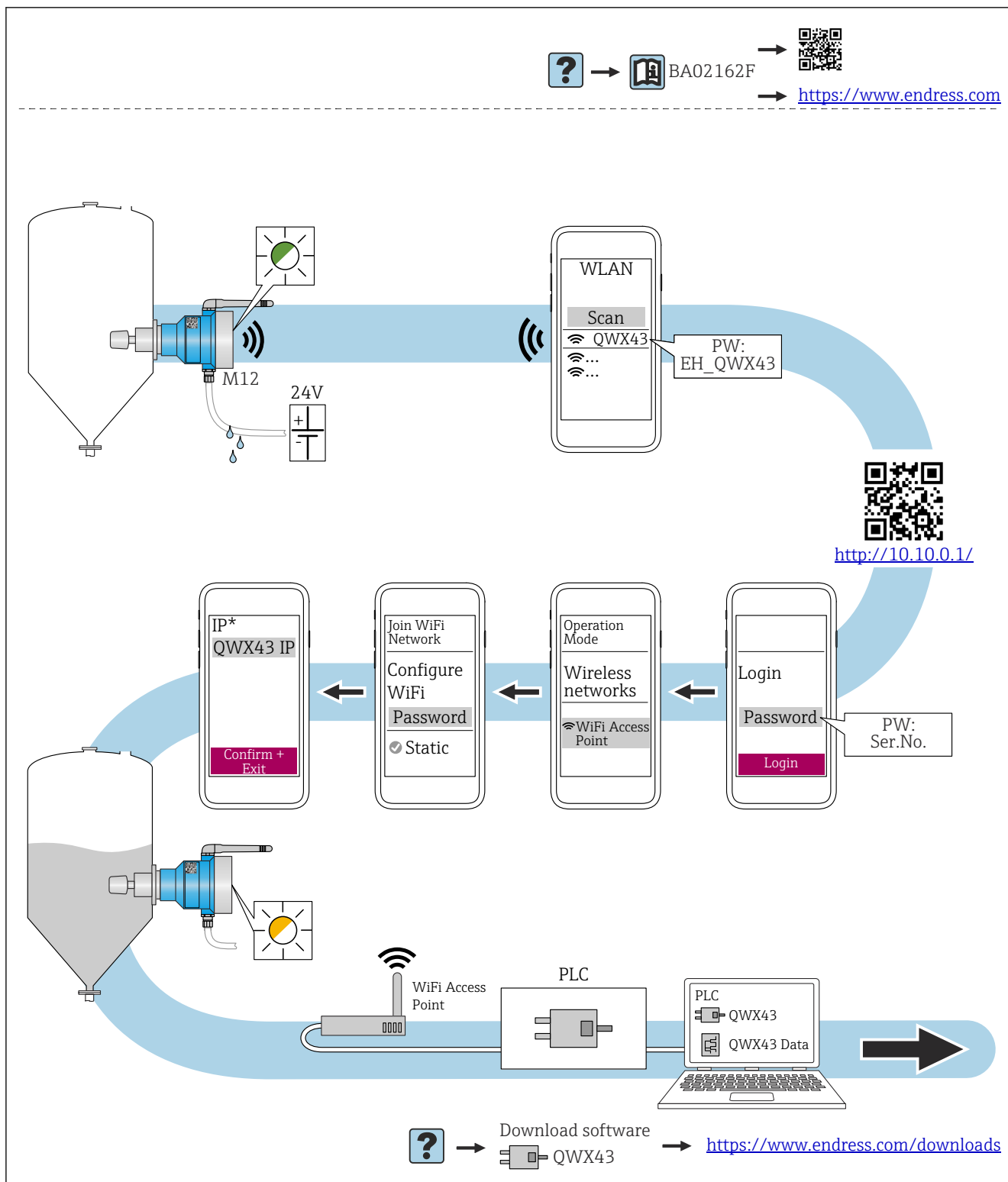

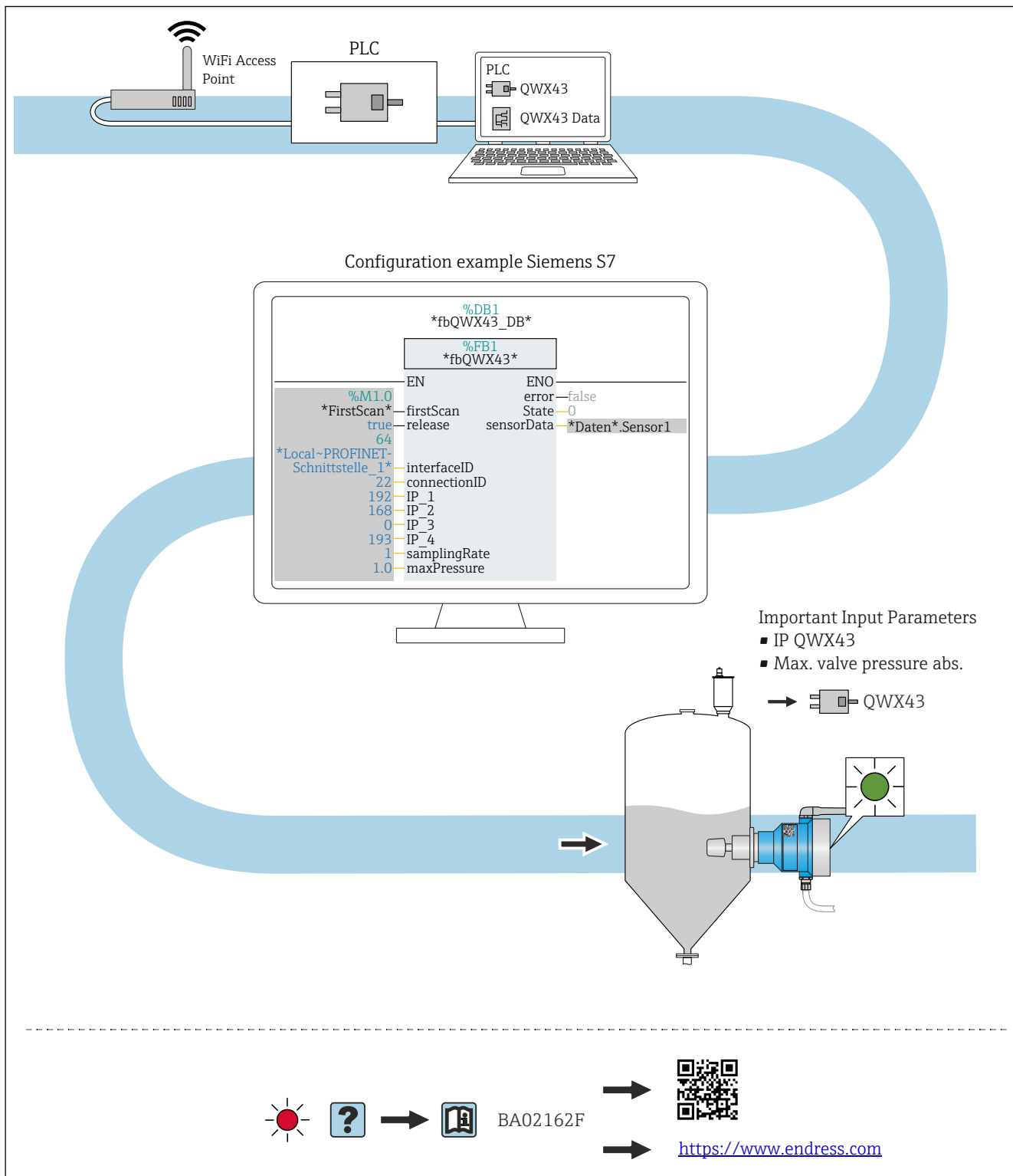

A0054557

無線認証

ヨーロッパ

This device meets the requirements of the Radio Equipment Directive RED 2014/53/EU. The standards applied in this regard are listed in the Declaration of Conformity.

Canada and USA

FCC ID: LCGQWX4X

IC: 2519-QWX4X

English

This device complies with Part 15 of the FCC Rules and with Industry Canada license-exempt RSS standard(s).

Operation is subject to the following two conditions:

- this device may not cause harmful interference, and
- this device must accept any interference received, including interference that may cause undesired operation.

 Changes or modifications made to this equipment not expressly approved by Endress+Hauser SE+Co. KG may void the FCC authorization to operate this equipment.

This equipment has been tested and found to comply with the limits for a Class B digital device, pursuant to Part 15 of the FCC Rules. These limits are designed to provide reasonable protection against harmful interference in a residential installation. This equipment generates, uses and can radiate radio frequency energy and, if not installed and used in accordance with the instructions, may cause harmful interference to radio communications. However, there is no guarantee that interference will not occur in a particular installation.

If this equipment does cause harmful interference to radio or television reception, which can be determined by turning the equipment off and on, the user is encouraged to try to correct the interference by one or more of the following measures:

- reorient or relocate the receiving antenna
- increase the separation between the equipment and receiver
- connect the equipment into an outlet on a circuit different from that to which the receiver is connected
- consult the dealer or an experienced radio/TV technician for help Radiofrequency radiation exposure information.

This equipment complies with FCC and IC radiation exposure limits set forth for an uncontrolled environment. This equipment should be installed and operated with minimum distance of 20 cm (7.87 in) between the radiator and your body.

This transmitter must not be co-located or operating in conjunction with any other antenna or transmitter.

Français

Le présent appareil est conforme aux CNR d'industrie Canada applicables aux appareils radio exempts de licence.

L'exploitation est autorisée aux deux conditions suivantes :

- L'appareil ne doit pas produire de brouillage, et
- L'utilisateur de l'appareil doit accepter tout brouillage radioélectrique subi, même si le brouillage est susceptible d'en compromettre le fonctionnement.

 Les changements ou modifications apportées à cet appareil non expressément approuvée par Endress+Hauser SE+Co. KG peut annuler l'autorisation FCC d'utiliser cet appareil.

Déclaration d'exposition aux radiations

Cet équipement est conforme aux limites d'exposition aux rayonnements IC établies pour un environnement non contrôlé. Cet équipement doit être installé et utilisé avec un minimum de 20 cm (7.87 in) de distance entre la source de rayonnement et votre corps.

Ce transmetteur ne doit pas être placé au même endroit ou utilisé simultanément avec un autre transmetteur ou antenne.

Brasil

Resolução 680 – ATO 14448

Este equipamento não tem direito à proteção contra interferência prejudicial e não pode causar interferência em sistemas devidamente autorizados. Para maiores informações, consulte o site da ANATEL – www.gov.br/anatel.

CISPR22

Este produto não é apropriado para uso em ambientes domésticos, pois poderá causar interferências eletro-magnéticas que obrigam o usuário a tomar medidas necessárias para minimizar estas interferências.



A0039064

Japan

Japanese Radio Law and Japanese Telecommunications Business Law Compliance.

This device is granted pursuant to the Japanese Radio Law (電波法) and the Japanese Telecommunications Business Law (電気通信事業法).

This device should not be modified (otherwise the granted designation number will become invalid).

México

IFETEL

La operación de este equipo está sujeta a las siguientes dos condiciones:

- (1) Es posible que este equipo o dispositivo no cause interferencia perjudicial y
- (2) Este equipo o dispositivo debe aceptar cualquier interferencia, incluyendo la que pueda causar su operación no deseada.

Perú

NOTICE: Changes or modifications made to this equipment not expressly approved by Endress+Hauser SE+Co. KG may void the FCC authorization to operate this equipment.

Republic of Korea



A0039065

- Registration Nr: R-R-ehs-QWX43
- Applicant: Endress+Hauser SE+Co. KG
- Equipment name: Fermentation Monitor
- Model name: QWX43

South Africa



A0055171

Tailand

เครื่องโทรคมนาคมและอุปกรณ์นี้ มีความสอดคล้องตามข้อกำหนดของ กสทช.

(This telecommunication equipment is in compliance with NBTC requirements.)



A0046301

(This radiocommunication equipment is exempted to possess license, user license, or radiocommunication station license as per NBTC notification regarding radiocommunication equipment and radiocommunication station has been exempted for license according to radio communication act B.E.2498.)
