

Remote Housing for Multicap T DC 12 TA

Multicap DC 11/16/21/26 TAN

Multicap DC 11/16/21726 TAS with Electronic Inserts FEC 12/22

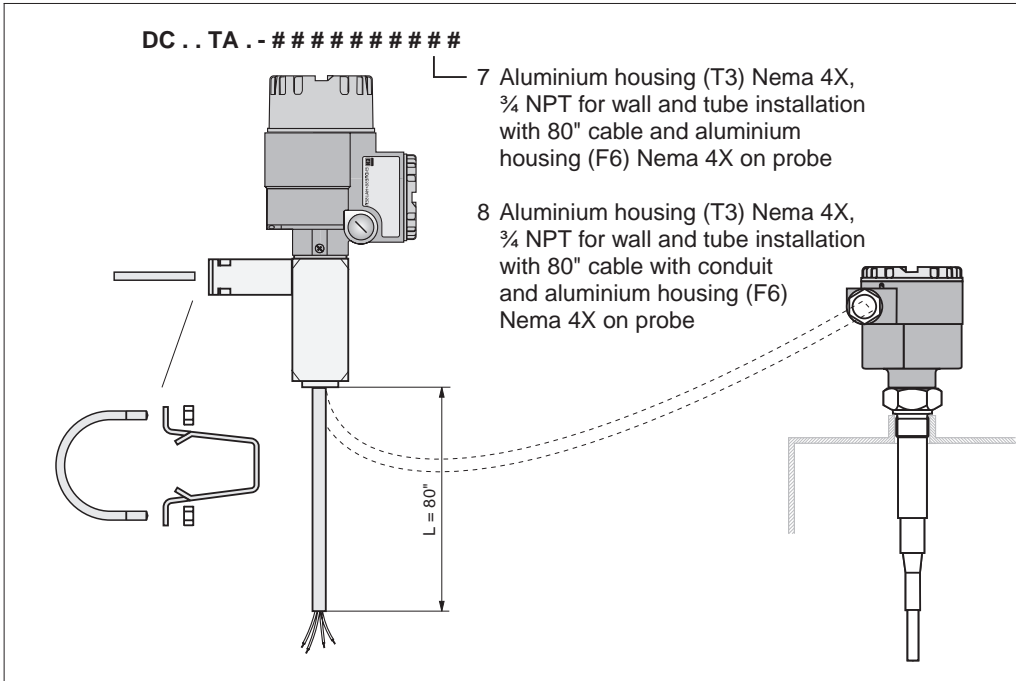

Device Identification

Check before installing that the correct instrument has been delivered: Check the product designation on the nameplate agrees with the specifications in drawings or those of the product structure (see TI 239F/00/en or BA 157F/00/en).

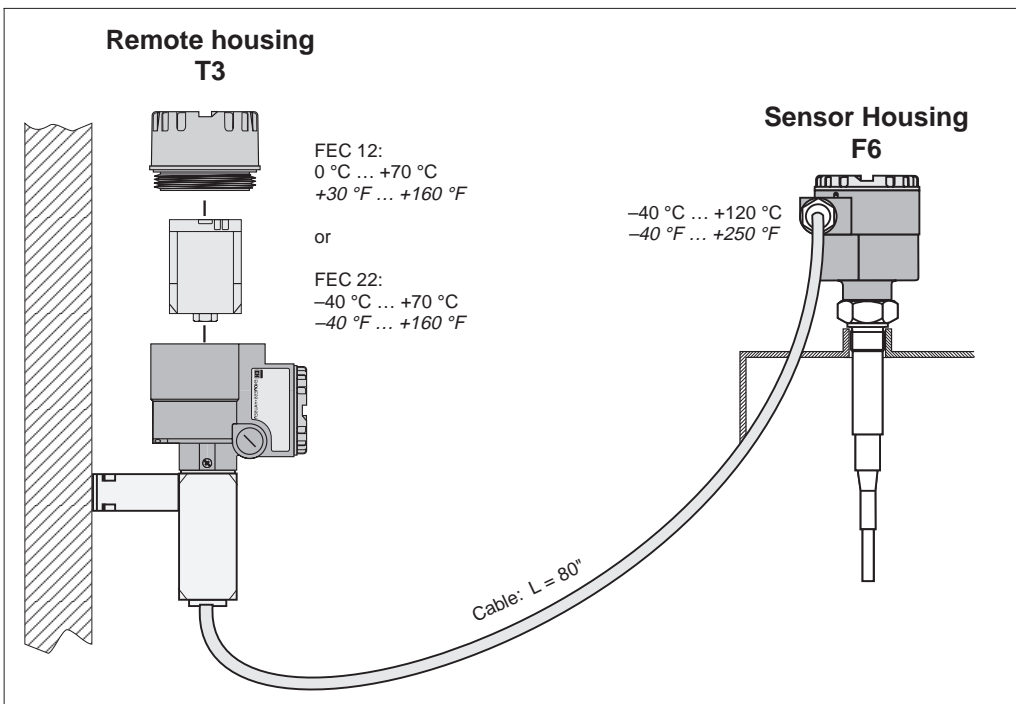

Application

Note the specifications on ambient temperature on the sensor housing and on the separate housing (depends on the electronic insert).

Remote Housing

Installation

The mounting accessories included with delivery enable the separate housing to be mounted on a wall or a horizontal or vertical 2" pipe.

Select a mounting position that is protected from vibration and heat radiation and also has sufficient space for connecting and calibrating the instrument. Note the max. length (L = 80") of the connecting cable.

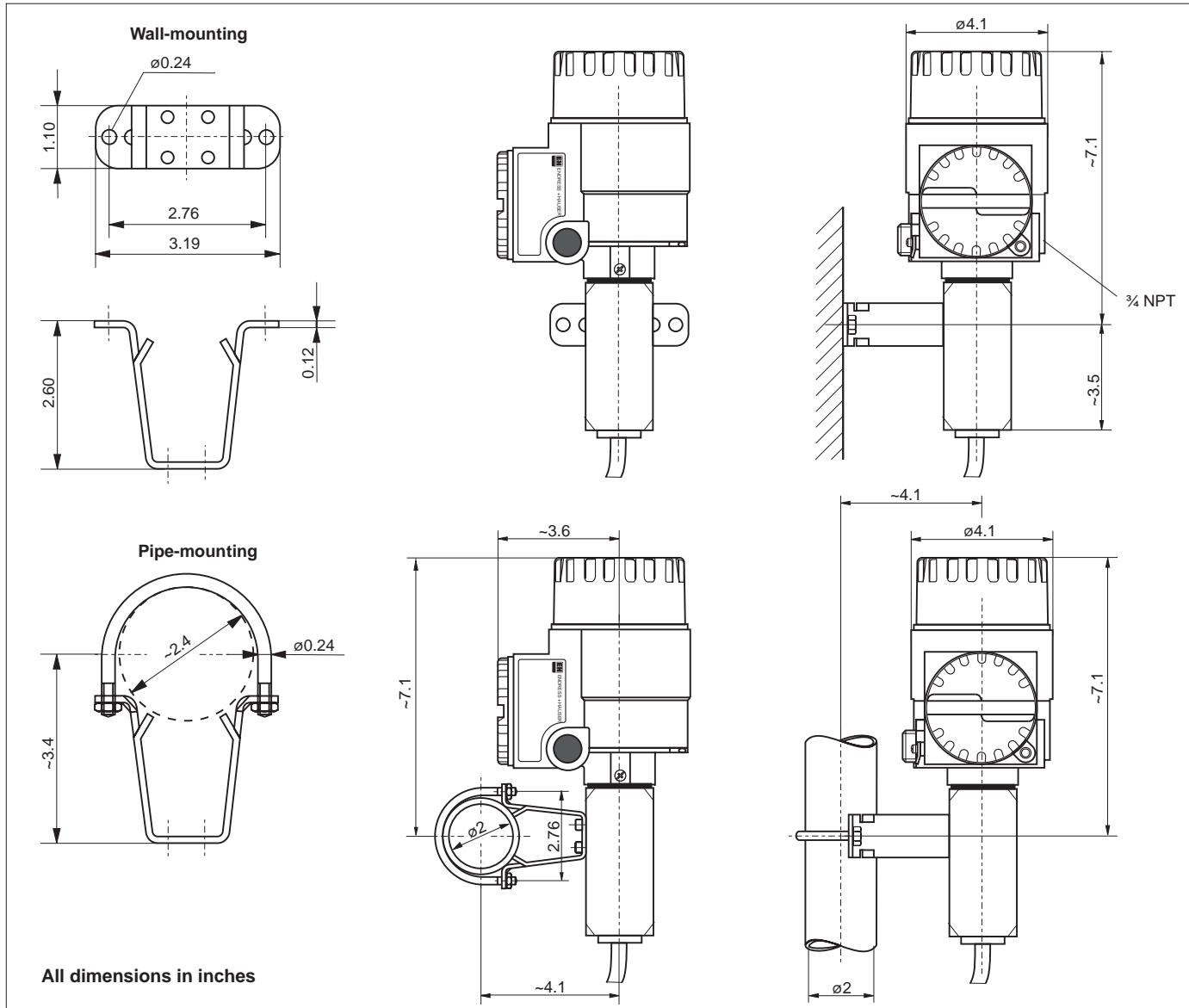

Cable Gland Orientation

- Open the housing cover
- Loosen the screw in the mounting ring in the front of the terminal block by 3...4 turns
- Turn housing until the cable gland points downwards
- Retighten the screw in the mounting ring in the front of the terminal block
- Close the housing cover

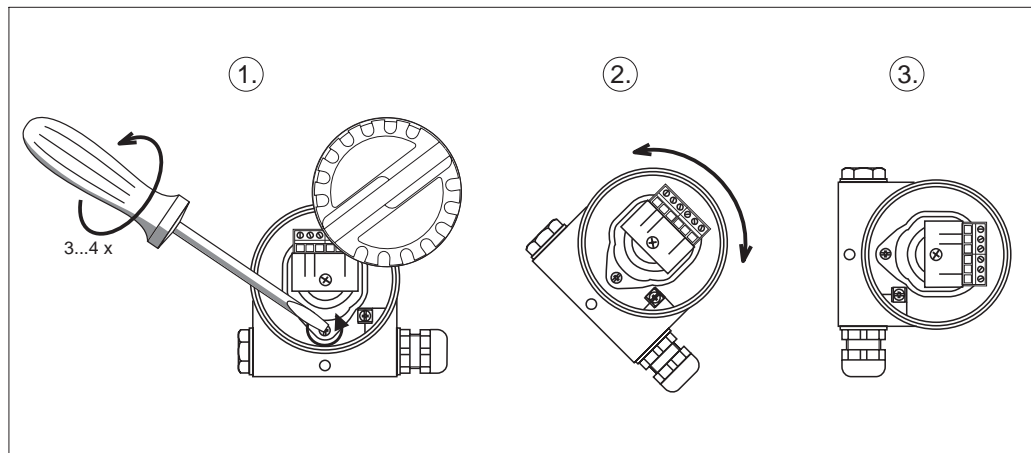

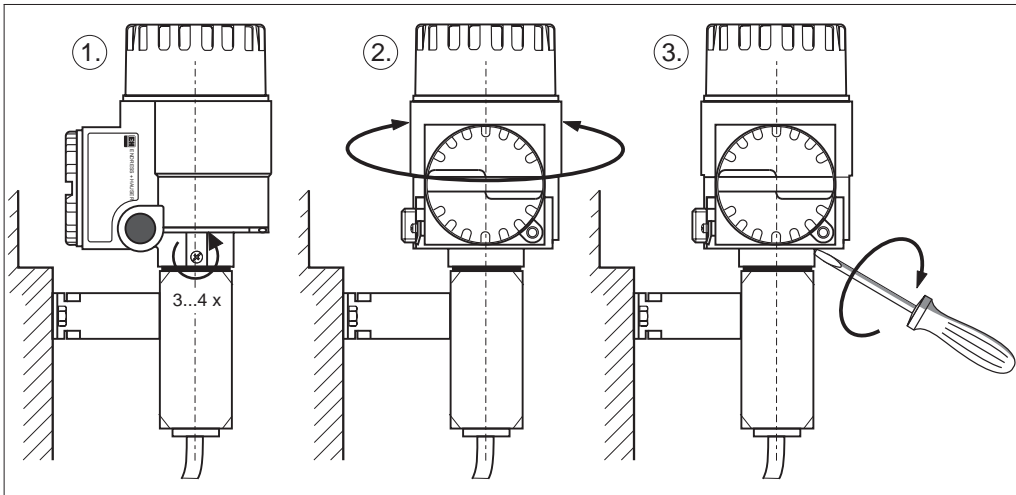

Positioning the Separate Housing

- Loosen the screw on the grip of the housing by 3...4 turns
- Position the housing in the desired direction
- Retighten the screw on the grip of the housing

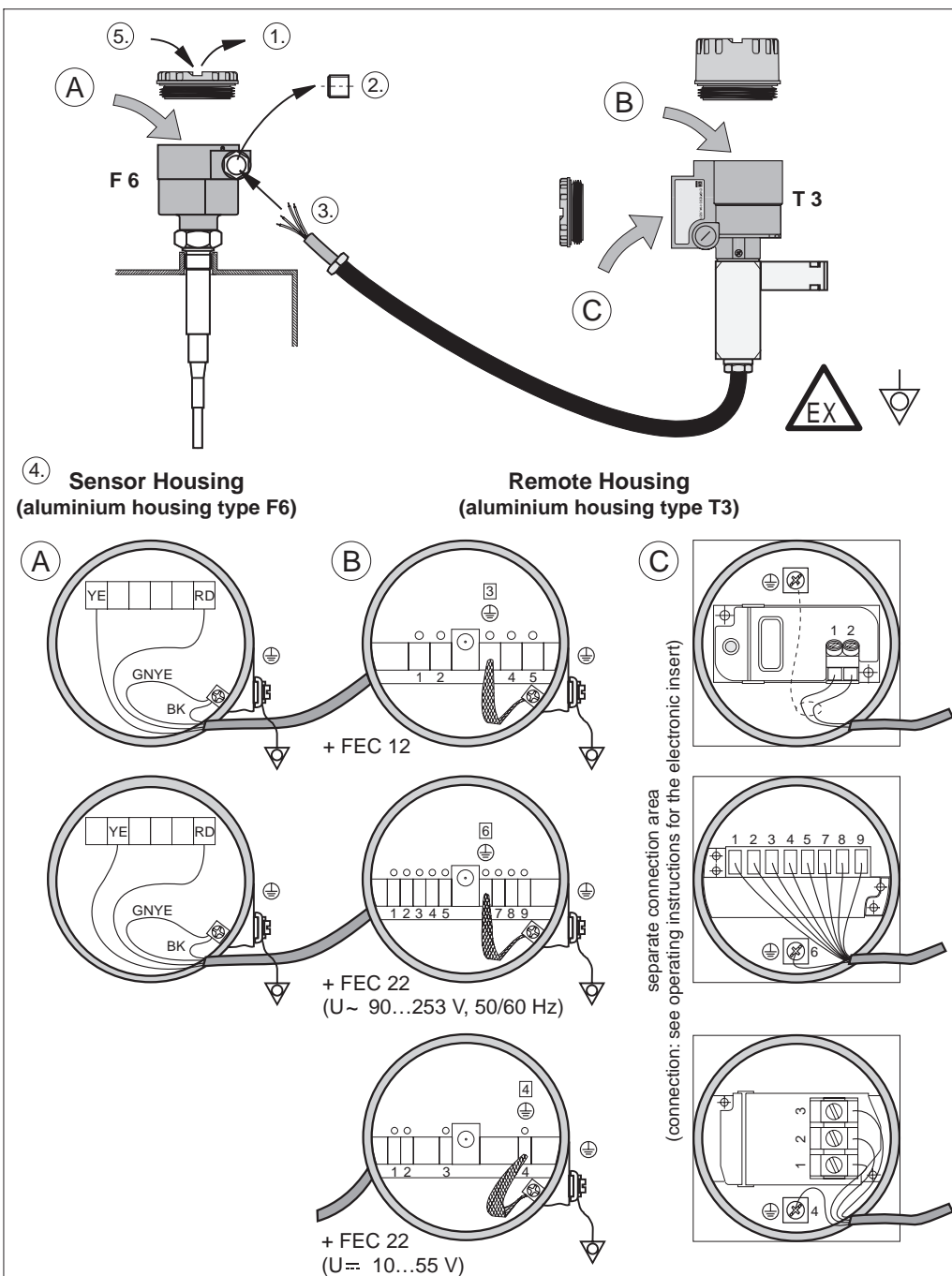

Connection

- Unscrew the cover of the Multicap. Do not wipe away the lubrication from around the thread of the cover or the gasket!
- Unscrew the protective packing (yellow plastic plug) from the cable entry.
- Connect the connecting cable to the terminal block according to their colour coding.

YE = yellow
 RD = red
 BK = black
 GNYE = green-yellow

▽ Potential matching

- Connect the green/yellow protective earth to the ground connection in the sensor housing.
- Screw down the housing cover.

