



Level



Pressure



Flow



Temperature



Liquid
Analysis



Registration



Systems
Components



Services



Solutions

Operating Instructions

Dipfit W CYA611

PVC immersion assembly for oxygen, turbidity sensors and
pH/ORP electrodes CPF81/82

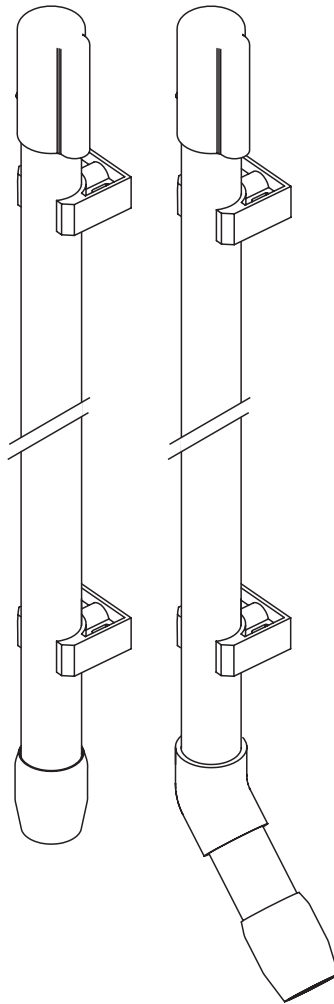

Brief overview

Here is how to use these Operating Instructions to commission your assembly quickly and safely:









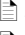

→  4	Safety instructions
→  5	
	General safety instructions Explanation of warning symbols You can find special instructions at the appropriate position in the chapter in question. The significance is indicated by the icons Warning  , Caution  and Note  .
	▼
→  7	Installation
→  13	
→  16	
	Here, you can find installation conditions such as dimensions of the assembly. These pages describe the various mounting possibilities of the assembly. Refer to these pages to install a sensor in the assembly.
	▼
→  17	Maintenance
→  20	
	For normal operation of the assembly, it is absolutely essential to carry out maintenance tasks on a regular basis, such as cleaning the assembly and the sensor. On the given pages, you find the available accessories for the assembly.
	▼
→  23	Technical data
	Ambient conditions, process conditions, weight, material, etc.
	▼
→  25	Index
	You can find important terms and keywords on individual chapters here. Use the index to find the information you need quickly and efficiently.

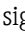
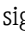
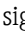
Table of contents

1	Safety instructions	4
1.1	Designated use	4
1.2	Installation, commissioning and operation	4
1.3	Operational safety	4
1.4	Return	4
1.5	Notes on safety conventions and icons	5
2	Identification	6
2.1	Nameplate	6
2.2	Product structure	6
2.3	Scope of delivery	6
3	Installation	7
3.1	Incoming acceptance, transport, storage	7
3.2	Installation conditions	7
3.3	Installation	10
3.4	Post-installation check	16
4	Maintenance	17
4.1	Cleaning	17
5	Accessories	20
5.1	Mounting	20
5.2	Cleaning	20
5.3	Sensors	20
5.4	Measuring cables	21
6	Technical data	23
6.1	Environment	23
6.2	Process	23
6.3	Mechanical construction	23
	Index	24

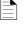
1 Safety instructions

1.1 Designated use

The CYA611 immersion assembly has been designed for simple installation of sensors with threaded connections. It is used in open channels, basins and tanks in water and wastewater applications.

Any other use than the one described here compromises the safety of persons and the entire measuring system and is, therefore, not permitted.

The manufacturer is not liable for damage caused by improper or non-designated use.

1.2 Installation, commissioning and operation

Please note the following items:

- Installation, commissioning, operation and maintenance of the measuring system must only be carried out by trained technical personnel.
The technical personnel must be authorized for the specified activities by the system operator.
- Electrical connection must only be carried out by a certified electrician.
- Technical personnel must have read and understood these Operating Instructions and must adhere to them.
- Before commissioning the entire measuring point, check all the connections for correctness. Ensure that electrical cables and hose connections are not damaged.
- Do not operate damaged products and secure them against unintentional commissioning. Mark the damaged product as being defective.
- Measuring point faults may only be rectified by authorized and specially trained personnel.
- If faults can not be rectified, the products must be taken out of service and secured against unintentional commissioning.
- Repairs not described in these Operating Instructions may only be carried out at the manufacturer's or by the service organisation.

1.3 Operational safety

The assembly has been designed and tested according to the state of the art and left the factory in perfect functioning order.

Relevant regulations and European standards have been met.

As the user, you are responsible for complying with the following safety conditions:

- Installation instructions
- Local prevailing standards and regulations.

1.4 Return

If the assembly has to be repaired, please return it *cleaned* to the sales center responsible. Please use the original packaging, if possible.

Please enclose the completed "Declaration of contamination" (copy the second last page of these Operating Instructions) with the packaging and the transportation documents.

No repair without completed "Declaration of contamination"!

1.5 Notes on safety conventions and icons

1.5.1 Safety icons



Warning!

This symbol alerts you to hazards. They can cause serious damage to the instrument or to persons if ignored.



Caution!

This symbol alerts you to possible faults which could arise from incorrect operation. They could cause damage to the instrument if ignored.



Note!

This symbol indicates important items of information.

1.5.2 Document symbols

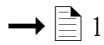

This symbol indicates a cross reference to a defined page (e.g. p. 1).



This symbol indicates a cross reference to a defined figure (e.g. fig. 2).

2 Identification

2.1 Nameplate

You can identify the assembly version by the order code on the nameplate. Please compare this code with your order.

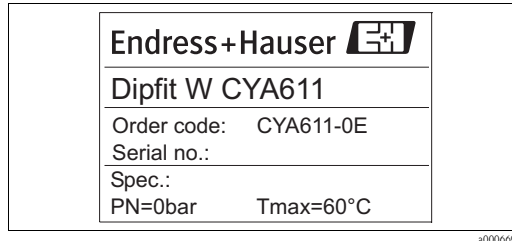

Fig. 1: Nameplate (example)

For information on available assembly versions and the resulting order codes, please see the product structure.

2.2 Product structure

Version	
0	Ready mounted + mounting tube d = 40 mm
1	Component parts (without mounting tube)

Sensor connection	
A	Thread G 1
B	Thread NPT 3/4"
C	Thread G 3/4
D	Thread NPT 1/2"
E	Thread G 1, 45°

CYA611-			complete order code
---------	--	--	---------------------

2.3 Scope of delivery

The scope of delivery comprises:

- Ordered assembly version
- 2 pipe clamps
- Worm drive hose clip
- Operating Instructions, English

If you have any questions, please contact your supplier or your sales center responsible.

3 Installation

3.1 Incoming acceptance, transport, storage

- Make sure the packaging is undamaged!
Inform the supplier about damage to the packaging. Keep the damaged packaging until the matter has been settled.
- Make sure the contents are undamaged!
Inform the supplier about damage to the delivery contents. Keep the damaged products until the matter has been settled.
- Check that the scope of delivery is complete and agrees with your order and the shipping documents.
- The packaging material used to store or to transport the product must provide shock protection and humidity protection. The original packaging offers the best protection. Also, keep to the approved ambient conditions (see "Technical data").
- If you have any questions, please contact your supplier or your sales center responsible.

3.2 Installation conditions

3.2.1 Dimensions

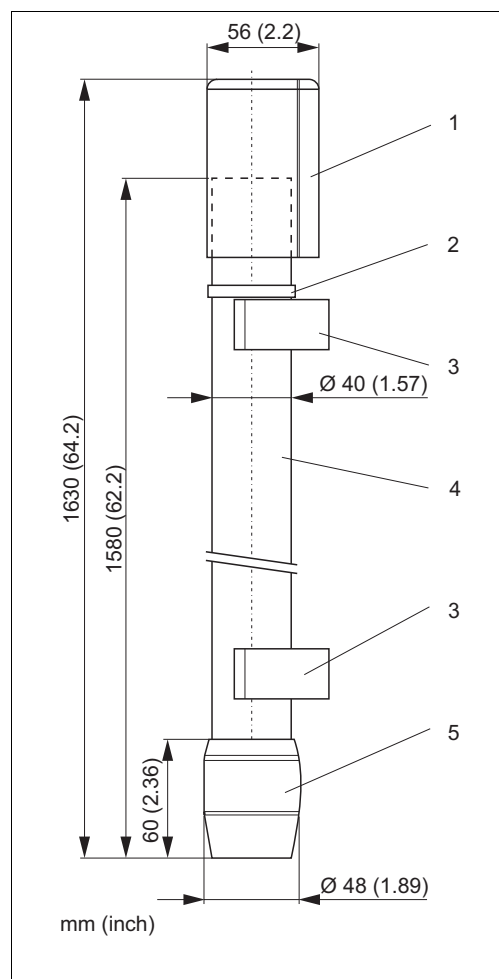

Fig. 2: CYA611 dimensions

- 1 Protection cap
- 2 Worm drive hose clip
- 3 Wall attachment (pipe clamps)
- 4 Pipe OD 40
- 5 Threaded coupling

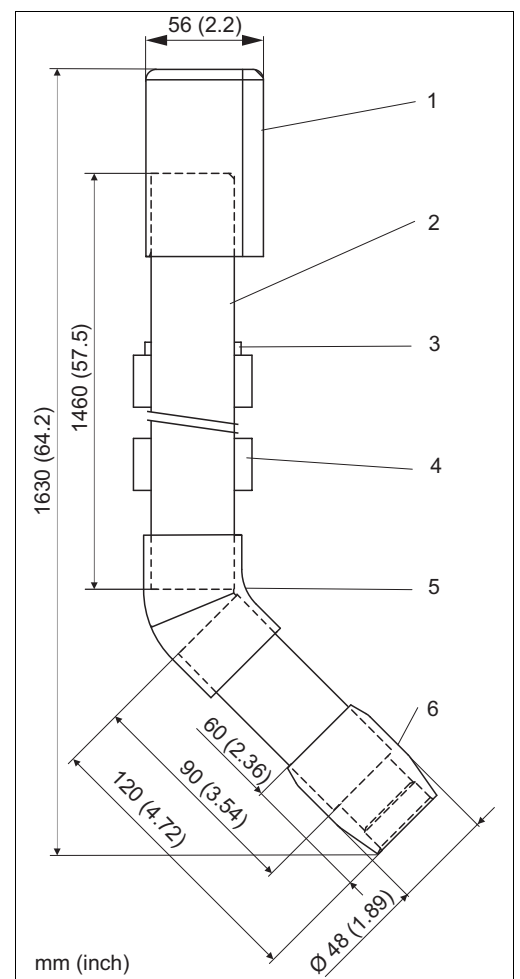

Fig. 3: Dimensions of CYA611-*E, 45° version

- 1 Protection cap
- 2 Pipe OD 40
- 3 Worm drive hose clip
- 4 Wall attachment (pipe clamps)
- 5 45° elbow, glued-in
- 6 Threaded coupling

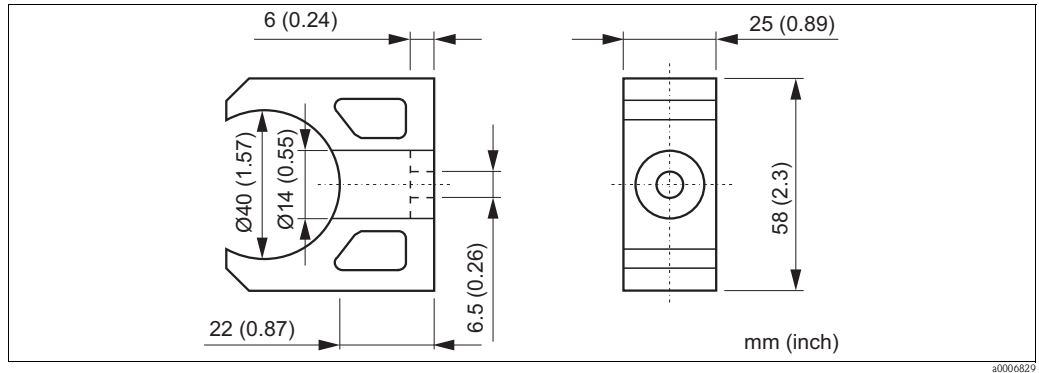

Fig. 4: Pipe clamp dimensions

Mounting kit dimensions (suspension bracket, see "Accessories")

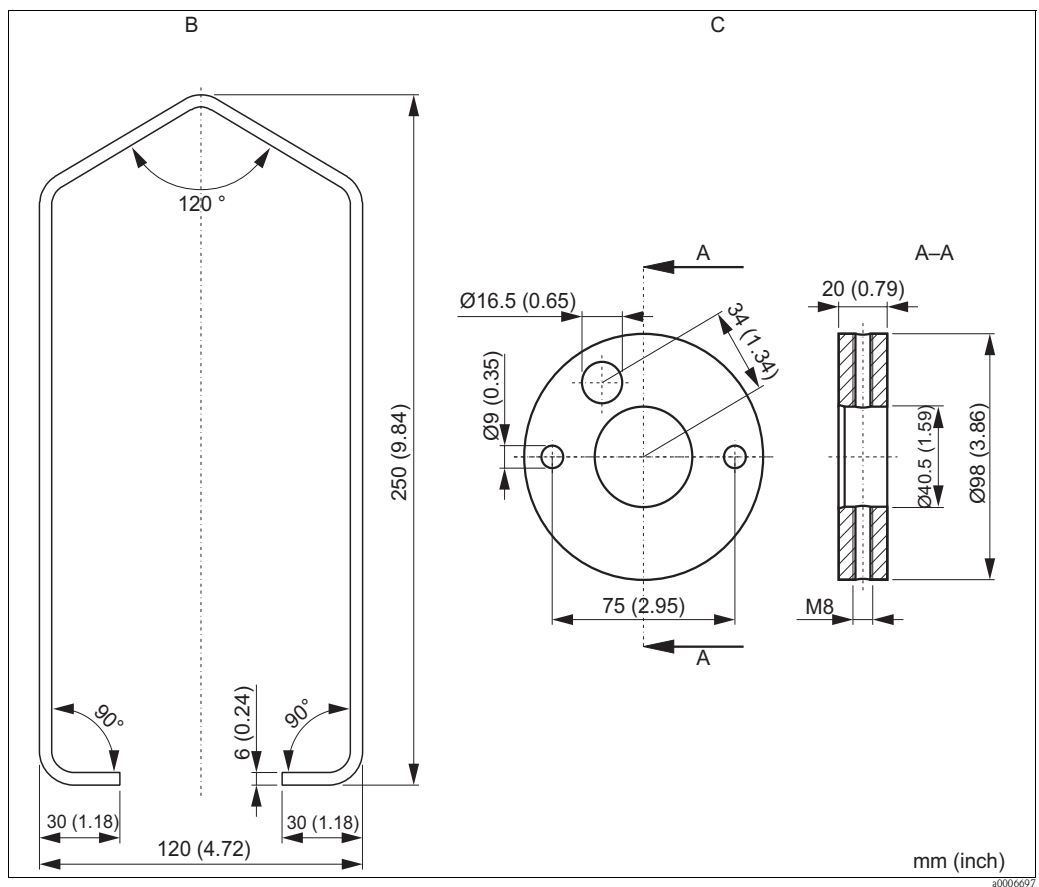

Fig. 5: Mounting kit dimensions

B Suspension bracket

C Supporting ring for attachment of suspension bracket

Pendulum frame dimensions (see "Accessories")

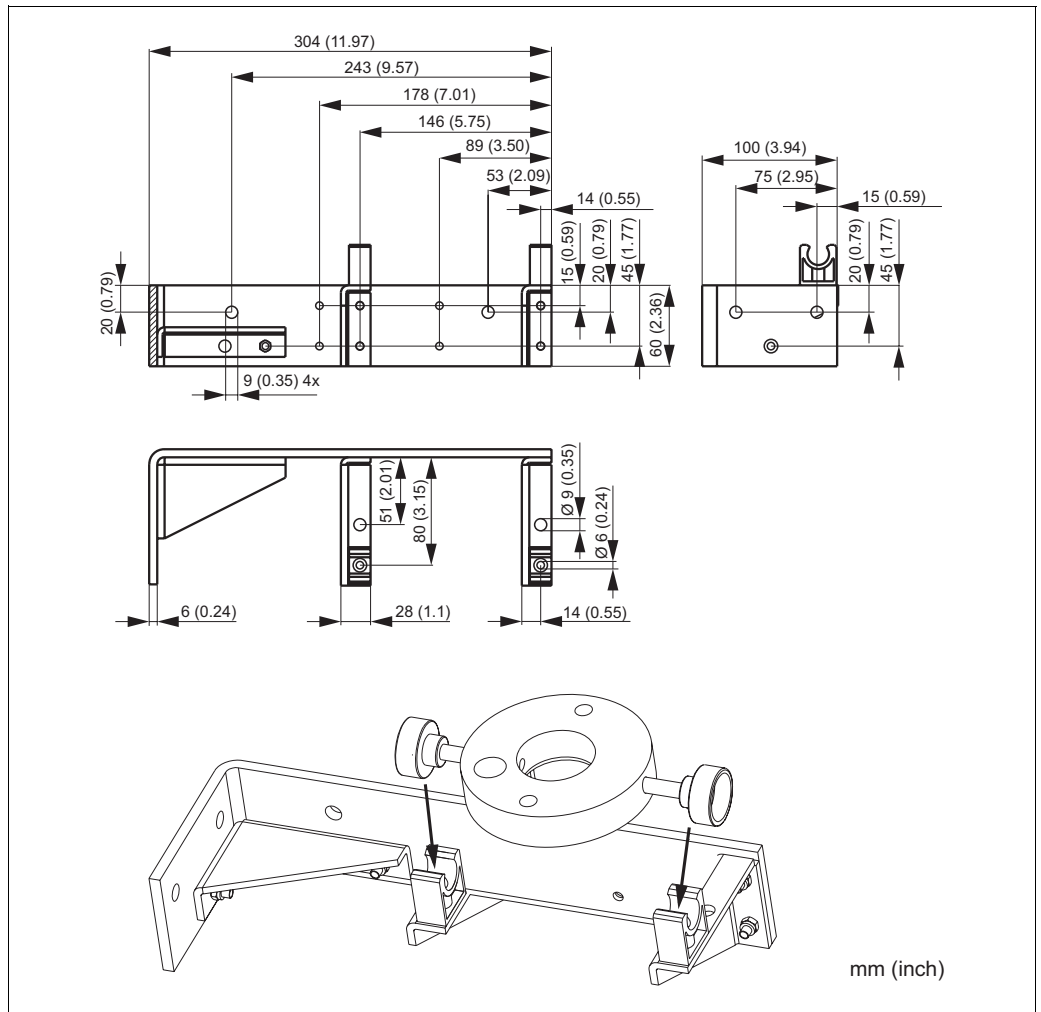

Fig. 6: Pendulum frame dimensions

a0006704

3.3 Installation

3.3.1 Measuring system

A complete measuring system consists of:

- Dipfit W CYA611 assembly
- Oxygen or turbidity sensor or CPF81/82 compact pH/ORP electrode
- Transmitter, e.g. Liquisys M
- Measuring cable (terminated)

Optional:

- VBA junction box
- Extension cable (non-terminated): PMK, CYK71 or OMK depending on sensor

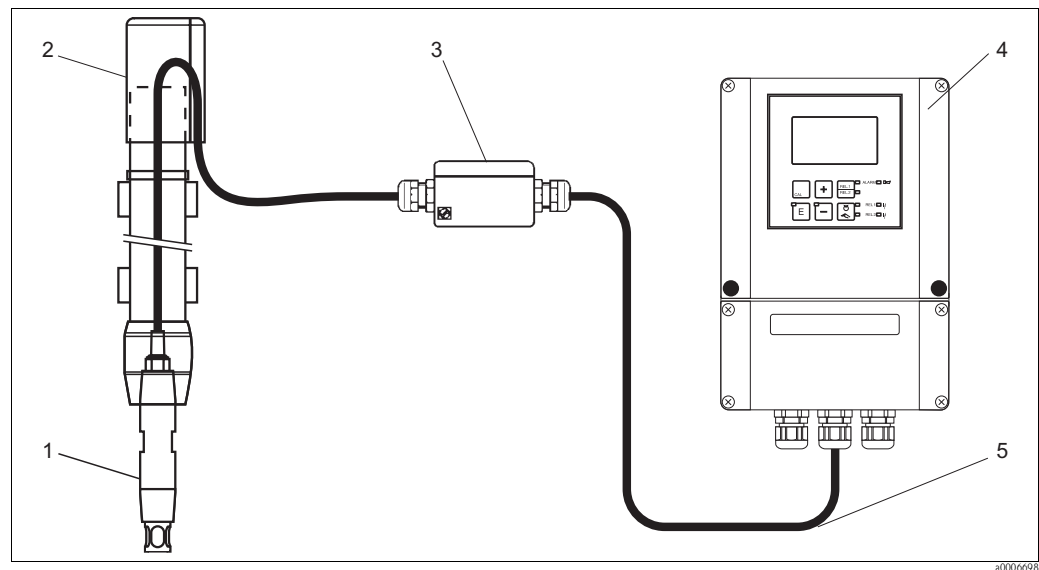

Fig. 7: Example: pH measuring system with CYA611

- 1 CPF81 compact pH electrode
- 2 Dipfit W CYA611
- 3 VBA junction box
- 4 Liquisys M CPM253
- 5 CYK71 measuring cable

3.3.2 Installation of component parts

If you have ordered the version **CYA611-1**, you receive the following component parts:

- 1 protection cap
- 1 worm drive hose clip
- 2 pipe clamps
- 1 threaded coupling
- 45° version:
PVC knee, 45°

To assemble the component parts, you have to provide the following components:

- PVC pipe: outer diameter x wall thickness = 40 x 3 mm (1.57" x 0.12") according to DIN 8062
- PVC adhesive, e.g. Tangit by Henkel or PeViCol by ASV Stübbe
- 45° version:
PVC pipe: OD 40 mm (1.57"), length 90 mm (3.54")

Mounting the threaded coupling



Warning!

- Observe the instructions and safety notes of the adhesive manufacturer.
- Explosion hazard!
Do not smoke. Avoid open flames. Discontinue welding. Switch off electrical equipment without Ex protection, e.g. electric fires, etc.
- Adhesive and cleaner contain volatile solvents! Make sure that closed rooms are adequately ventilated or vented.
- Do **not** pour excess adhesive or cleaner down the water drain.

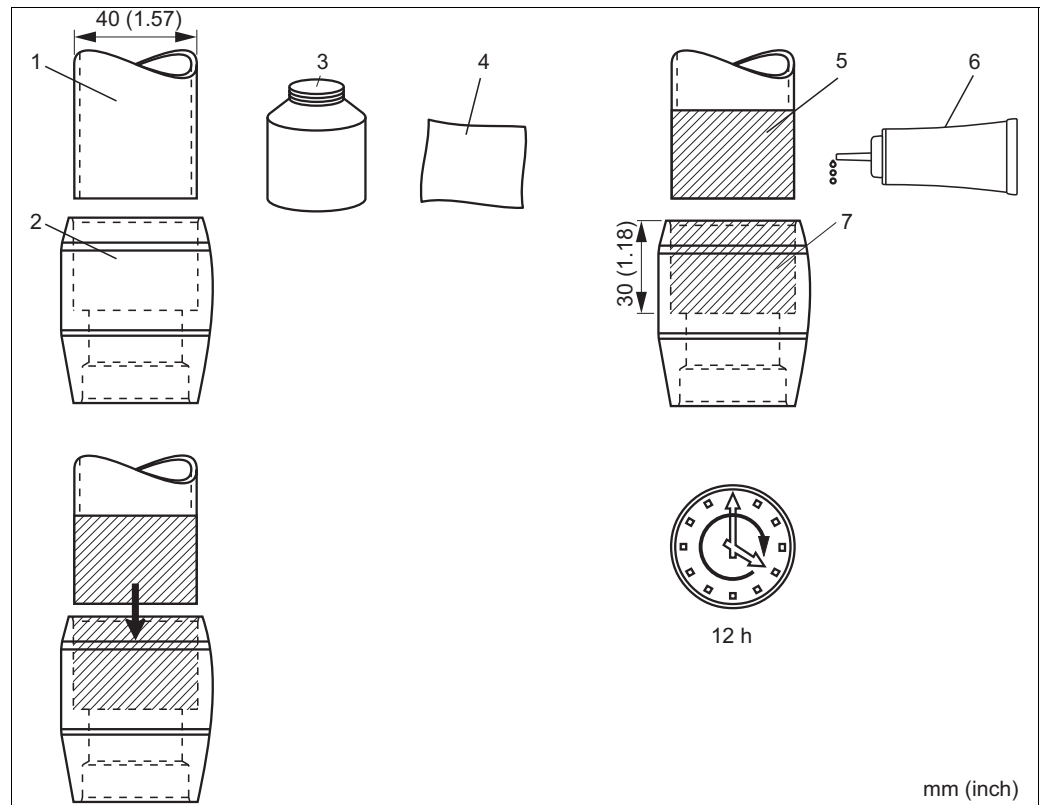

Fig. 8: Assembly of component parts

- | | | | |
|---|----------|---|---|
| 1 | Pipe end | 5 | Pipe end with adhesive applied to outside |
| 2 | Coupling | 6 | PVC adhesive |
| 3 | Cleaner | 7 | Coupling with adhesive applied to inside |
| 4 | Cloth | | |



Caution!

- In case of temperatures around freezing, warm up the pipe end and the coupling to hand temperature.
- In case of higher temperatures, avoid exposure of adhesive to direct sunlight and cool with water if necessary.

1. Clean the coupling (→ Fig. 8, pos. 2) and the pipe end (pos. 1) or, for the 45° version, the end of the 90 mm pipe with a cloth (pos. 4) and cleaner until they are free from grease and dirt. Then dry them completely.
2. Apply PVC adhesive (pos. 6) to the inside of the coupling (pos. 7).
3. Apply a thick layer of PVC adhesive to the outside of the pipe end (pos. 5) or, for the 45° version, the end of the 90 mm pipe.
4. Joining:
 - Join the pipe and coupling without turning.
 - Briefly hold pipe and coupling in the desired position and allow the adhesive to set.
 - Wipe off excess adhesive.
5. Allow 12 h for the adhesive to dry.

Mounting the knee (45° version only)

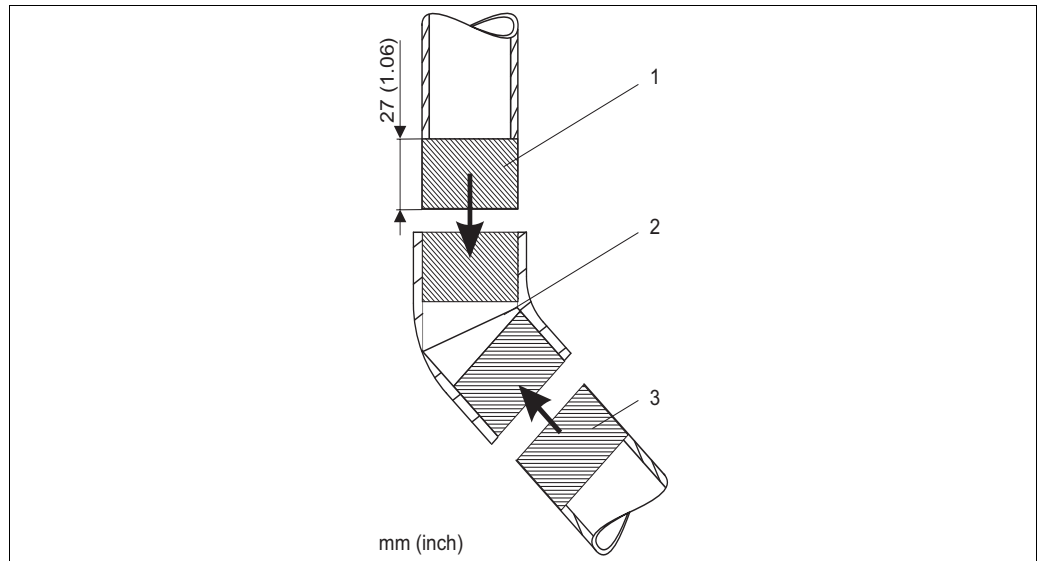



Fig. 9: Mounting the 45° knee

- 1 Pipe
- 2 Knee
- 3 90 mm pipe

1. Clean the free end of the 90 mm pipe (→ , pos. 3), the pipe end (pos. 1) and both ends of the knee (pos. 2) with a cloth and cleaner until they are free from grease and dirt. Then dry all parts completely.
2. Apply PVC adhesive to the inside of one knee end (pos. 2).
3. Apply a thick layer of adhesive to the outside of the free end of the 90 mm pipe (pos. 3).
4. Join the 90 mm pipe and the knee without turning.
Briefly hold them in the desired position to allow the adhesive to set.
Wipe off excess adhesive.
5. Apply PVC adhesive to the inside of the other knee end.
6. Apply a thick layer of adhesive to the outside of the longer pipe (pos. 1).
7. Join the longer pipe and the knee without turning.
Briefly hold them in the desired position to allow the adhesive to set.
Wipe off excess adhesive.
8. Allow 12 h for the adhesive to dry.

3.3.3 Wall mounting

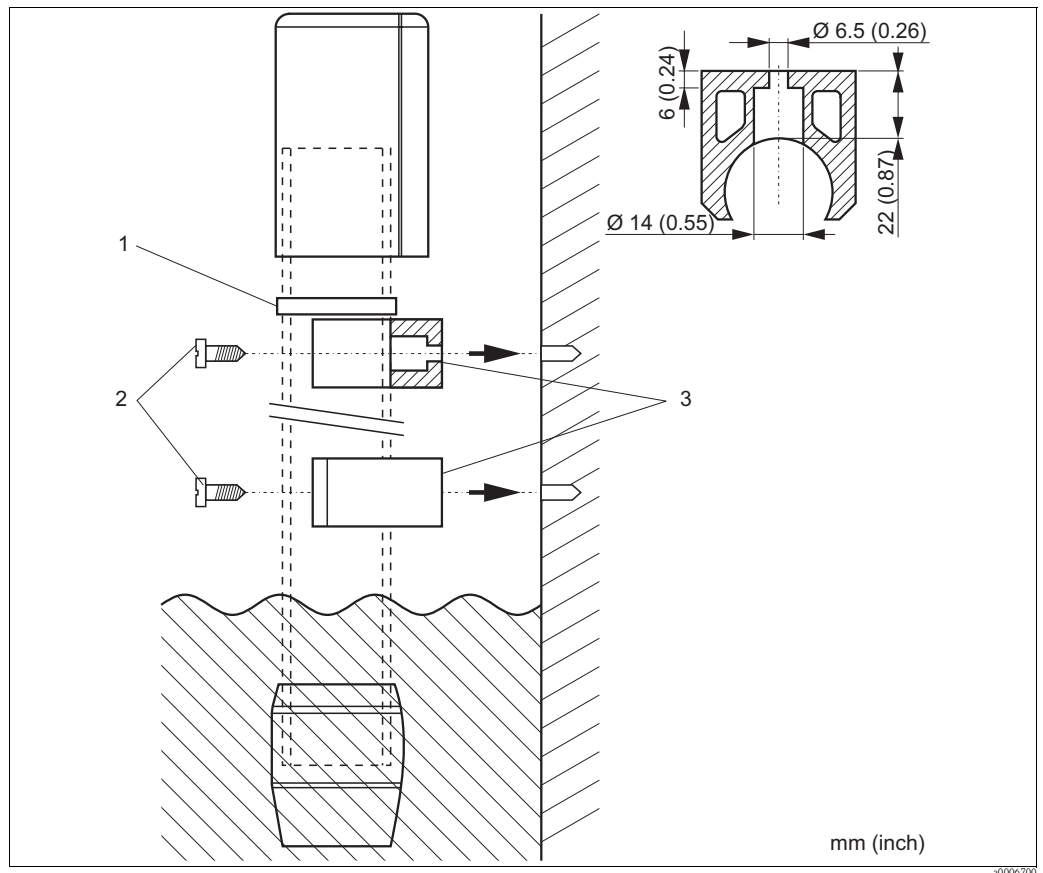



Fig. 10: Wall mounting

- 1 Worm drive hose clip
- 2 Screws, 6 mm
- 3 Pipe clamps

1. Secure the pipe clamps (→  10, pos. 3) with screws $\text{Ø } 6$ mm (0,24") (pos. 2) at the wall.
2. Clamp the assembly into the pipe clamps.



Caution!

If you are using the 45° version:

Clamp in the assembly in such a way that the knee points away from the wall.

3. Screw on the worm drive hose clip (pos. 1) directly above the upper pipe clamp to prevent the assembly from sliding down.

3.3.4 Mounting with suspension bracket

Required accessory:

Mounting set for CYA611 (order no. 50085874)

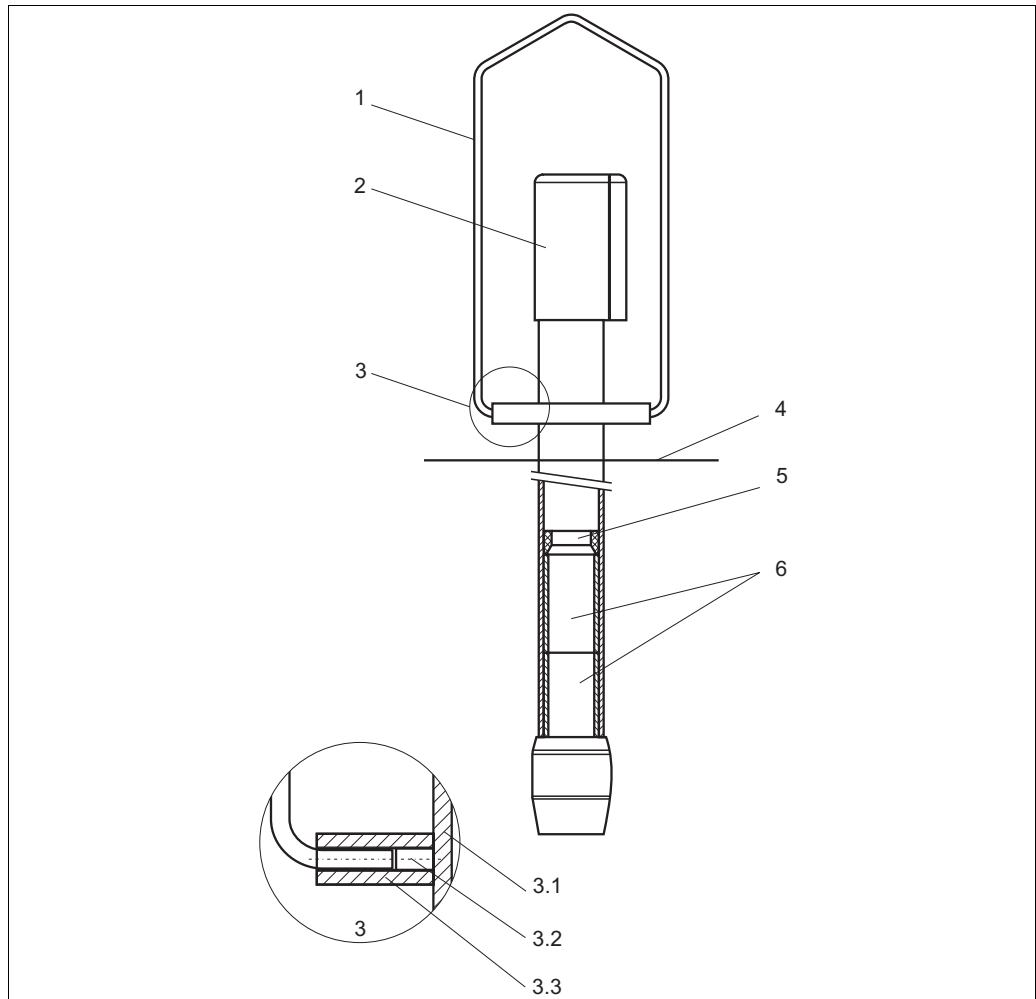



Fig. 11: Mounting with suspension bracket

1	Suspension bracket	3.3	Supporting ring
2	Protection cap	4	Water surface
3	Detailed view of supporting ring	5	Fixing ring
3.1	Pipe wall	6	Weights (2 pipes)
3.2	Thread for grub screw M8 x 16		

To mount the assembly with the suspension bracket, proceed as follows:

1. Remove the protection cap (→  11, pos. 2) from the pipe.
2. Push the weights (pos. 6) into the internal pipe and fix them in position with the fixing ring (pos. 5).
3. Push the supporting ring (pos. 3.3) onto the pipe and fix it using the grub screws M8 x 16 (pos. 3.2, thread for grub screws).
4. Hook in the suspension bracket (pos. 1).

3.3.5 Mounting via pendulum frame

Required accessories:

- Mounting set for CYA611 (order no. 50085874)
- Pendulum frame (order no. 50080196)

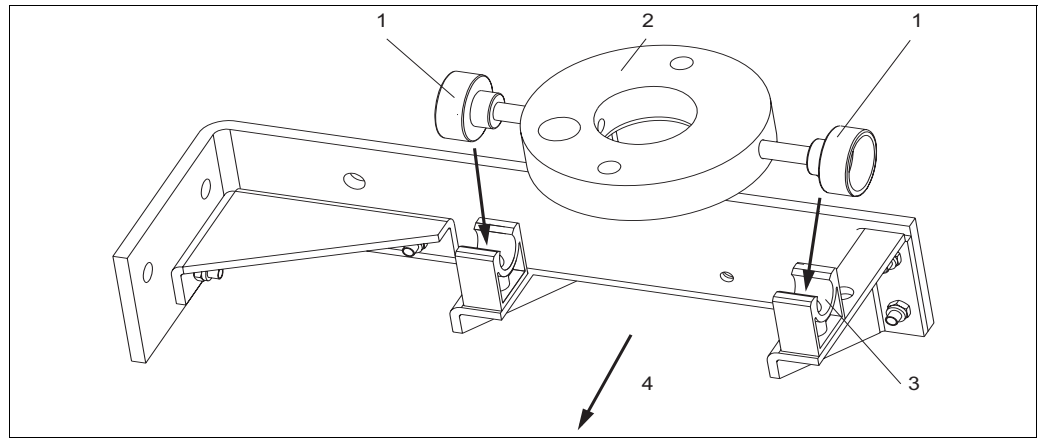

Fig. 12: Mounting via pendulum frame

- 1 Knurled banjo bolts
- 2 Supporting ring
- 3 Pillow blocks
- 4 Flow direction

1. Assemble the pendulum frame and secure it to the basin rim (the angle brackets point in the flow direction (pos. 4)).
2. Attach the supporting ring and the weights to the CYA611 (see preceding chapter). The suspension bracket is not used.
3. Screw the knurled banjo bolts (pos. 1) into the supporting ring (pos. 2) down to the stop.
4. Engage the assembly into the pillow blocks (pos. 3).
5. Check if the assembly is freely moving.

3.3.6 Sensor installation

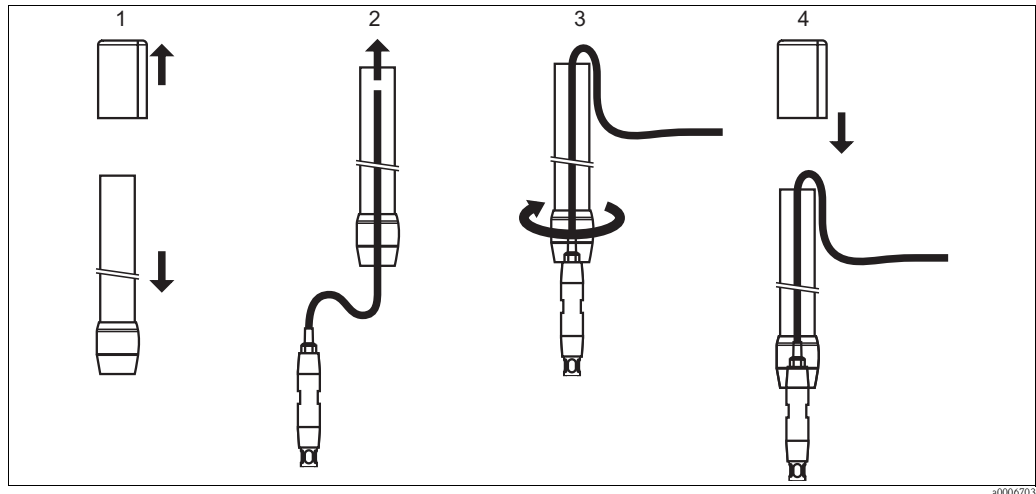

Fig. 13: Sensor installation

1. Remove the protection cap from the pipe.
2. Guide the sensor cable from the bottom through the assembly.
3. Hold on to the sensor and screw the assembly hand-tight onto the sensor. This prevents the cable from being twisted and avoids possible cable ruptures.
4. Replace the protection cap on the pipe end.



Note!

For improved sealing and easy dismounting, we recommend winding the thread with thin PTFE tape when using the assembly with NPT 3/4" thread.

3.4 Post-installation check

- After installation, check that all connections are firmly in position and leak-tight.
- When mounting the assembly via pendulum frame, check if the assembly is moving freely.

4 Maintenance

4.1 Cleaning

To ensure a reliable measurement, the assembly and the sensor must be cleaned at regular intervals. The frequency and intensity of the cleaning operation depend on the process medium.

4.1.1 Manual sensor cleaning

You have to clean the sensor:

- before every calibration
- regularly during operation
- before being returned for repair



Note!

- Do not use abrasive cleaning agents. This can lead to irreparable damage to the sensor.
- If necessary, recalibrate the sensor after cleaning.

Cleaning agents for manual sensor cleaning

The selection of the cleaning agent is dependent on the degree and type of contamination. The most common contaminations and the suitable cleaning agents are listed in the following table.

Type of contamination	Cleaning agent
Greases and oils	Substances containing tensides (alkaline) or water-soluble organic solvents (e.g. Ethanol)
Calciferous deposits, metal hydroxide deposits, lyophobic biological deposits	approx. 3% hydrochloric acid
Sulphide deposits	Mixture of 3% hydrochloric acid and thiocarbamide (commercially available)
Protein deposits	Mixture of 3% hydrochloric acid and pepsin (commercially available)
Fibres, suspended substances	Water under pressure, poss. with surface-active agents
Light biological deposits	Water under pressure



Caution!

Do not use organic solvents containing halogen or acetone. These solvents could destroy plastic components on the assembly or the sensor and it is also partly suspected that they cause cancer (e.g. Chloroform).

4.1.2 Cleaning during operation with spray cleaning kit

The spray cleaning kit is available as an accessory for the straight version of CYA611.

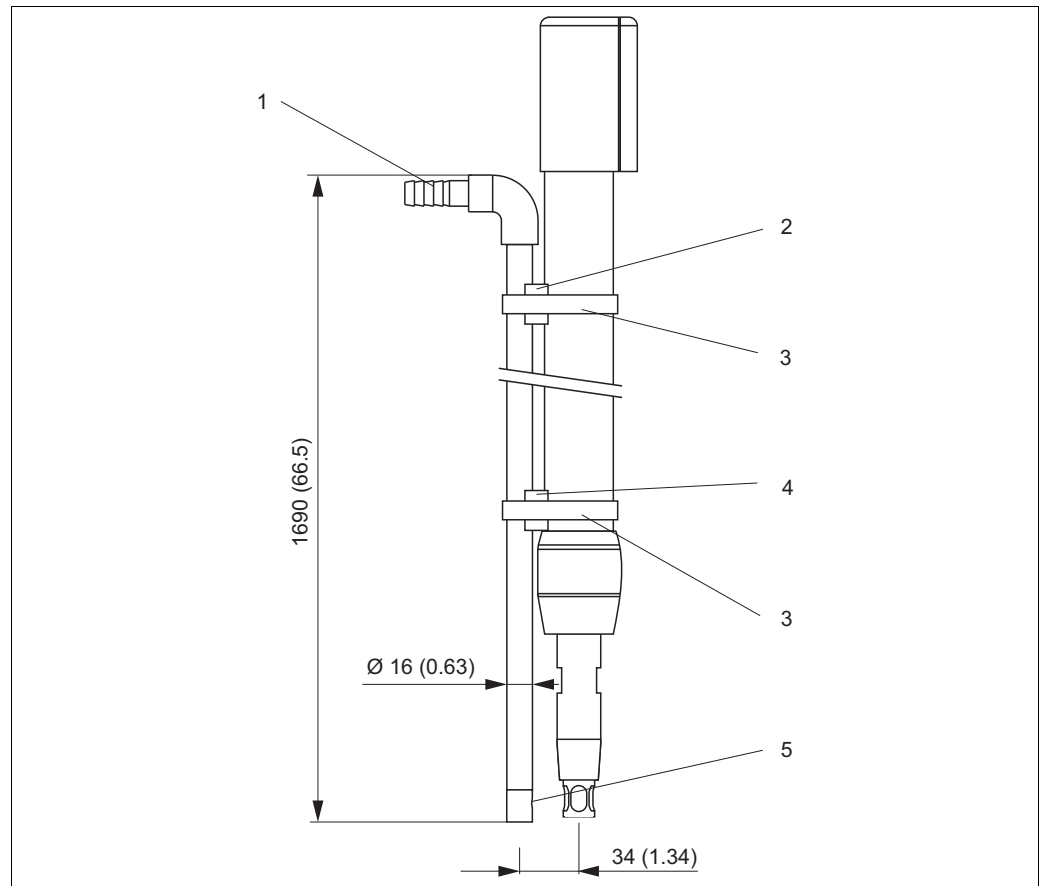

Fig. 14: Spray cleaning system

- | | | | |
|---|------------------------------|---|-----------------|
| 1 | Pressure hose connector D 16 | 4 | Spacer |
| 2 | Spacer | 5 | Spraying nozzle |
| 3 | Worm drive hose clips | | |



Caution!

- The maximum permissible cleaner pressure is 6 bar at 20 °C (87 psi at 68 °F).
- The permissible ambient temperature is 0 to 60 °C (32 to 140 °F).

To clean the sensor using the spray cleaning set proceed as follow:

1. Secure the pipe of the spray cleaning kit to the CYA611 using the worm drive hose clips (→ Fig. 14, pos. 3) and the spacers (pos. 2, 4).



Caution!

The lower spacer (pos. 4) must be fixed as closely to the threaded coupling as possible to achieve maximum stability.

2. Align the spraying nozzle (pos. 5) to the sensor head:
 - Adjust the nozzle to the sensor length:
 - CPF81: 140 mm (5.51")
 - COSxx: 175 mm (6.89")
 - CUSxx: 200 mm (7.87")
 - Adjust the spray direction.
3. Fasten the worm drive hose clips.
4. Connect the cleaner hose to the pressure hose connector D 16 (pos. 1).
5. Check the spray cleaning kit with water.

Cleaning agents for spray cleaning

Sensors	Cleaning agents
pH, ORP sensors	Pressurized water
COS31, COS41, COS61 oxygen sensors	Pressurized water
CUS31, CUS41 turbidity sensors	Pressurized water Compressed air

**Caution!**

Please note that the measured value will change during cleaning.

5 Accessories

5.1 Mounting

- Mounting set for CYA611
 - for mounting with suspension bracket and pendulum frame
 - with 2 weights of 0.35 kg (0.77 lbs) each
 - Material:
 - Suspension bracket: stainless steel 1.4571 (AISI 316Ti)
 - Weights: stainless steel 1.4301 (AISI 304)
 - Order no. 50085874
- Pendulum frame
 - for pendulous suspension of CPA111, CLA111, CPA510 and CYA611 assemblies
 - Order no. 50080196
- Immersion assembly holder CYH101
 - for pH, ORP, oxygen, conductivity assemblies and for oxygen and turbidity sensors;
 - Ordering acc. to product structure (Technical Information TI092C/07/en)

5.2 Cleaning

- Spray cleaning kit
 - for installation (or retrofitting) on straight version of CYA611
 - for cleaning of all sensors used with CYA611
 - Material:
 - Pipe: PVC-U
 - Spacers: PA
 - Worm drive hose clips: stainless steel 1.4401 (AISI 316)
 - Order no. 50086336
- Chemoclean
 - Injector CYR 10 and programme sequencer CYR 20
 - Ordering acc. to product structure, see Technical Information (TI046C/07/en)

5.3 Sensors

5.3.1 Oxygen sensors

- Oxymax W COS31
 - Oxygen sensor for drinking water and wastewater measurements, potentiostatic amperometric principle
 - Material: stainless steel 1.4571 (AISI 316 Ti)
 - Ordering acc. to product structure, see Technical Information (TI285C/07/en)
- Oxymax W COS41
 - Oxygen sensor for drinking water and wastewater measurements, amperometric principle
 - Material: POM
 - Ordering acc. to product structure, see Technical Information (TI284C/07/en)
- Oxymax W COS61
 - Optical oxygen sensor for drinking water and wastewater measurements, fluorescence quenching principle
 - Material: stainless steel 1.4571 (AISI 316 Ti)
 - Ordering acc. to product structure, see Technical Information (TI387C/07/en)

5.3.2 Turbidity sensors

- Turbimax W CUS31
 - Turbidity sensor for drinking water and wastewater applications, 90 ° scattered light method
 - Ordering acc. to product structure, see Technical Information (TI176C/07/en)
- Turbimax W CUS41
 - Turbidity sensor for wastewater and solid content measurements, 90 ° scattered light method
 - Ordering acc. to product structure, see Technical Information (TI177C/07/en)

5.3.3 pH/ORP sensors

- Orbipac CPF81/82
 - Compact pH/ORP sensor for installation or immersion operation in process water and wastewater
 - Ordering acc. to product structure, see Technical Information (TI191C/07/en)
- 120 mm pH/ORP sensor in combination with Ecofit CPA640 adapter
 - Ordering of sensors acc. to product structures, see corresponding Technical Information
 - Ordering of Ecofit CPA640 adapter acc. to product structure, see Technical Information

5.4 Measuring cables

CPK9 special measuring cable

- For pH/ORP sensors with TOP68 plug-in head, for high-temperature and high-pressure applications, IP 68
- Ordering acc. to product structure, see Technical Information (TI118C/07/en)

CYK71 measuring cable

- non-terminated cable for the connection of pH sensors and COS41 oxygen sensor or the extension of sensor cables
- Sold by the meter, order number:
 - non-Ex version, black: 50085333
 - Ex version, blue: 51506616

COK31 special measuring cable

- for sensors COS31, COS61 and COS71 with TOP68 plug-in head
- Order numbers:
 - Cable length 1.5 m (4.92 ft): 51506820
 - Cable length 7 m (22.97 ft): 51506821
 - Cable length 15 m (49.22 ft): 51506822

COK41 special measuring cable

- for COS41 oxygen sensors with TOP68 plug-in head
- Order numbers:
 - Cable length 7 m (22.97 ft): 51506817
 - Cable length 15 m (49.22 ft): 51506818

OMK measuring cable

- non-terminated measuring cable for oxygen sensors COS31, COS61 and COS71, for extension between junction box VS and transmitter
- Sold by the meter, order no. 50004124

CMK measuring cable

- non-terminated measuring cable for oxygen sensor COS41, for extension between junction box VBM and transmitter
- Sold by the meter, order no. 50005374

CYK81 measuring cable

- non-terminated measuring cable for extension of sensor cables of e.g. Memosens, CUS31/CUS41
- 2 wires, twisted pair with shield and PVC-sheath (2 x 2 x 0.5 mm² + shield)
- Sold by the meter, order no. 51502543

Junction box VBA

- For cable extension of pH/ORP sensors, with 10 high-impedance terminals, protection class: IP 65 (≅ NEMA 4X)
- Material: polycarbonate
- Order no. 50005276

VS junction box

- With plug-in socket and 7-pole plug
- For cable extension from sensor (COS71, COS61, COS31, COS3 with SXP connector) to transmitter, IP 65;
- Order no. 50001054

Junction box VBM

- for cable extension for sensors COS41, COS4 (fixed cable versions)
- with 10 terminals, IP 65 / NEMA 4X
- Order numbers:
 - Cable entry Pg 13.5: 50003987
 - Cable entry NPT 1/2": 51500177

Junction box RM

- To lengthen the cable for Memosens or CUS31/CUS41
- With 2 x PG 13.5
- IP 65 (≅ NEMA 4X)
- Order no. 51500832

6 Technical data

6.1 Environment

Ambient temperature	0 to 60 °C (32 to 140 °F)
----------------------------	---------------------------

6.2 Process

Process pressure	unpressurized
-------------------------	---------------

6.3 Mechanical construction

Design, dimensions	see chapter "Installation"	
Weight	approx. 1 kg (2.2 lbs)	
Materials	Immersion pipe: Protection cap: Wall mount: Worm drive hose clip:	Polyvinyl chloride (PVC-U) Polyamide (PA) Polyethylene (PE) Stainless steel 1.4401 (AISI 316)
Connecting thread	Version A: G 1 Version B: NPT ¾" Version C: G ¾ Version D: NPT ½" Version E: G1, 45°	

Index

A

Accessories	20
Assembly holder CYH101	20
Cables	21
CXR10	20
Junction boxes	21
Mounting set	20
Pendulum frame	20
Sensors	20–21
Spray cleaning kit	20
Assembly	
Cleaning	17
Assembly holder CYH101	20

C

Cables	21
Check	
Installation	16
Cleaning	
Assembly	17
Cleaning agents	17
Sensors	17
Spray cleaning kit	18
Commissioning	4
CXR10	20

D

Designated use	4
Dimensions	7

E

Environment	23
-------------------	----

I

Incoming acceptance	7
Installation	4, 7, 10
Check	16
Sensors	16
via pendulum frame	15
Wall mounting	13
with suspension bracket	14
Installation conditions	7

J

Junction boxes	21
----------------------	----

M

Maintenance	17
Measuring system	10
Mechanical construction	23
Mounting	7
Mounting set	20

N

Nameplate	6
-----------------	---

O

Operation	4
Operational safety	4
Order	6

P

Pendulum frame	15, 20
Process	23
Product structure	6

R

Return	4
--------------	---

S

Safety icons	5
Scope of delivery	6
Sensors	21
Cleaning	17
Installation	16
Spray cleaning kit	18, 20
Storage	7
Suspension bracket	14
Symbols	5

T

Technical data	23
Environment	23
Mechanical construction	23
Process	23
Transport	7

U

Use	4
-----------	---

W

Wall mounting	13
---------------------	----

Declaration of Hazardous Material and De-Contamination Erklärung zur Kontamination und Reinigung

RA No.

Please reference the Return Authorization Number (RA#), obtained from Endress+Hauser, on all paperwork and mark the RA# clearly on the outside of the box. If this procedure is not followed, it may result in the refusal of the package at our facility.
Bitte geben Sie die von E+H mitgeteilte Rücklieferungsnummer (RA#) auf allen Lieferpapieren an und vermerken Sie diese auch außen auf der Verpackung. Nichtbeachtung dieser Anweisung führt zur Ablehnung Ihrer Lieferung.

Because of legal regulations and for the safety of our employees and operating equipment, we need the "Declaration of Hazardous Material and De-Contamination", with your signature, before your order can be handled. Please make absolutely sure to attach it to the outside of the packaging.

Aufgrund der gesetzlichen Vorschriften und zum Schutz unserer Mitarbeiter und Betriebseinrichtungen, benötigen wir die unterschriebene "Erklärung zur Kontamination und Reinigung", bevor Ihr Auftrag bearbeitet werden kann. Bringen Sie diese unbedingt außen an der Verpackung an.

Type of instrument / sensor
Geräte-/Sensortyp _____

Serial number
Seriennummer _____

Used as SIL device in a Safety Instrumented System / Einsatz als SIL Gerät in Schutzanlagen

Process data / Prozessdaten
Temperature / Temperatur _____ [°F] _____ [°C] Pressure / Druck _____ [psi] _____ [Pa]
Conductivity / Leitfähigkeit _____ [µS/cm] Viscosity / Viskosität _____ [cp] _____ [mm²/s]

Medium and warnings
Warnhinweise zum Medium



	Medium / concentration Medium / Konzentration	Identification CAS No.	flammable entzündlich	toxic giftig	corrosive ätzend	harmful/ irritant gesundheitsschädlich/ reizend	other * sonstiges *	harmless unbedenklich
Process medium Medium im Prozess								
Medium for process cleaning Medium zur Prozessreinigung								
Returned part cleaned with Medium zur Endreinigung								

* explosive; oxidising; dangerous for the environment; biological risk; radioactive

* explosiv; brandfördernd; umweltgefährlich; biogefährlich; radioaktiv

Please tick should one of the above be applicable, include safety data sheet and, if necessary, special handling instructions.

Zutreffendes ankreuzen; trifft einer der Warnhinweise zu, Sicherheitsdatenblatt und ggf. spezielle Handhabungsvorschriften beilegen.

Description of failure / Fehlerbeschreibung _____

Company data / Angaben zum Absender

Company / Firma _____	Phone number of contact person / Telefon-Nr. Ansprechpartner: _____
Address / Adresse _____	Fax / E-Mail _____
_____	Your order No. / Ihre Auftragsnr. _____

"We hereby certify that this declaration is filled out truthfully and completely to the best of our knowledge. We further certify that the returned parts have been carefully cleaned. To the best of our knowledge they are free of any residues in dangerous quantities."

"Wir bestätigen, die vorliegende Erklärung nach unserem besten Wissen wahrheitsgetreu und vollständig ausgefüllt zu haben. Wir bestätigen weiter, dass die zurückgesandten Teile sorgfältig gereinigt wurden und nach unserem besten Wissen frei von Rückständen in gefahrbringender Menge sind."

(place, date / Ort, Datum)

Name, dept./Abt. (please print / bitte Druckschrift)

Signature / Unterschrift

www.endress.com/worldwide

Endress+Hauser 
People for Process Automation

